

CHURCH ROAD GENERAL ARRANGEMENTS - FROM SOUTH TO NORTH (VIEW 1 OF 8)

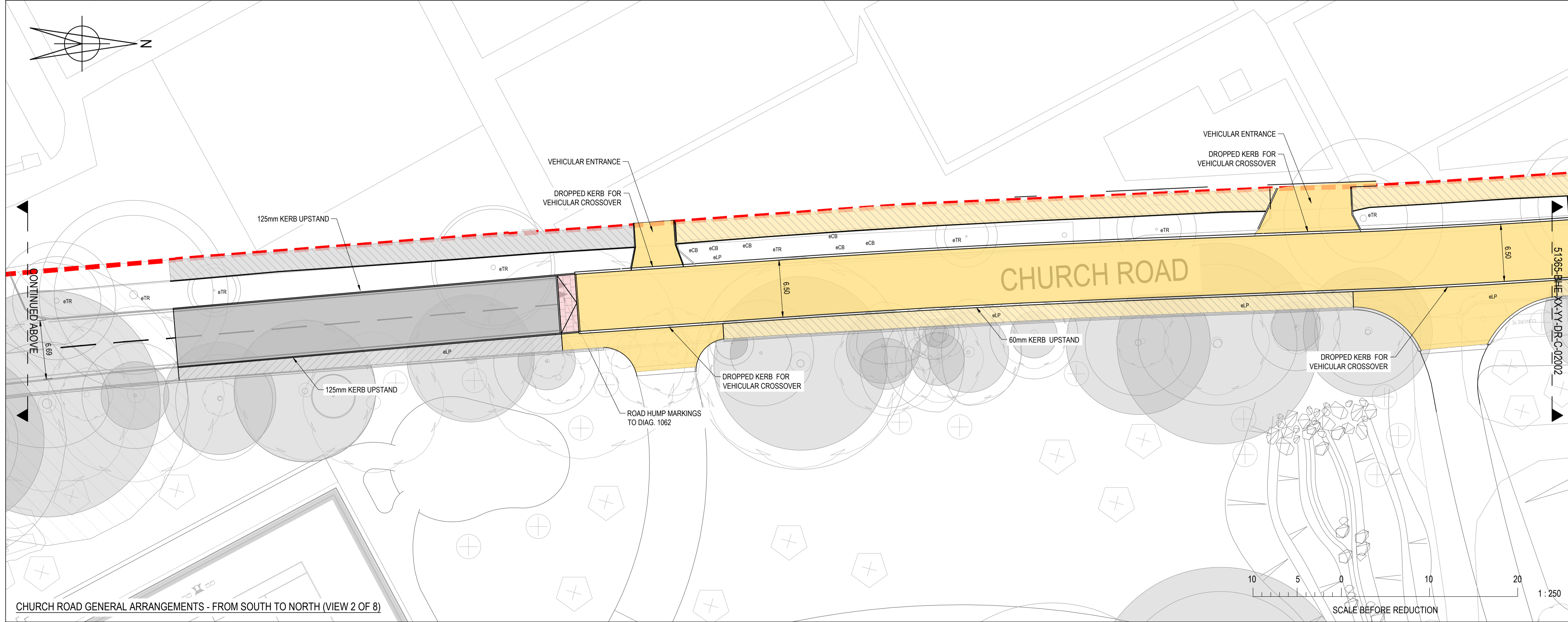

CHURCH ROAD GENERAL ARRANGEMENTS - FROM SOUTH TO NORTH (VIEW 2 OF 8)

© Buro Happold Limited or its group companies.
 All Rights reserved. Buro Happold and its group companies assert (unless otherwise agreed in writing) their rights under s.17 of the Copyright, Designs and Patents Act 1988.
 DO NOT SCALE THIS DRAWING.
HEALTH AND SAFETY INFORMATION
 IN ADDITION TO THE HAZARD/RISKS NORMALLY ASSOCIATED WITH THE TYPES OF WORK DETAILED ON THIS DRAWING, NOTE THE FOLLOWING:
 CONSTRUCTION
 MAINTENANCE/CLEANING/OPERATION
 DECOMMISSIONING/DEMOLITION

- Notes
- EXISTING KERBLINE TAKEN FROM MK SURVEY '28771', RECEIVED 24.08.2020.
 - 125mm KERB UPSTAND FOR STANDARD CARRIAGEWAY AREAS
 - 60mm KERB UPSTAND FOR RAISED TABLE AREAS.
 - DROPPED KERB (FLUSH) FOR VEHICULAR CROSSOVERS, TRANSITION KERBS AT EITHER END OF THE CROSSOVER.
 - KERBLINE ADJUSTMENTS ARE IN ORDER TO IMPROVE EASTERN FOOTWAY WIDTH TO 2m.
 - KERBLINE ADJUSTMENTS, CONSTRAINED BY THE TREES, TYPICALLY MAINTAIN EXISTING ROAD WIDTHS, RANGING 6.5 - 7m.
 - THERE ARE 38 EXISTING LIGHTING COLUMNS BETWEEN CH. 200 AND CH. 1100. THESE WILL BE REASSESSED AS PART OF S278 WORKS AND NEW LIGHTING COLUMNS PROPOSED.
 - EXISTING KERBS TO BE RE-USED WHERE APPROPRIATE.
 - ALL MATERIALS ARE INDICATIVE ONLY AND TO BE AGREED WITH THE PLANNING AND HIGHWAYS AUTHORITY.

LEGEND

EXISTING	---	EXISTING KERB LINE
PROPOSED	- - - - -	SITE BOUNDARY
	- - - - -	PROPOSED KERB LINE
	[Grey Box]	NEW ASPHALT CARRIAGEWAY
	[Yellow Box]	COLOURED ASPHALT CARRIAGEWAY
	[Red Box]	NEW PORPHYRY SETT CARRIAGEWAY PAVEMENT
	[Pink Box]	NEW GRANITE SETT PAVEMENT FOR VEHICLE CROSSOVER
	[Grey Box]	NEW ASPHALT FOOTWAY PAVEMENT
	[Yellow Box]	NEW COLOURED ASPHALT FOOTWAY PAVEMENT
	[Cross-hatched Box]	NEW HIGH QUALITY PORPHYRY OR SIMILAR FOOTWAY
	[Grid Box]	400x400x50mm GRANITE BUFF BLISTER TACTILE PAVING
	[Circle]	RETRACTABLE BOLLARDS

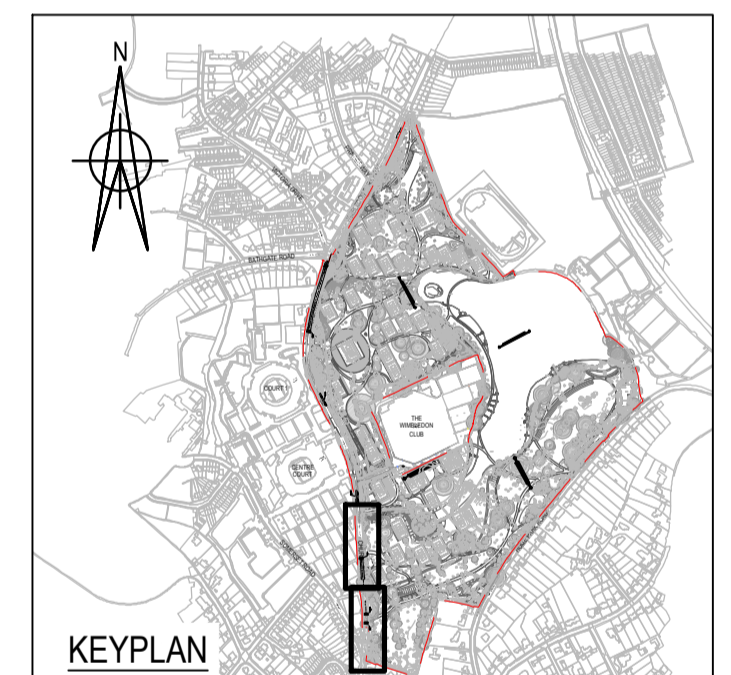

P05 GLA PLANNING ADDENDUM	29.04.24	DJ	MJ	
P04 ISSUED FOR PLANNING	23.06.21	MM	JE	
Rev	Description	Date	Drn	Cr'd

S2 - INFORMATION

Status of drawing

BURO HAPPOLD

17 Newman Street
 London
 W1T 1PD
 UK

Tel: +44 (0)20 7927 9700
 Fax: +44 (0)870 787 4145
 Email: 0044023@burohappold.com
 Web: www.burohappold.com

Architect: ALLIES AND MORRISON
 Project: AELTC WIMBLEDON PARK PROJECT
 Dig Title: CHURCH RD GENERAL ARRANGEMENT SHEET 1 OF 4

Scale@A1: 1:250
 Drawn by: M.MARIANO
 Checked by: R.LEBON

Job No: 0044623
 Date: JUNE 21
 Rev: P05

Drawing No: 51365-BHE-XX-YY-DR-C-02001