

Notes
 Do not scale from this drawing.
 All dimensions are drawn in millimetres.
 Drawing & design copyright LUC.
 Reproduction of this drawing in whole or in part is prohibited without prior permission.

- Key**
- Application boundary
 - Existing trees and RPA
 - Trees to be removed
Refer to accompanying removals schedule for further details
 - Trees to be transplanted
Refer to accompanying removals schedule for further details
 - Existing planting
 - Veteran Tree Buffer Zone
A larger root protection area is afforded to veteran trees (1.0 x radius of 12 x the diameter of the trunk)
 - Ancient & Veteran Trees
Defined as Veteran trees that are also sufficiently old and large of girth to be described as 'ancient' (more than 500mm)
 - Veteran Trees
Trees exhibiting at least 4 'veteran features' (but not sufficiently old or of a sufficient girth to be 'ancient')

Note: This drawing is to be read in colour and a monochrome copy should not be relied on.

Notes:
 This drawing is to be read in conjunction with the Arboricultural Impact Assessment (incorporating the Tree Schedule and Tree Constraints Plan).

All surveyed 'Trees' have a stem diameter of more than 75 mm measured at 1.5 m above highest adjacent ground level (as per BS5837:2012 recommendations).

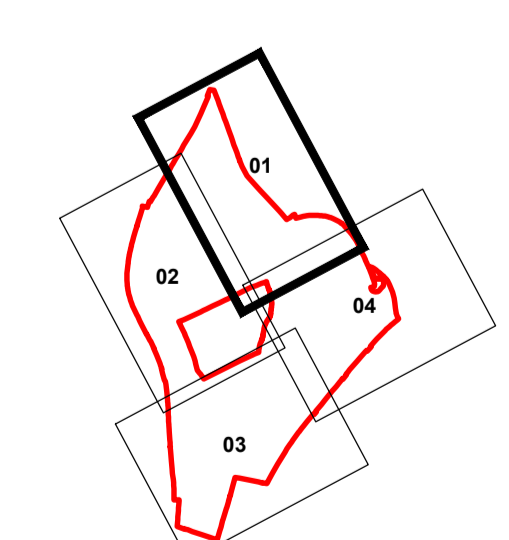
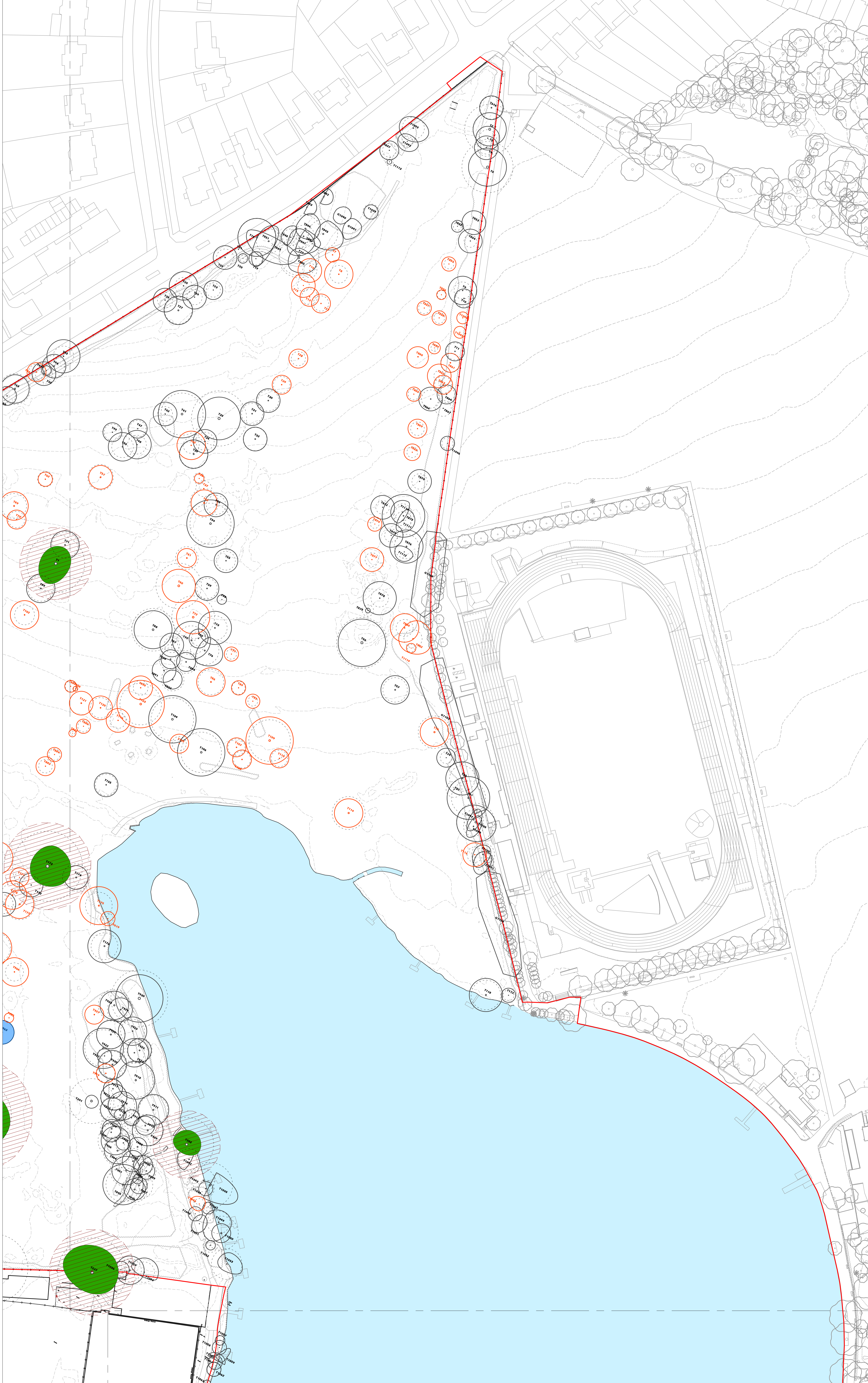

Rev	Date	Description	By	CHK
01	2024-01-15	Issue for Information	JW	
02	2024-01-15	Issue for Information	JW	

LUC LUC London
 250 Waterloo Road London, SE1 8PD
 +44 (0)20 7383 5784
 london@luc.co.uk
 www.luc.co.uk

Project: **AELTC WIMBLEDON PARK PROJECT**
 Client: **ALL ENGLAND LAWN TENNIS CLUB**
 Scale @A0: **1:500** Status: **S2 - INFORMATION**
 Drawing Title: **TREE REMOVALS**
 SHEET 1
 Job No: **51365-LUC-XX-DR-L-02121** Issue: **P03**