

New Public Square

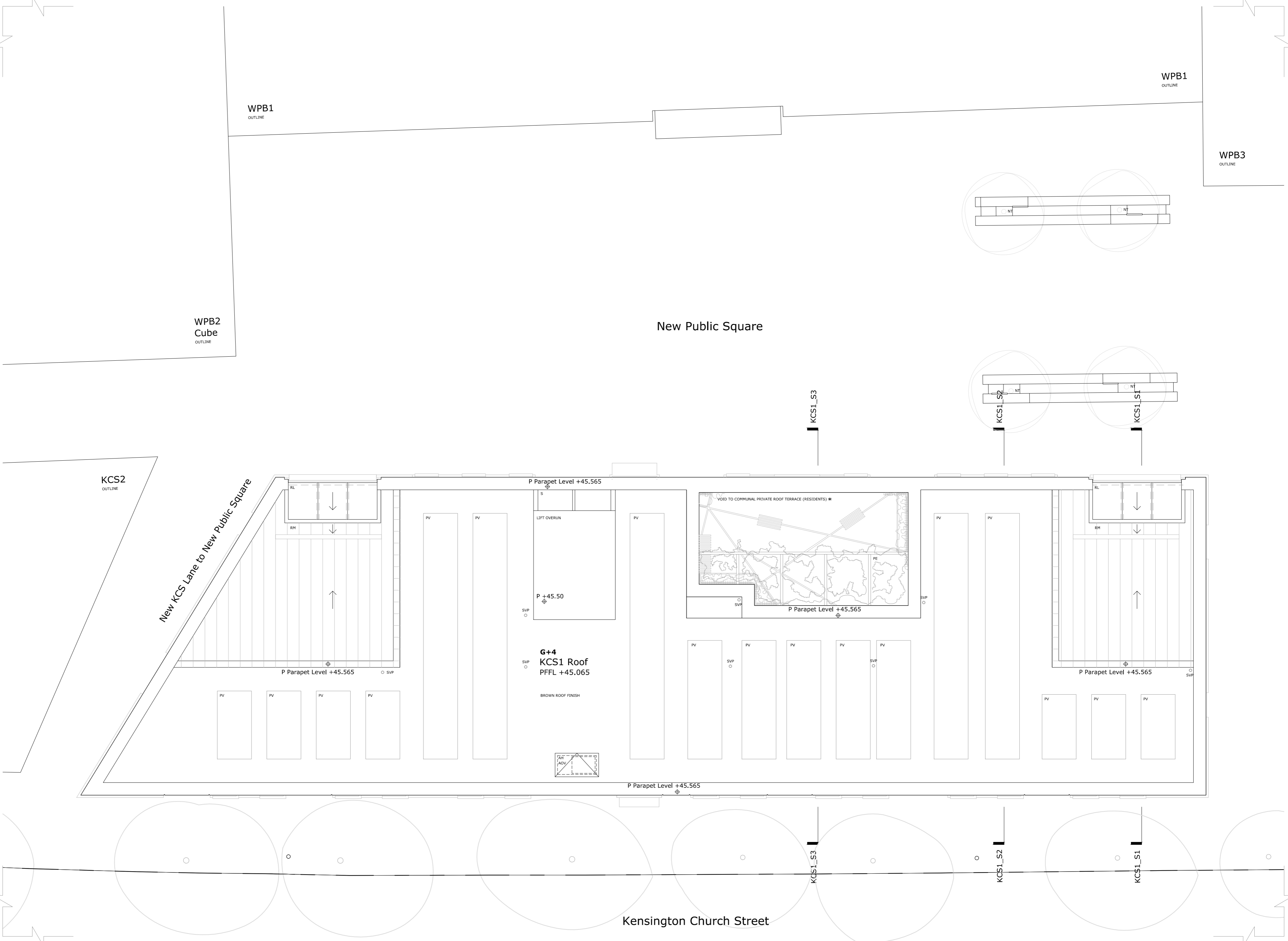

Proposed KCS1 Roof

1:100

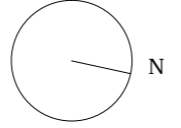
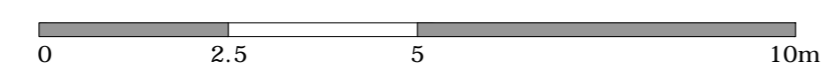

Kensington Church Street

Proposed KCS1 4th Floor

1:100

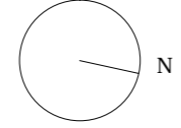

Building & Site References:

CB	Corner Building : Central Form & East Form
NHG	Notting Hill Gate Building
KCS1	Kensington Church Street Building 1
KCS2	Kensington Church Street Building 2
WPB1	West Perimeter Building 1
WPB2	West Perimeter Building 2 - Cube
WPB3	West Perimeter Building 3
New Public Square	New Public Square - New Publicly Accessible Open Space

Key:

AH	Access Hatch	D	Dining	K	Kitchen	P	Proposed Level
AOV	Automatic Openable Vent	DAC	Dry Air Cooler Services	KCS1.A1-4	Residential (Affordable) Apartments	PE	Pergola
AR	Acoustic Wall to Roof	E	Existing Level	KCS1.A5-15	Residential (Affordable) Apartments	PF	Proposed Finish Floor Level
AT	Accessible Toilet	EE	Emergency Exit	KCS2.A1-15	Residential (Affordable) Apartments	PR	Pitched Roof with Services
BI-3	Bedroom 1-3	EO	Entrance Office	KE	Kitchen Extract	PV	Photovoltaics
BA	Balcony	EO-S	Entrance Office Service	L	Living	REF	Refuge Zone
BP	Bicycle Parking	ER	Entrance Residential	LD	Louvered Door	REF	Refuge Area
B	Bathroom	ERT-S	Entrance Retail Service	LL	Lower Level	REF	Refuge Zone
BR	Bathroom	ERT	Entrance Retail	LR	Metal Louvered Roof (indicative)	RF.O	Refuse - Office
C	Canopy at 1st floor	ES	Eis-suite	LWA	Louvered Wall	RF.R	Refuse - Residential
C.O	Cycle Storage - Office	ES/O	Entrance Flexible	LWI	Louvered Window	RF.RT	Refuse - Retail
C.R	Cycle Storage - Residential	ES/O-S	Entrance Flexible	MB	Master Bedroom	RF.S/O	Refuse - Flexible
C.RT	Cycle Storage - Retail	ES/O-S	Entrance Flexible	MER	Media Room	SVP	Service Void
C.SS/O	Cycle Storage - Flexible	EV	Entrance Vehicle Lift	MR	Meeting Room	T	Toilet
				NT	New Tree	TL*	Roof Light Openable

General Notes:

- Do not scale from drawings.
- All omissions and discrepancies to be reported to the architect immediately.
- This drawing is to be read in conjunction with all relevant Architectural drawings and documents, and consultants' information.
- All structural information is to structural consultant design and information.
- All services and fire strategy information is to service and fire consultants' design and information.
- All dimensions must be verified on the site.
- The contents of the drawing are Urban Sense Consultant Architects Ltd copyright and shall not be re-used without their written permission.
- Information on existing buildings on the site and its immediate context along its boundary is as per survey information by Sterling Survey Ltd.
- All heights given are AOD.
- Information on the wider site context is as per OS map in plan and Z mapping for massing/3D information.
- LUL station is as per LUL survey of installations - ref. URS overlay of LUL survey info with Sterling Survey info. Where survey information was unavailable from LUL, station is illustrated inductively based Arup modelling of historic archive info.
- 145 Kensington Church Street is illustrated as per approved planning drawings - inductive representation only.

UL	Upper Level	UL	Upper Level
V	Void	VEH1-2	Vehicle Lifts
WA	M4(3) Wheelchair accessible unit	WC	Toilet
WAC	M4(3) Wheelchair accessible unit	WG	Winter Garden
WRT	Water Retention Tank	WRT	Water Retention Tank
		*	Including Child Play Space

↗	Inward openable top tilt & turn window
↖	Inward openable top tilt window
↘	Direction of falls
↙	Apartment Entrance
⇄	Sliding Door

Note:

- Ground floor external textures shown are illustrative only and are not submitted for approval.
- Retail signage shown is illustrative only and is not submitted for approval.
- Internal layouts shown are illustrative only and are not submitted for approval.
- References to "Retail" mean use for any purpose falling within any one or more of Use Classes A1, A2 and A3.
- The label WA or WAC indicates only that the unit concerned could meet the requirements of Approved Document M. The applicant expects the local planning authority to require approval of a plan showing layouts and location of wheelchair accessible and adaptable units by way of condition.
- Material textures are illustrated to indicate area of material only and sizes are illustrated inductively and are not submitted for approval. The applicant expects the planning authority to require approval of external materials by way of condition.
- External materials (including landscape) are shown for illustrative purposes only and are not submitted for approval. The applicant expects the planning authority to require approval of external materials by way of condition.

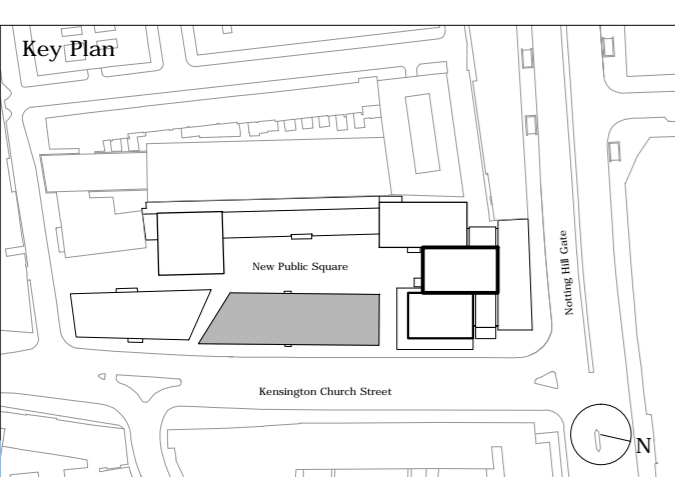

Key: Application Boundary

Rev.	Date	Details	Drawn/Checked
A	09.07.18	GLA call in amendments	AL/DL/VB

project/client	project no.	
NH&KCS	1059	
Notting Hill Gate KCS Ltd.		
dwg. no.	rev.	scale
P-KCS1-AA(0)-102	A	1/100@A1
date		
Proposed KCS1	06/09/17	
Fourth Floor		
& Roof		
issued for	drawn checked	
Planning	CE VB/DL	

urban sense
architecturo

Urban Sense Consultant Architects Ltd.
89 Wardour Street, 4th floor
London W1F 0UB t: 020 7438 9707
www.urbansense-architects.co.uk
©Urban Sense Consultant Architects Ltd.