

**General Notes**

1. Do not scale drawings. Dimensions govern.
2. All dimensions are in millimetres unless noted otherwise.
3. All levels are in metres unless noted otherwise.
4. All dimensions shall be verified on site before proceeding with the work.
5. Foster + Partners shall be notified in writing of any discrepancies.

**LEGEND**

— The details within this area are not for approval but will be the subject of reserved matters and detailed discussion with the Silvertoun Tunnel project team and TfL, to ensure compatibility with the delivery of the Silvertoun Tunnel under the 2018 DCO.

FOR PLANNING		
Rev.	Date	Reason For Issue
04	20/07/20	For Planning Resubmission
03	17/04/20	For Planning Resubmission
02	10/03/20	For Planning Resubmission
01	13/05/19	For Planning Resubmission
00	13/12/18	For Planning
		Rev.
		Reason For Issue
		CHK

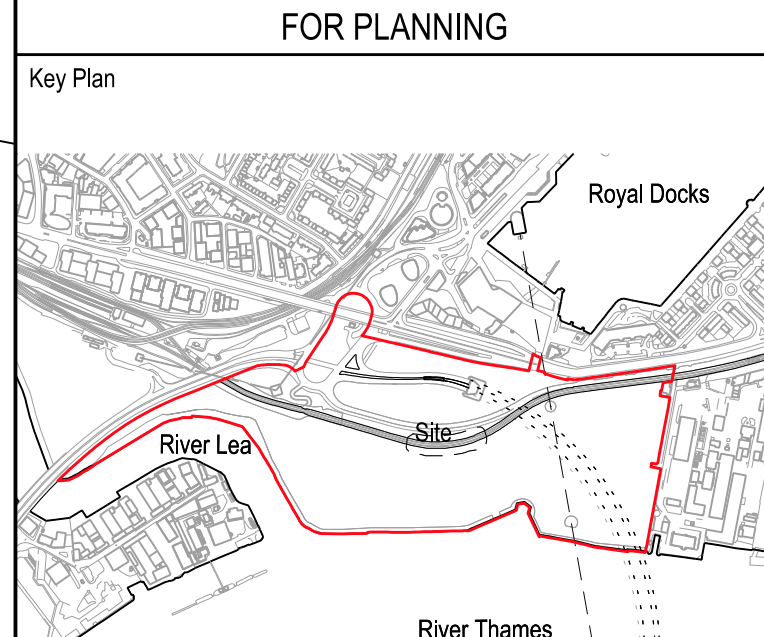

**LEGEND**

- Thameside West Planning Application Boundary
- Detailed Application
- Detailed and Outline Application
- Development Zone
- Development Zone Reference
- Indicative Masterplan Building Envelope
- Class A1 - A4 retail (including services)
- Class A1/A4 or C3: mixed use (retail and dwelling houses)
- Class B1c, B2 (restricted) and B8 business and industrial uses
- Class B1c, B2 and B9 business and industrial uses
- Class C3 dwelling houses
- Class D1 and D2 non-residential institutions
- Energy Centre

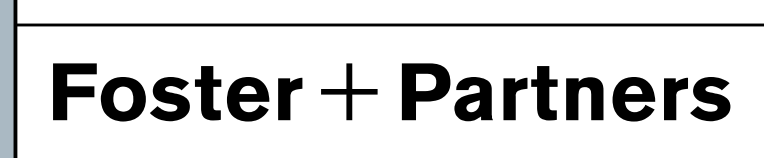

**Foster + Partners**

Riverside, 22 Hester Road  
 London SW11 4AN  
 T +44 (0)20 7738 0455  
 www.fosterpartners.com

**Client**  
 Silvertoun Homes Limited &  
 GLA Land and Property

**Project**  
 Thameside West  
 Masterplan

**Title**  
 Site Layout  
 Masterplan - Parameter Plan 09  
 Principle Uses at Entry Level

Project No.	Date	Scale at ISO A0
2693	13/12/18	1:1000
Number	Revision	
A-SL-011-xx-09	04	