

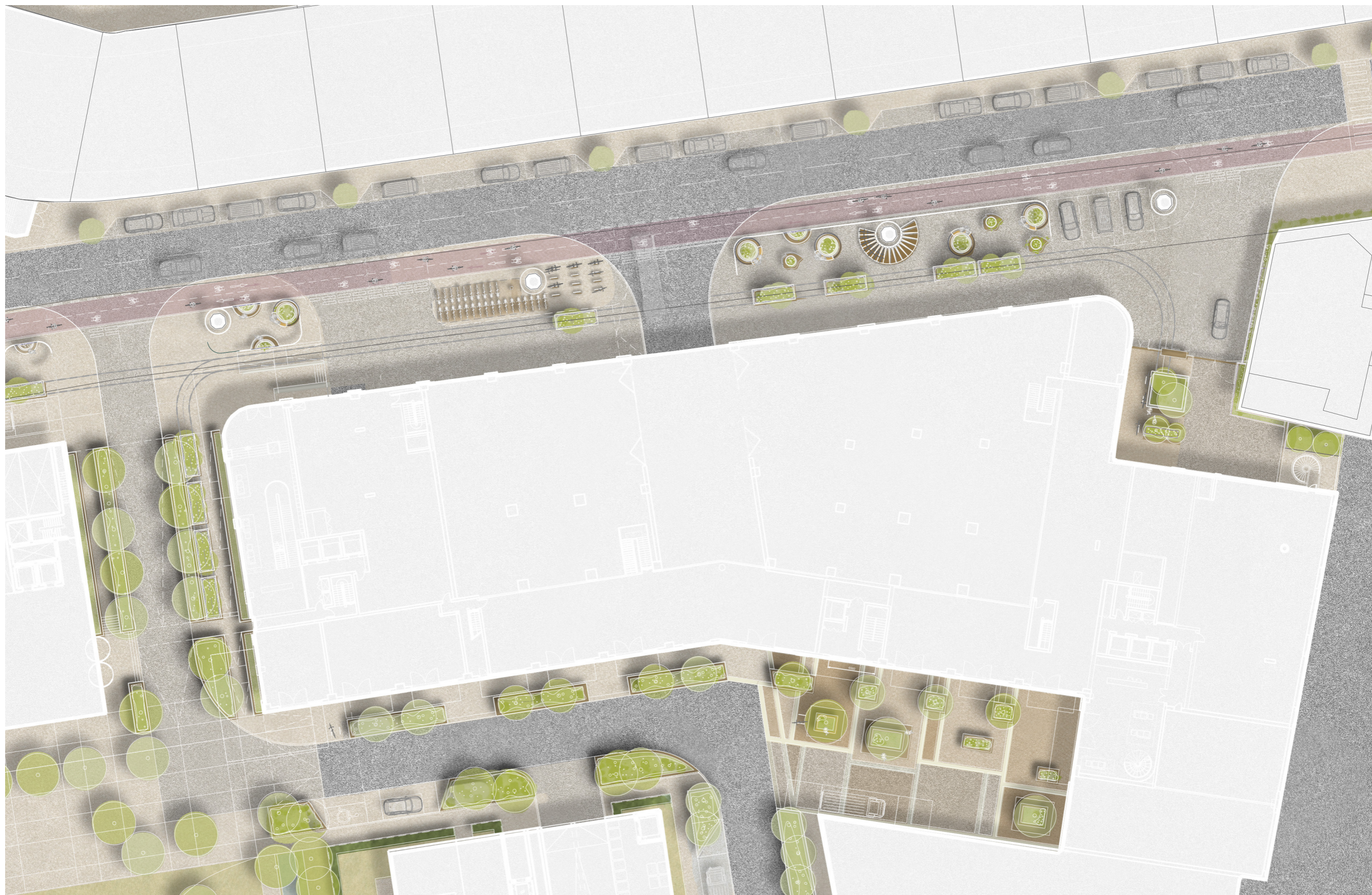

PHASE 1 MASTERPLAN LANDSCAPE
(With existing North Woolwich Road)



**UPDATED PHASE 1 MASTERPLAN LANDSCAPE
(With aspirational North Woolwich Road)**

4.4 North Woolwich Road

The area along the North Woolwich Road and under the DLR is the primary access to 'The Landings' and is an important street as it sets a first impression (especially in the short term condition) to the redevelopment of Thameside West. A new standard for industrial interaction with pedestrian, cycling and residential activity has become recently more obvious locally in Canning Town and across London.

The existing road is unwelcoming on either side, with unrestricted parking contributing to the vehicle priority.

By improving the quality of the landscape and public realm it is possible to allow industry and homes to live in a quality symbiotic environment.

North Woolwich Road landscaping

As the whole of North Woolwich Road is the subject of a design study with works to be carried out by the Borough and TfL.

Greening will be achieved through the use of repositionable 'giant plant pot' planters set on the pavement between the set back parking bays.

The logical relocation of parking and introduction of parking controls along North Woolwich Road will help transition the industrial area into a mixed community suitable for residential co-location.



Phase 1 built form overlaid on 1900 Insurance plan of London, showing rail tracks and building footprints

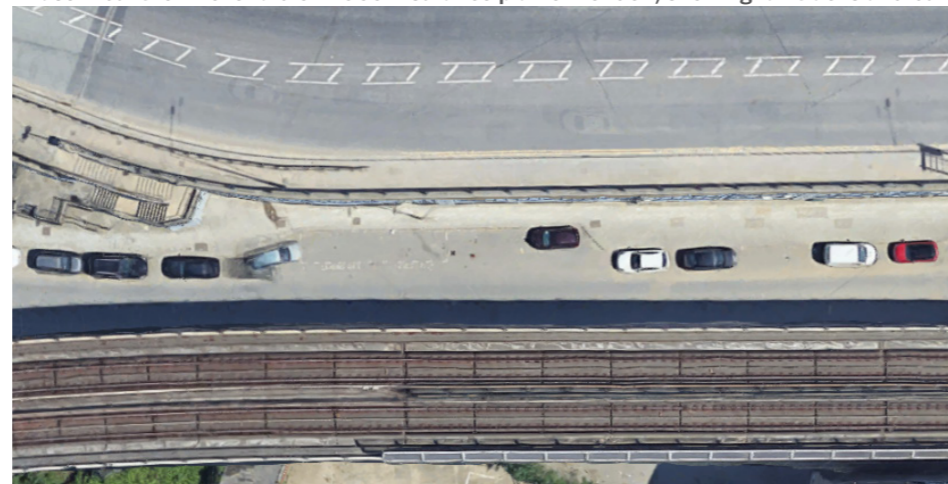

Existing aerial photograph of the Road showing unrestricted parking



Existing photograph of the Road

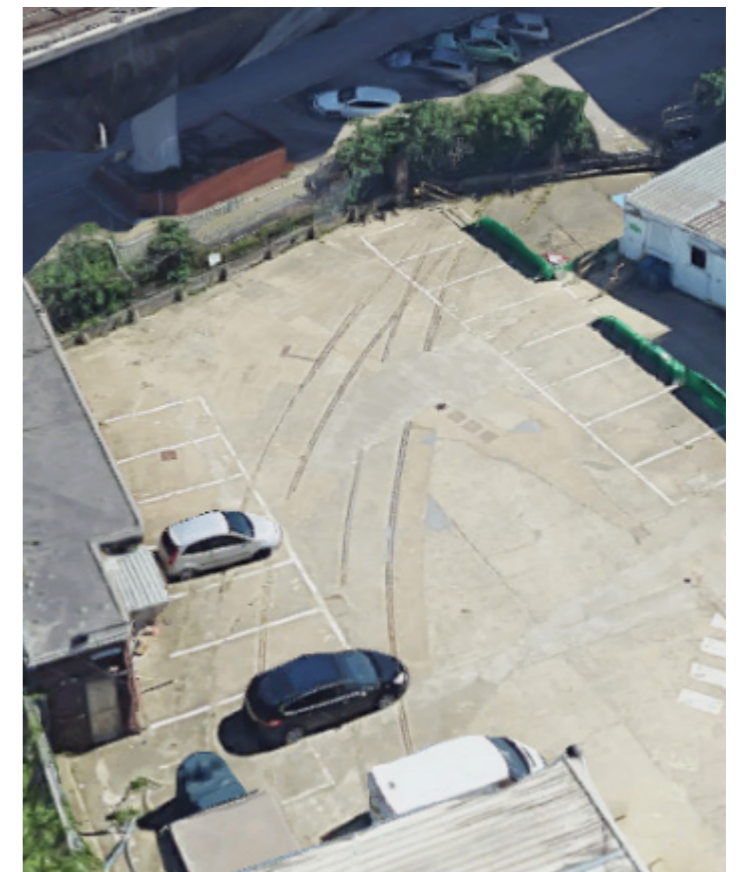

Existing site photography showing rail tracks in ground



Large scale repositionable planter precedent



Tram track precedent



Industrial planter precedent



Mobile planter precedent



'Tramline' street furniture precedents



Goods wagon planters

Extending this into a more permanent setting on the southern pavement, a re-configurable landscape is proposed for the North Woolwich Road gateway into Phase 1.

Re-using and supplementing the existing tracks embedded in the hard landscape, a series of 'goods wagon' planters can be repositioned on the rails to allow future residential wheelchair parking below the DLR, along with inspection and maintenance of the viaduct.



Mobile planter precedent



Mobile planters Tramline