

Once later phases are built the additional basement will significantly change the public realm as street level parking will be moved below ground, freeing up space for pedestrians and planting.

The ground levels will rise up from North Woolwich Road to meet the mezzanine level on the South-West face of Building B, creating a new active commercial frontage and direct access to secure cycle storage.

Quality paving and street tree planting will enhance the pedestrian experience along with the creation of the yard, a new entrance and amenity square for Building A



GROUND FLOOR LONG TERM

Alongside the application proposals, indicative upgrades to North Woolwich Road have been considered, stitching together the Silvertown Tunnel DCO works to Dock Road in the West with potential improvements to North Woolwich Road to the East.

This 'Aspirational' scheme would reconfigure the North Woolwich Road carriageway, footpaths and parking arrangements to ease traffic flows and create a dedicated cycle lane on the south side of the street.

Pedestrian improvements including crossings and logical parking would order the space with quality paving, planters and seating.

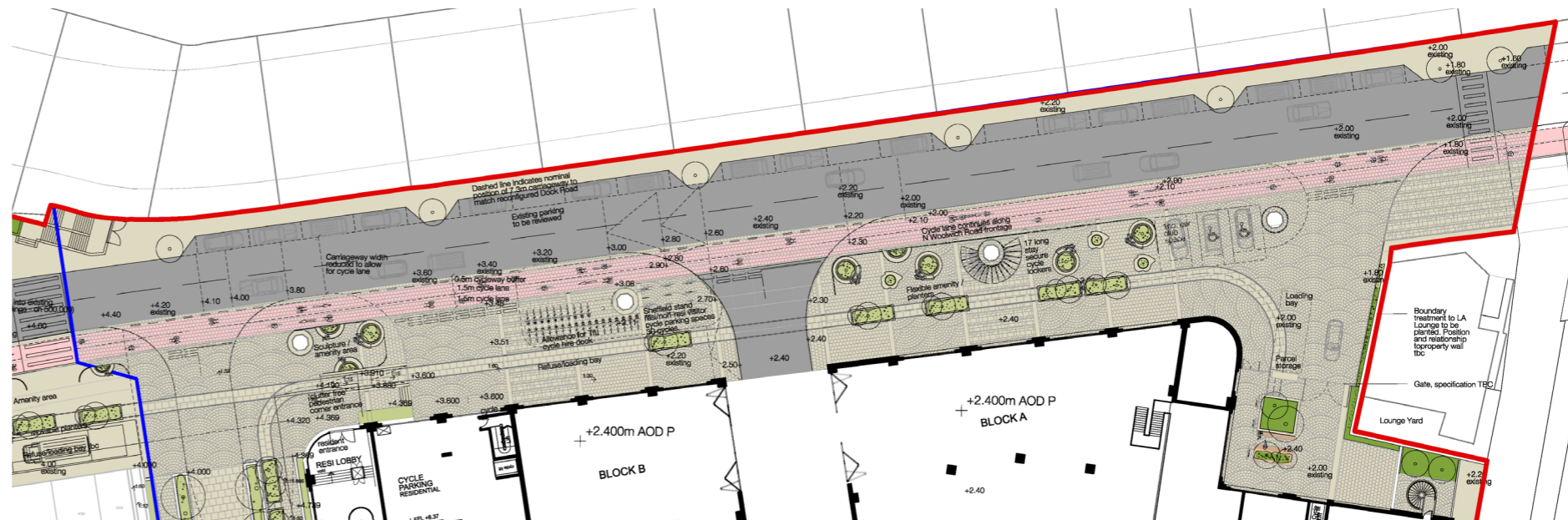

GROUND FLOOR LONG TERM - Aspirational North Woolwich Road improvements