



General Notes
DO NOT SCALE. All dimensions must be checked on site, errors are to be reported.

All illustrated material is subject to copyright. Unless otherwise agreed in writing, all rights to use this document are subject to payment of Architect's charges. This document may only be used for the express purpose and project for which it has been created and delivered, as notified in writing by the Architect. This document may not be otherwise used or copied. Any unauthorised use of this document is at the user's sole risk and without limiting the Architect's rights the user releases and indemnifies the Architect from and against all loss so arising.

Contractors must ensure that cross referenced drawings and specifications noted on these drawings are checked on a regular basis to ensure that the latest revisions are used.

Drawing Notes

Key	ROUTE	ROUTE LENGTH (APPROX)
	Primary running route	2.50 Km
	Short route A	1.00 Km
	Short route B	1.25 Km
	Off site route	0.80 Km
	Alternative park routes	NA
	Cycle route - designated cycle lane	

Key	Description
	Masterplan application boundary
	Detail component boundary

Key Plan

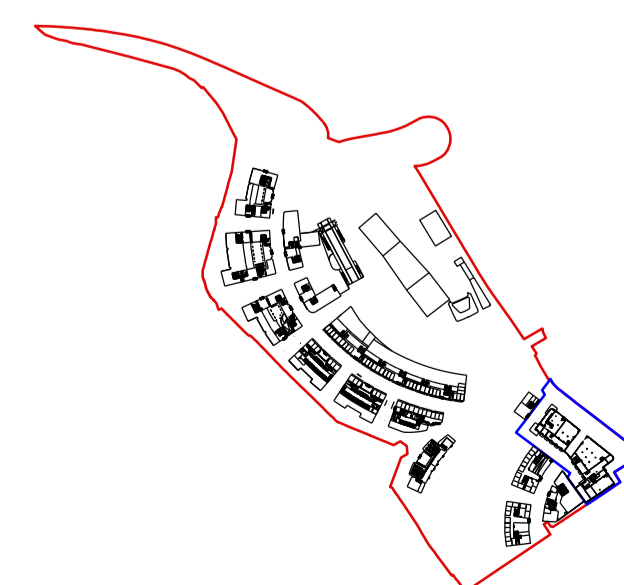

Title
Masterplan Landscape
Running Routes

Project
Thameside West Landscape

Scale
1:1250 @ A1 1:2500 @ A3

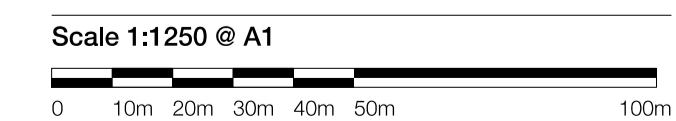

Issue Record	By	Chk	Date
P08 Parking / UGF amendments	RM	-	13.05.2020
P07 Parking amendments	TS	RM	16.04.2020
P06 DEF parking areas	RM	-	23.03.2020
P05 RLB along river	RM	-	19.03.2020

Drawing Number
522-PT-MP-TYP-DR-L-PL-1011

Status
S2 - For Information

Revision
P08

Patel Taylor
48 Rawstorne Street
London EC1V 7ND
T +44 (0)20 7278 2323
www.pateltaylor.co.uk