



Feature location plan (With North Woolwich Road aspirational upgrade)

- Seating/planters
- ┌ low upstand
- DLR column art surrounds (4no.)

PRECEDENTS AND CONCEPTS

4.8 London Cycle Hire Scheme Requirements and potential locations

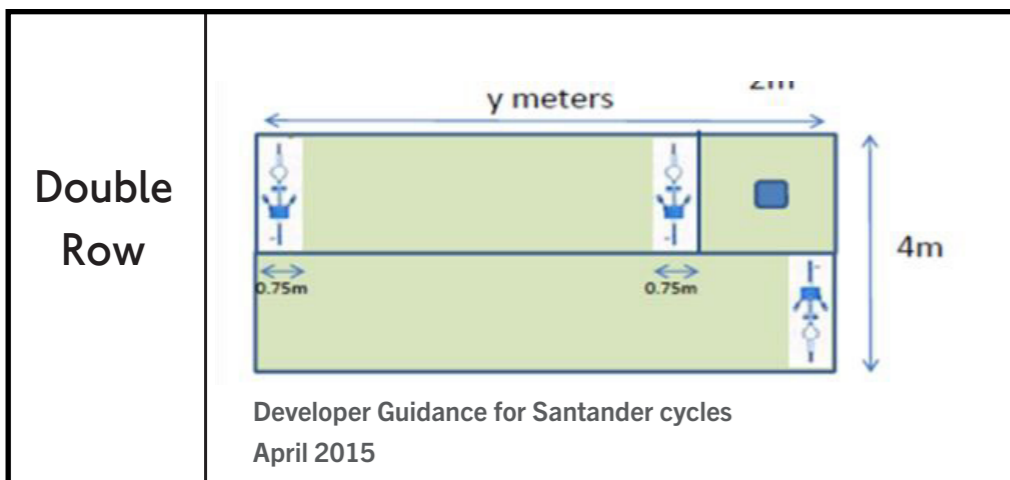
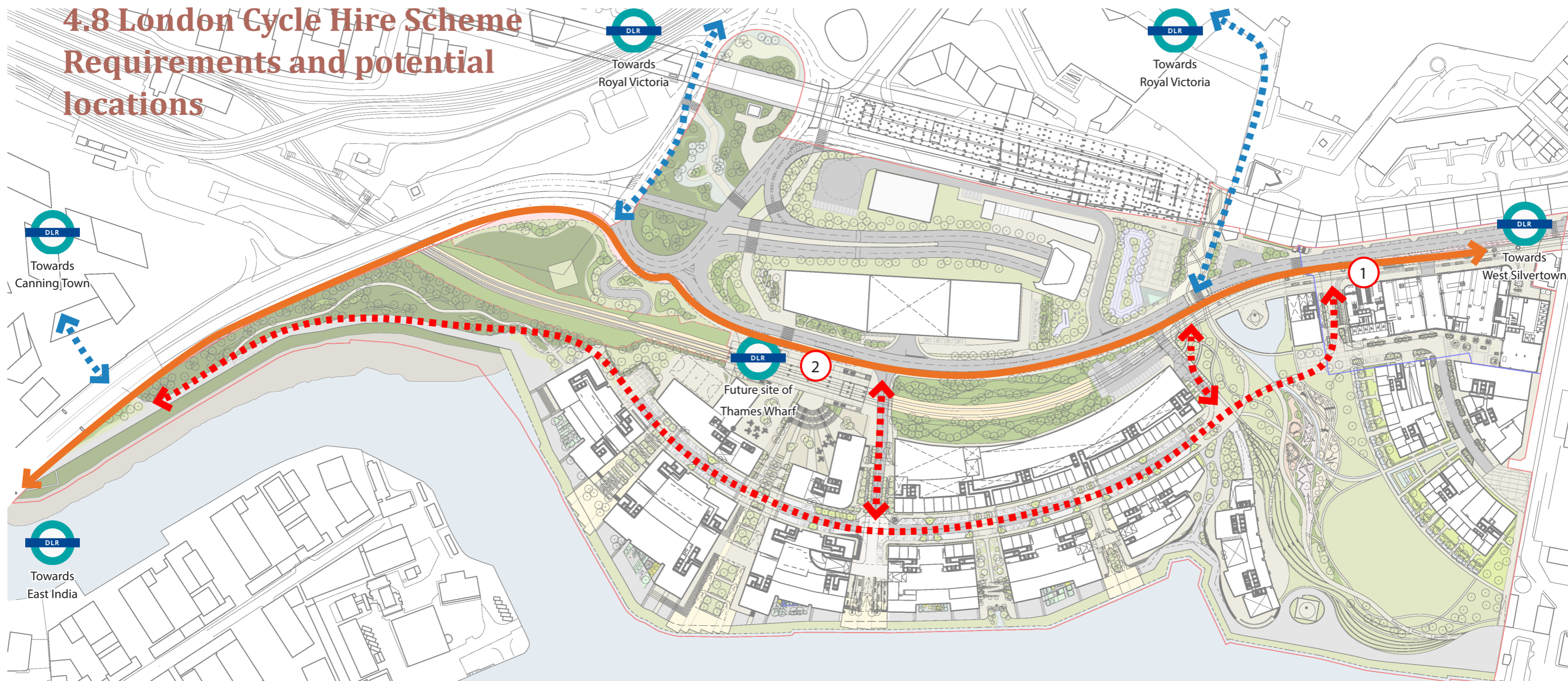

$$DPS = ((\text{Length } (y) - 2.0\text{m}) + (\text{Length } (y)) / 0.75\text{m})$$



1. **Phase 1 - Below elevated DLR**
Access towards West Silvertown and Royal Victoria
Located for Landings workspace and Park
2. **Masterplan - Below new DLR station**
Access towards Royal Victoria and connection at Thames Wharf
Located for Commercial centre and industrial workspace

1. Phase 1 - Below elevated DLR

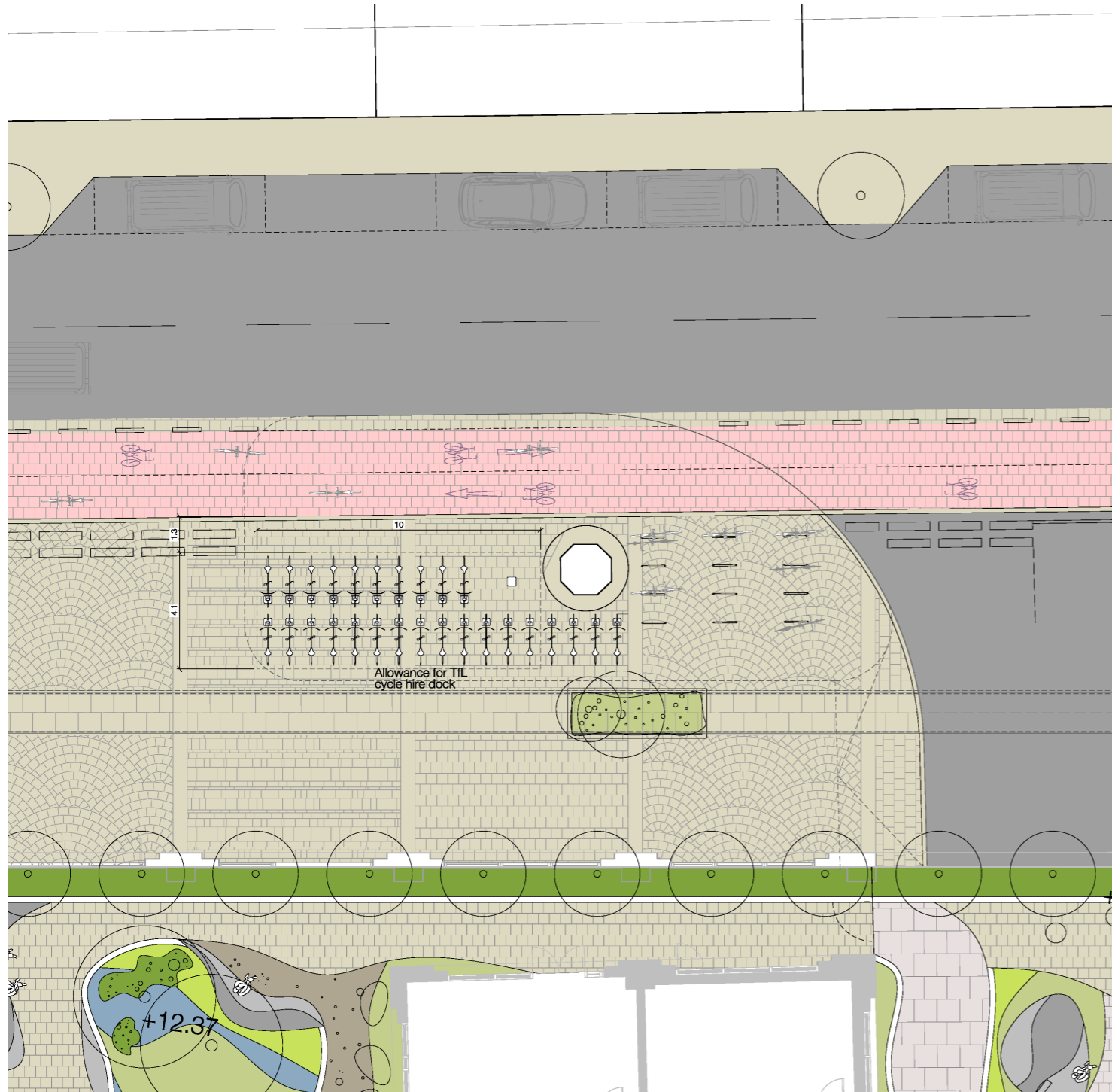

2. Masterplan - Below new DLR station

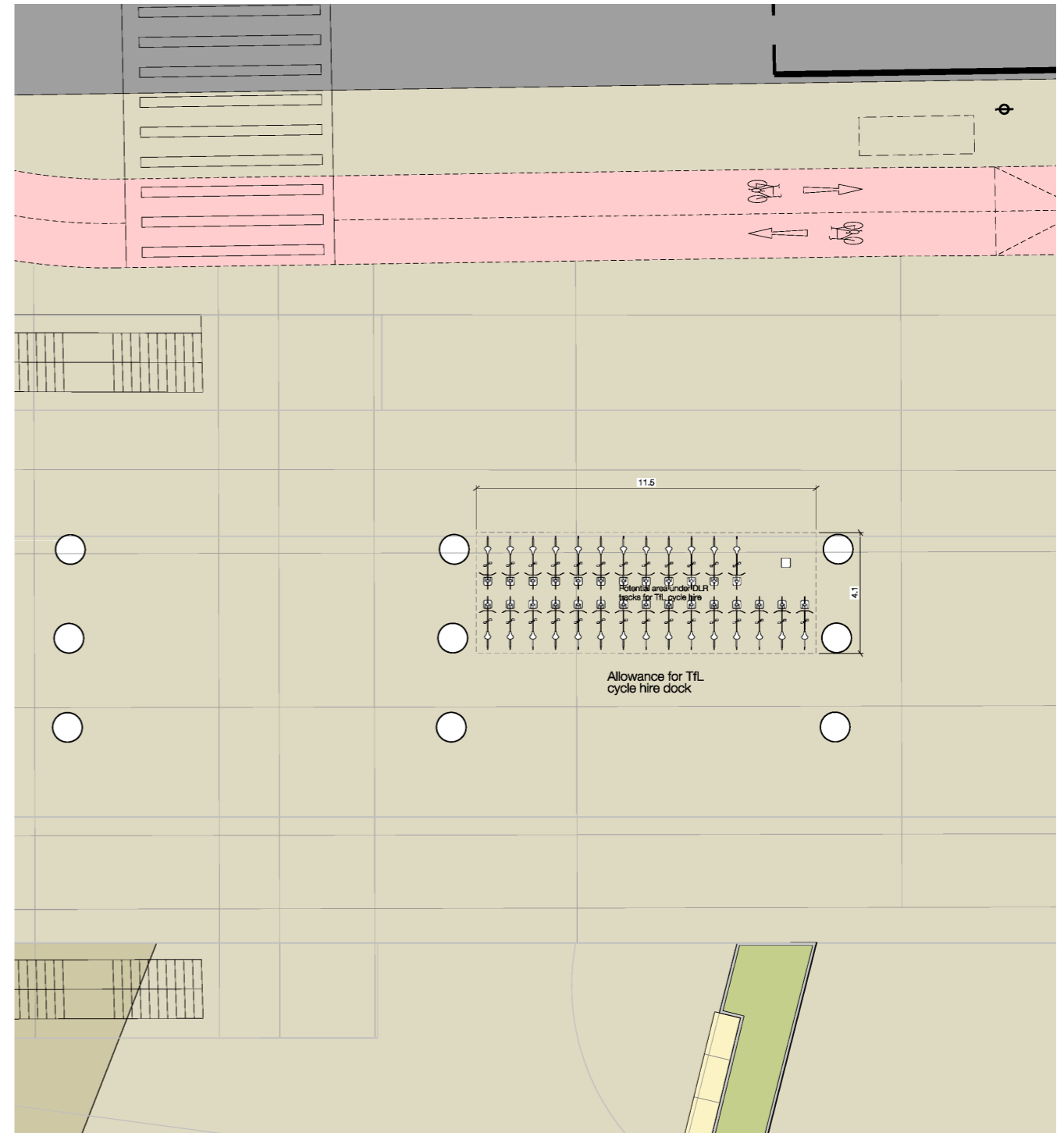

ILLUSTRATIVE PLANS



4.9 Podium courtyard

Amenity areas provide a mixture of size and scale spaces with different opportunities for residents. Built into the landscape are natural play areas with boulders and tree trunks which provide play appropriate for younger age children. This in addition to the future phase park provide ample play and amenity.

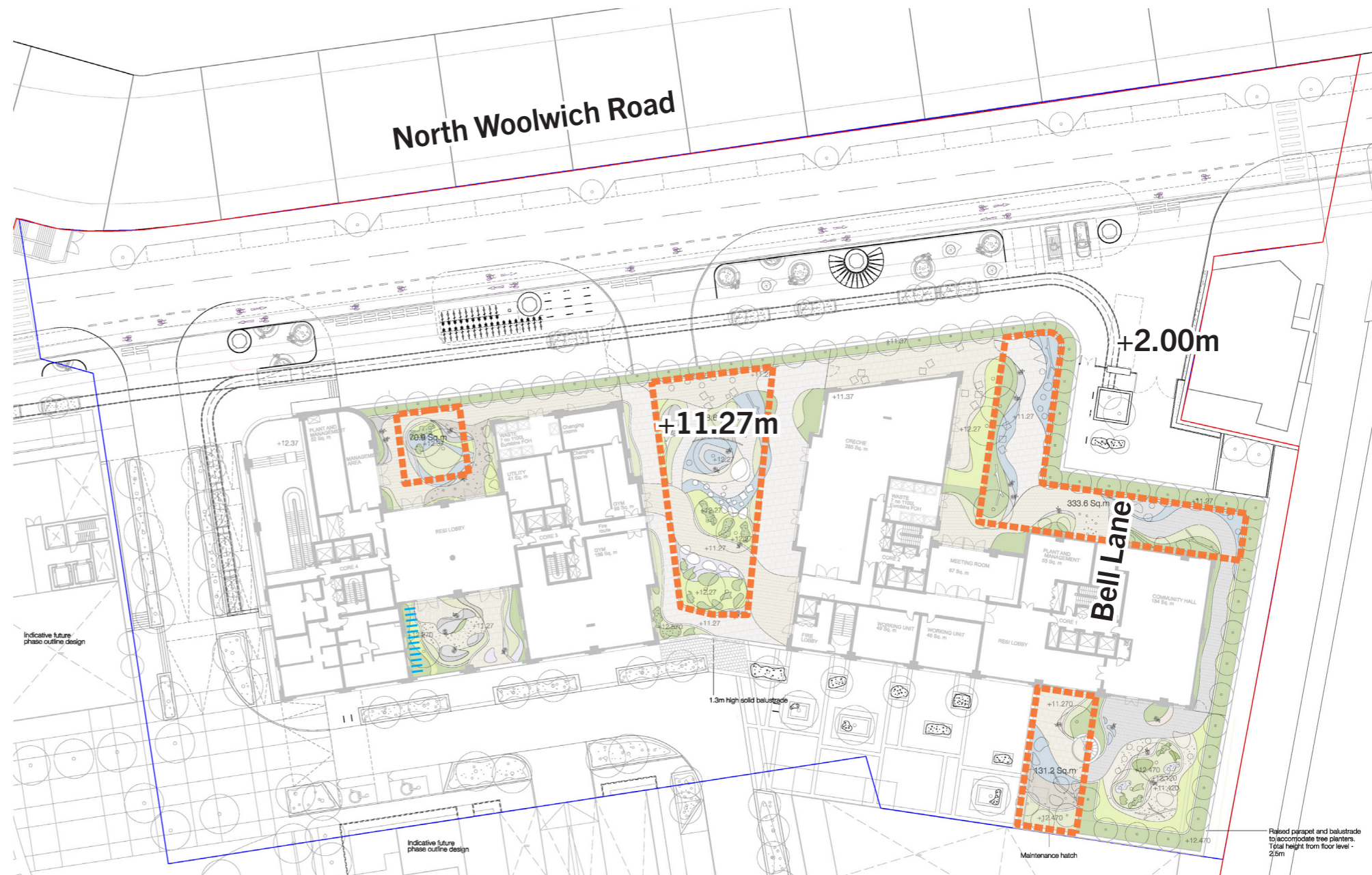
Buffer planting to provide separation and privacy for residents within their home is provided alongside the residential frontage facing onto the common podium courtyard of Building B.



PROPOSED LANDSCAPE AT PODIUM LEVEL

-  Play allocation : 0-4yrs
894.3 sqm
-  Buffer planting



**Podium Courtyard
(With existing North Woolwich Road)**