

General notes

All setting out must be checked on site
 All levels must be checked on site and refer to
 Ordnance Datum Newlyn unless alternative Datum given
 All fixings and weatherings must be checked on site
 This drawing must not be scaled
 This drawing must be read in conjunction with all other
 relevant drawings, specification clauses and current design risk
 register
 This drawing must not be used for land transfer purposes
 Calculated areas in accordance with Assael Architecture's
 Definition of Areas for Schedule of Areas
 This drawing must not be used on site unless issued for
 construction
 Subject to survey, consultation and approval from all statutory
 Authorities

Revision Status:
 P=Preliminary
 C=Contract

© 2019 Assael Architecture Limited

Assael Architecture Limited has prepared this document in
 accordance with the instructions of the Client under the agreed
 Terms of Appointment. This document is for the sole and specific
 use of the Client and Assael Architecture shall not be responsible
 for any use of its contents for any purpose other than that for
 which it was prepared and provided. Should the Client require to
 pass electronic copies of the document to other parties, this
 should be for co-ordination purposes only; the whole of the file
 should be so copied, but no professional liability or warranty shall
 be extended to other parties by Assael Architecture in this
 connection without the explicit written agreement thereto by
 Assael Architecture Limited.

Drawing notes

Electronic file reference
 MNR-AA-SK-230315HB02

Status	R:	Revision	Date	DRN	CHK	CDM
18	For information		25/08/23	ED	HB	
19	For Planning		04/09/23	AL	ED	
20	For Planning		14/09/23	LP	ED	

Purpose of information

The purpose of the information on this
 drawing is for:

Information
 Comment
 Client approval
 Construction

All information on this drawing is not for
 construction unless it is marked for
 construction.

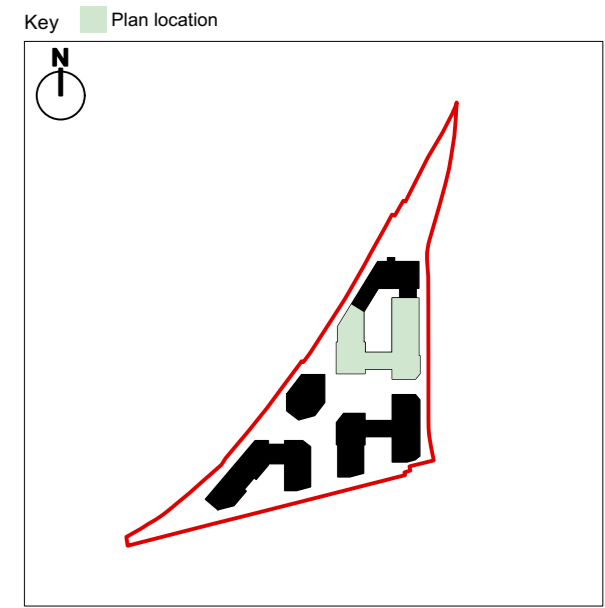

Client
Avanton

Project title
**A3004
 Manor Road Richmond**

Drawing title
**Block A Plans (South) Proposed
 Second Floor**

Scale @ A1 size Date
1:100 Aug '23

Drawing N°
MNR-AA-BA2-02-DR-A-2202

Status & Revision
R20

Assael

Assael Architecture Limited
 123 Upper Richmond Road
 London SW15 2TL

+44 (0)20 7736 7744
 info@assael.co.uk
 www.assael.co.uk