

5.2. The Healthy Street

Underbridge and Slip Road

- 5.2.48. The Underbridge and Slip Road **must** provide a safe and attractive pedestrian and cycle connection under the A12 linking Aberfeldy to the western part of Poplar.
- 5.2.49. The roof of the underbridge should be removed where it is not required for the A12 carriageway or pedestrian access alongside the A12.
- 5.2.50. A light weight pedestrian bridge should connect Joshua Street to the footpath alongside the A12.
- 5.2.51. The route **should** be an activated destination with play, workspace, seating and leisure opportunities that builds upon the character of Highland Place.
- 5.2.52. Paths **must** be installed to gradients compliant to British Standard BS 8300:2018 Design for an Accessible and Inclusive Built Environment.
- 5.2.53. The paved route **should** be for pedestrians and cycles and **should** be a minimum of 4m wide, shared or segregated subject to detail.
- 5.2.54. Clear sightlines through the underbridge **must** be provided for safety and comfort.
- 5.2.55. Workspace units **are encouraged** where they are visible in key views on the approach but without obstructing through views.
- 5.2.56. The interior of the underbridge **should** be dramatic, colourful and well lit.
- 5.2.57. The edges of the Slip Road **should** be framed by low planting and climbers with trees.
- 5.2.58. The Slip Road **should** include a short cut flight of stairs to Joshua Street close to the entrance to the underbridge.



Fig.140 Slip Road- illustrative masterplan extract



Fig.141 View 01 Slip Road looking north towards future Teviott development illustrative visualisation



Fig.142 View 02 Slip Road at junction with Dewbury Close illustrative visualisation



Fig.143 View 03 Slip Road walk with potential leisure space illustrative visualisation



Fig.144 View 04 Slip Road looking towards underbridge and Jolly's Green illustrative visualisation



Fig.145 View 05 Slip Road looking towards underbridge and Jolly's Green (without roof) illustrative visualisation

5.2. The Healthy Street

Jolly's Green

5.2.59. Jolly's Green would become a rejuvenated green space, developed with the local residents in the immediate vicinity, whilst delivering a strategic new pedestrian and cycle connection.

5.2.60. A section of the underpass retaining wall **must** be removed to create access and direct views from the Slip Road and Highland Place to Jolly's Green.

5.2.61. The central segregated footpath cycleway **must** be safe and attractive and allow movement across the A12 between Highland Place and Aberfeldy to the east and Poplar and Chrisp Street to the west.

5.2.62. A secondary north – south accessible route **should** also be provided, aligned similar to the existing.

5.2.63. The combined width of the segregated footpath cycleway **must** be a minimum 5m wide.

5.2.64. The footway **should** be surfaced in coloured asphalt to match all primary paths across Aberfeldy Parks.

5.2.65. The central footpath cycleway **must** be installed to gradients compliant with British Standard BS 8300:2008, Design for an Accessible and Inclusive Built Environment.

5.2.66. Amenity lawns **should** be provided for the flexibility of community daily activities.

5.2.67. The lawns **should** be framed by trees and shrubs for comfort providing recreational and biodiversity value. They should also create a sense of distinct identity from surrounding spaces

5.2.68. Jolly's Green **should** be activated with play, fitness equipment, social terraces, leisure opportunities, and access routes

5.2.69. Workspace units **are encouraged** around the junction with the underbridge to activate the space where they are visible in long views.

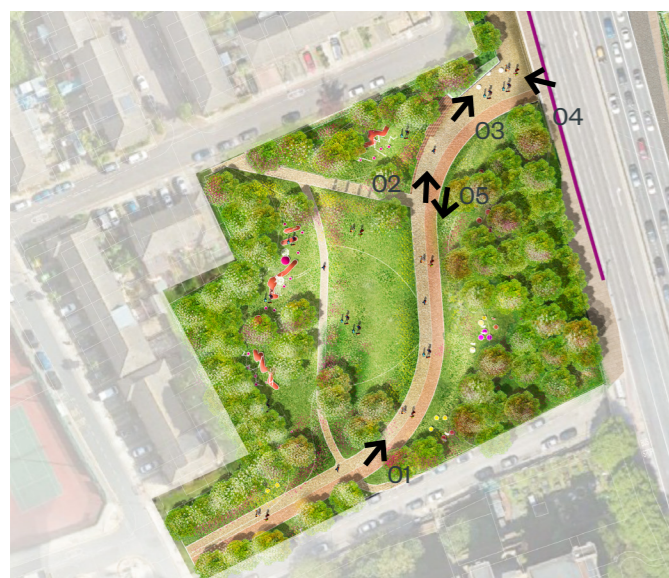

Fig.146 Jolly's Green - landscape concept plan

- Main pedestrian footway
- Vehicle movement
- Cycle path
- Planting opportunity
- Flexible lawn area/Meadow
- Play area
- Node



Fig.147 Jolly's Green - landscape concept plan



Fig.148 View 01 Jolly's Green looking towards underbridge illustrative visualisation



Fig.149 View 02 Jolly's Green approaching underbridge illustrative visualisation



Fig.150 View 03 looking into the underbridge from Jolly's Green illustrative visualisation

5.2. The Healthy Street



Fig.151 View 04 from within under bridge looking towards Jolly's Green illustrative visualisation



Fig.152 View 05 from Jolly's Green looking towards Andrew's Street illustrative visualisation

Soft landscape

5.2.70. Trees and ground flora planting **must** be included in the streetscape and green spaces.

5.2.71. The primary purposes of the open spaces are to provide room for amenity whilst also being a green respite for biodiversity. Therefore amenity lawns **must** be provided and planting **must** be designed to enhance/create existing on Site and off-Site ecological networks.

5.2.72. Tree Species **must** be a mix to ensure biosecurity and **should** be selected from the following species:

Abbott Road:

1. Liriodendron tulipifera, Tulip tree;
2. Carpinus betulus, European hornbeam
3. Tilia cordata; Small-leaf lime



More information on soft landscape can be found in section "4. 3. Green space and infrastructure" on page 76 of this Design Code.

Parks & Green spaces:

1. Betula jacquimontii, Himalayan Birch;
2. Catalpa bignonioides, Southern catalpa
3. Liriodendron tulipifera, Tulip tree;
4. Aesculus indica, Indian Horechesnut;
5. Paulonia fargeaii, Empress tree
6. Prunus serrula, Tibetan Cherry
7. Tilia cordata, Small-leaf Lime
8. Acer campestre, Field Maple
9. Betula pendula, Silver Birch
10. Prunus padus, Bird Cherry
11. Sorbus aucuparia, Rowan



Public realm material palette

5.2.73. The material palette in the public realm **should** be as follows:

Parks & Green spaces:

1. Footpaths: Coloured asphalt
2. Play areas: Rubber crumb safety surfacing

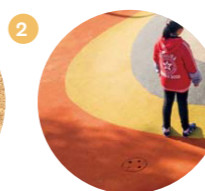

Abbott Road:

1. Carriageway: Asphalt
2. Footways: ASP paving to match surroundings
3. Kerbs: Granite kerbs (silver grey)
4. Raised Tables and Unified-Surface Junctions: Concrete Tegula Block paving
5. OR Raised Tables and Unified-Surface Junctions: Concrete Tegula Block paving

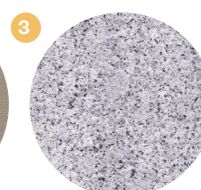
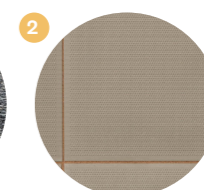

More information on material selection can be found in section "4. 8. Hardscape" on page 92 of this Design Code.