

The Parks

Leven Road Open Space

Parks and Green Spaces Tree

LBTH Tree Officer's Requirements

- Net gain of 2:1 for any trees removed
- Trees are to be planted as a minimum stock size of Semi-mature, in line with BS 3936.
- Planting locations should be chosen to mitigate the amenity impact any tree removals will have on the surrounding area and should also consider post development pressures, such as excessive shade and leaf litter once fully established.
- Tree pit specification for planting in hard and soft landscaping to consider future conflict from root and stem growth with the surrounding environment.

Proposed tree species

- Minimum 3 species native to the UK at each location
- All trees to be of a suitable size, shape and form to allow them to reach their intended proportions without significant or regular pruning. Please consider overall size and spread of tree and the surrounding built environment/ street furniture.
- No planting of *Quercus* sp. Due to the presence of OPM across the Borough.
- Increase in native species: The trees proposed opposite were amended by replacing some of the previously proposed non-native birches with native *Betula pendula* or *B. pubescens* and/or replacing the proposed *Prunus serrula* with native *P. avium* or *P. padus*.
- *Platanus* sp. Low wildlife value/host P&D. Previously proposed, this has now been replaced with an alternative species native to the UK, *Tilia cordata*. *Carpinus betulus* and *Acer campestre* also recommended for this purpose.

Maintenance

- Submission of a tree planting methodology in line with BS 8545 which should describe a process for planting and maintaining young trees that will result in them successfully establishing in the landscape.
- Watering and maintenance: Contractor's responsibility for 3 years (inc. defects liability during year 1).
- Approx 50L per week, equally split between the irrigation tube and irrigation bag, from April through October.

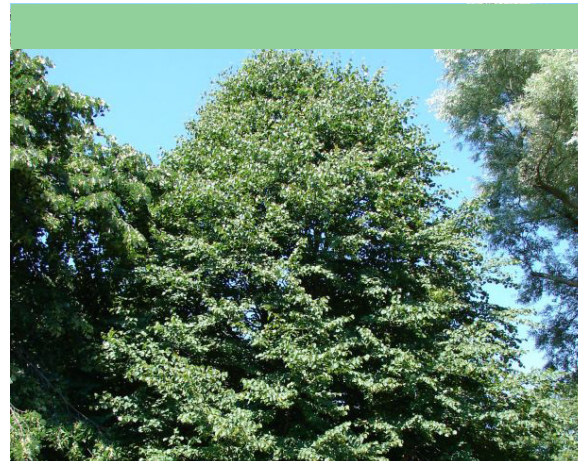

Tilia cordata



Liriodendron tulipifera



Aesculus indica

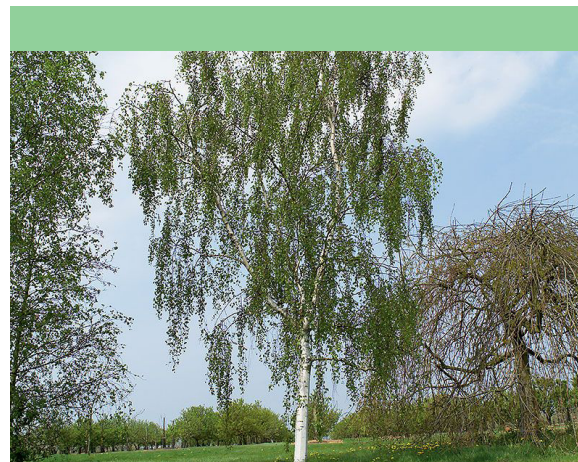

Betula pendula



Catalpa bignonioides



Prunus padus



Paulonia fargesii

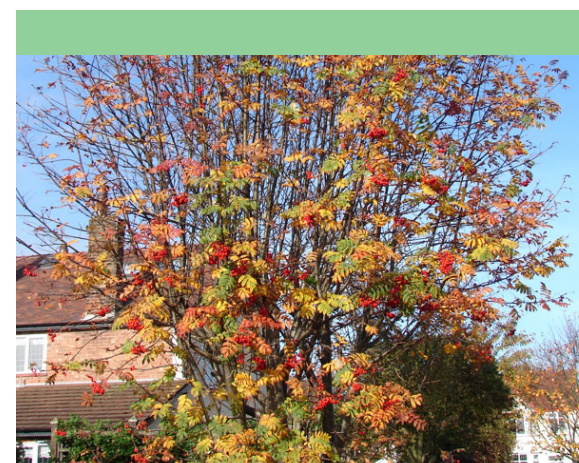

Sorbus aucuparia



Acer campestre

The Parks

Leven Road Open Space

Planting Typology



- Low maintenance border shrub
- Low maintenance shrub and perennial planting mixes
- Low Maintenance Multi-stemmed shrubs and ground cover planting
- Wildflower meadow planting mix

Planting Typology diagram

The Parks

Leven Road Open Space

Planting Typology

The planting typology diagram on the previous page corresponds to the images opposite which illustrate the various soft landscape areas in the park's planting scheme. The habitats vary from flower rich ornamental shrub and perennial planting, to multi-stemmed shrub and ground cover mixes and wildflower meadows. The type of species present within these typologies is illustrated in the following pages and will be developed further with LBTH.

Maintenance Strategy

The proposed areas of soft landscape with lawns, trees and planting will create attractive and inviting spaces. It is paramount that these spaces are well-maintained and cared for to keep them looking beautiful and inviting. How the landscape is maintained begins with how it is designed. London Borough of Tower Hamlets parks and maintenance teams were consulted to help develop the following tree and planting species lists.

The detailed specification, sourcing and quantities of the planting stock will need to be carefully developed throughout the detailed design process to minimise maintenance and associated costs of upkeep.



Low maintenance border shrub planting mix

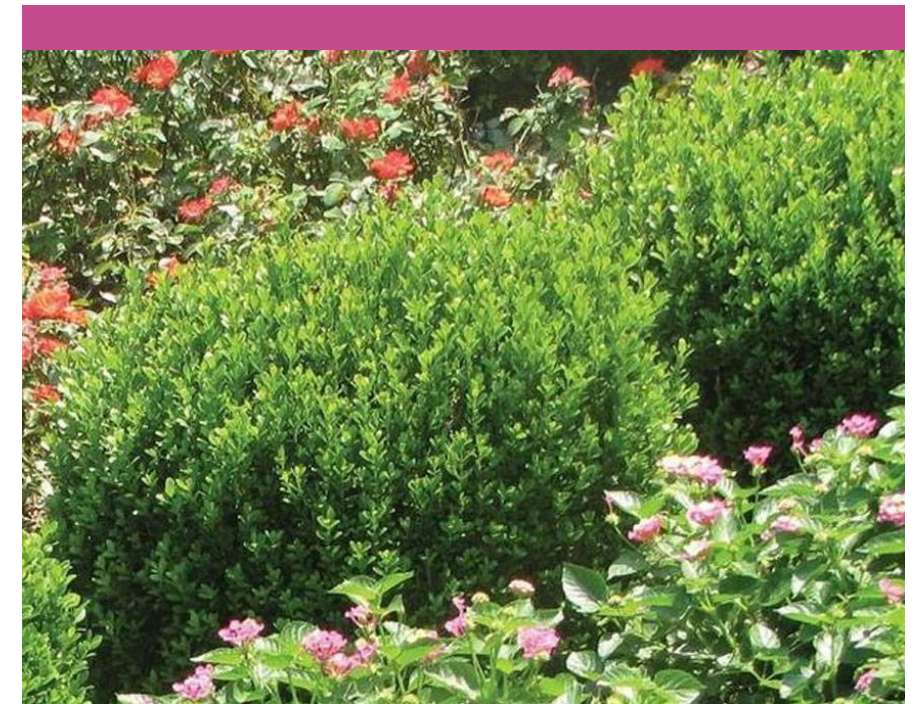

Low maintenance shrub and perennial planting mix

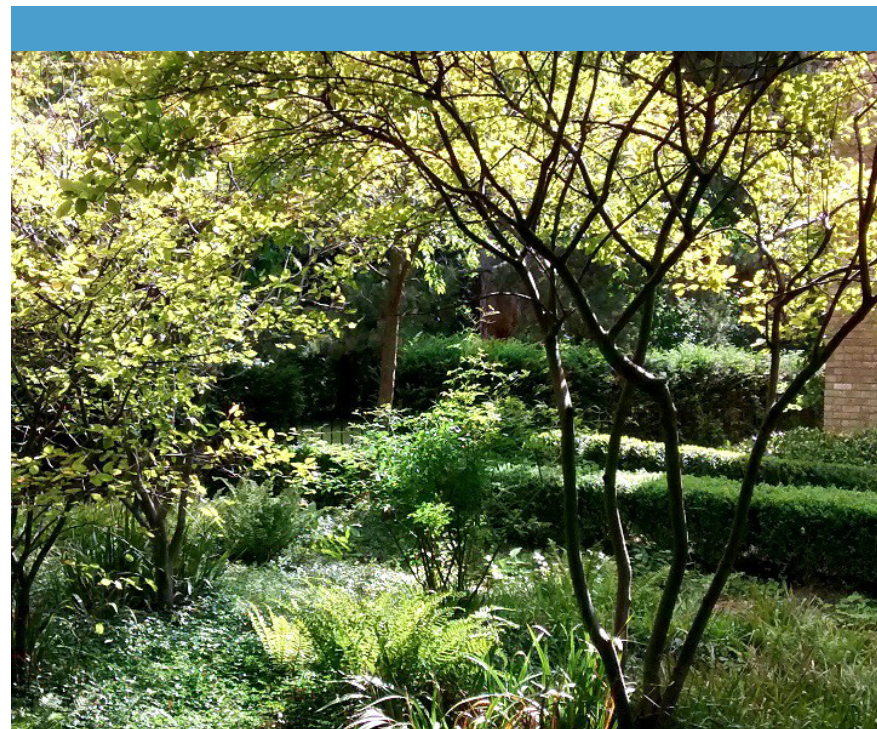

Low maintenance multi-stemmed shrubs and ground cover planting



Wildflower meadow planting mix

The Parks

Leven Road Open Space

Planting Typology - Illustrative Low Maintenance Border Shrub Planting Mix

There is currently no planting to the boundaries of Leven Road Open Space. A mix of shrubs and ground cover planting are designed to be an easily maintained buffer and reinforce the existing greening from the tree structure around the parks' edges.

The aim of the low maintenance borders planting is to bring more diversity through flowers, seasonality as well as structure of planting with low growing plants around edges and along paths. This typology and structural diversity also bring greater biodiversity value despite the species being ornamental. The ultimate size of species will be selected appropriate to the location.

Large shrubs

Viburnum bodnantense

Rosa Nevada

Cotinus coggygria purpureus

Philadelphus virginal

Kerria japonica Pleniflora

Choisya ternata

Forsythia ovata

Fuchsia Madame Cornelissen

Low ground covers

Ceanothus thyrsiflorus repens

Lavandula Hidecote

Fuchsia Mrs Poppo

Philadelphus Manteau d'Hermine

Hypericum androsaemum

Vinca minor Alba



Rosa Nevada



Viburnum bodnantense



Ceanothus thyrsiflorus repens



Vinca minor Alba

The Parks

Leven Road Open Space

Planting Typology - Illustrative Low Maintenance Shrub and Perennial Planting Mix

(Western Planting Beds - Island beds adjacent to the MUGA, Track and Gym)

Planting to be low maintenance shrub and perennials with mixed evergreen and flowering species to ensure year-round cover and seasonal interest.

Planting

Ceanothus thyrsiflorus repens

Lavandula Hidecote

Forsythia ovata

Phylladephus Manteau d'Hermine

Hebe rakiensis

Lonicera pileata

Prunus laurocerasus Otto Luyken

Ribes alpinum

Rosa x paulii

Euphorbia robbiae

Vinca minor Alba

Perennials

Geranium phaeum Raven

Geranium Johnsons Blue

Helenium Moerheim Beauty

Heuchera Palace Purple

Liriope muscari Monroe White

Bergenia cordifolia



Ceanothus thyrsiflorus repens

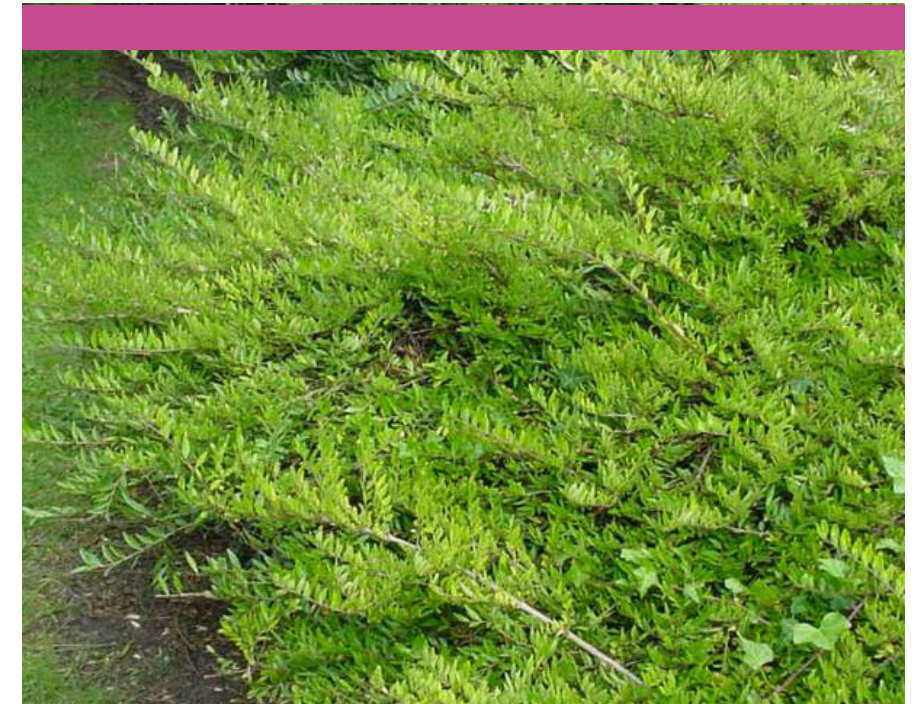

Lonicera pileata

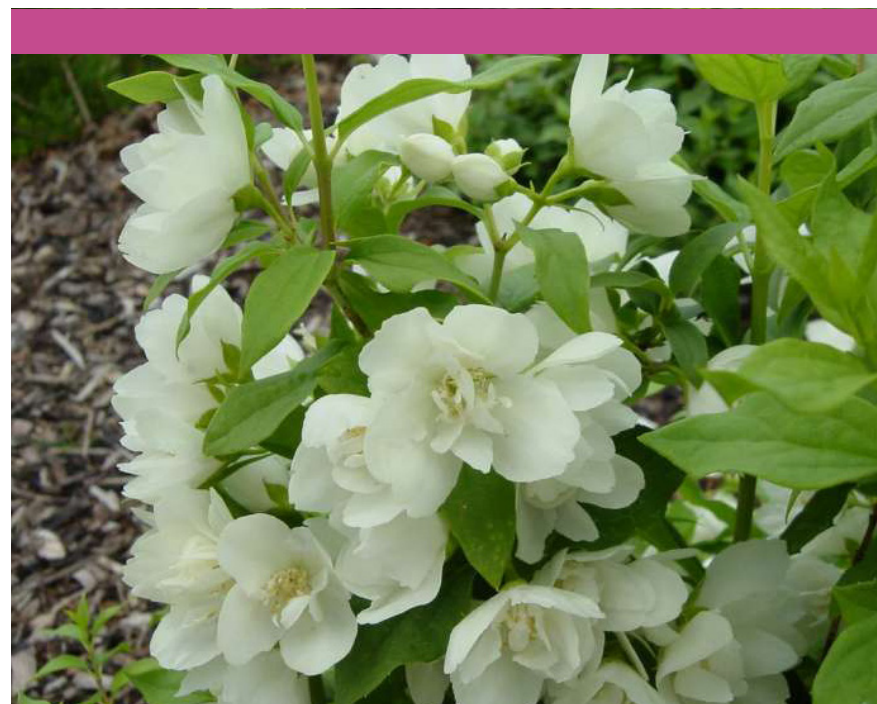

Phylladephus Manteau d'Hermine

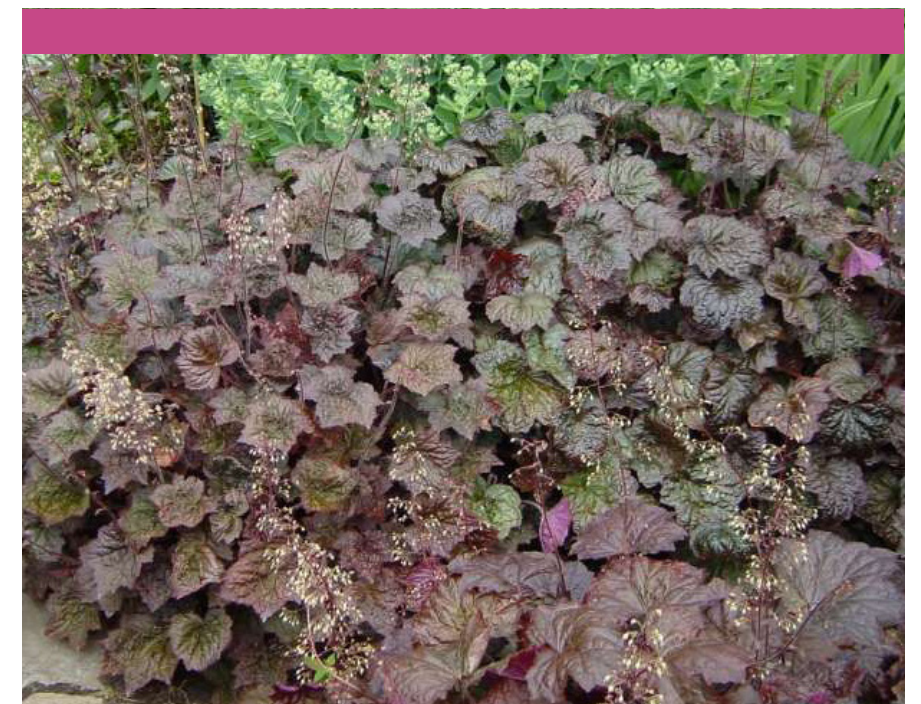

Heuchera Palace Purple

The Parks

Leven Road Open Space

Planting Typology - Illustrative Low Maintenance Multi-stemmed Shrubs and Ground Cover Planting

(East Planting Beds - Adjacent to the cardio workout space and wildflower meadow planting)

Leven Road Open Space has areas of meadow planting in the sunniest south/eastern areas to allow the wildflowers to establish. North of this in the areas around the cardio workout space where screening, light shade and privacy is preferred the planting will be groups of multi-stemmed shrubs arranged informally with mixed evergreen and flowering ground cover underneath.

In this way the space is designed to feel open but is broken up spatially and feels lush and green. This mix will also create a naturalistic border with the wildflower meadow planting and will be a wildlife haven.

Multi-stemmed shrubs

Corylus avellana

Viburnum opulus

Amelanchier lamarckii

Acer campestre

Euonymus europaeus

Ground cover planting

Luzula sylvatica

Dryopteris filix mas

Lonicera pileata

Carex pendula



Amelanchier lamarckii

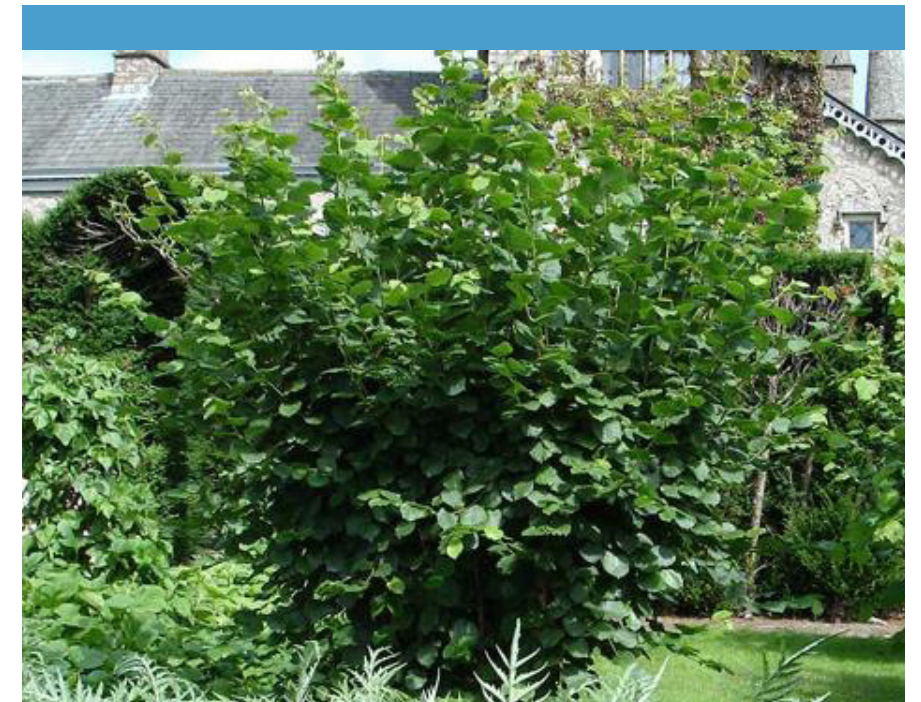

Corylus avellana



Luzula sylvatica

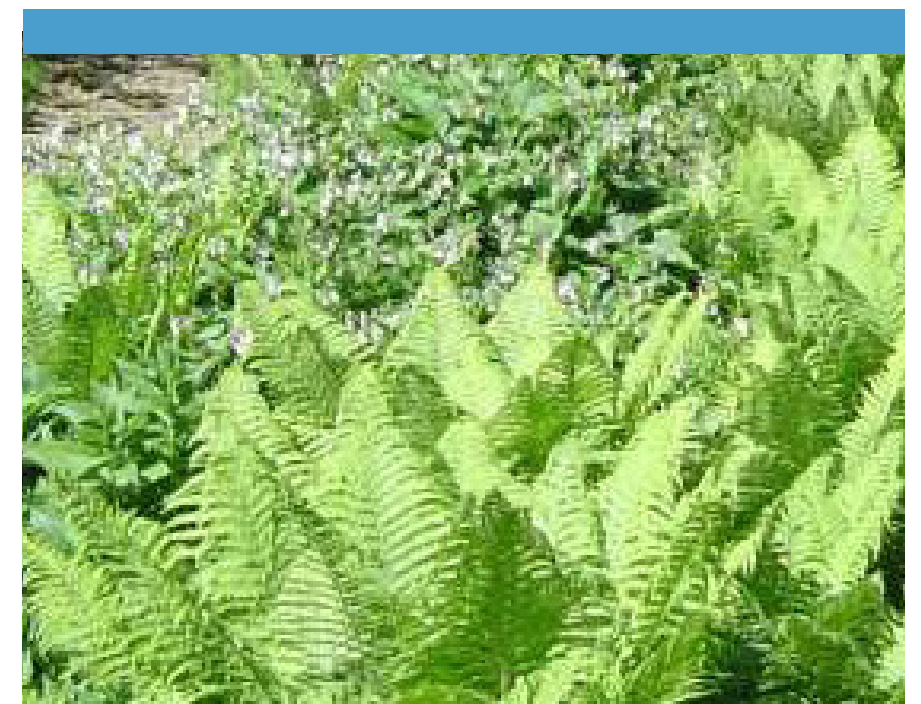

Dryopteris filix mas