



Job title  
**Aberfeldy Village**  
Job no. T5574

Client  
**Aberfeldy New Village LLP**

Map title  
**Tree Constraints Plan**

Section: 4 of 7      Scale (at A3) 1:600

Date of survey  
10/09/2020

Surveyor  
Fearghus Gage

| Drawn | Approved | Date       |
|-------|----------|------------|
| FG    | NC       | 19/11/2020 |



- Legend**
- Crown spread of category C - Trees with low quality and value
  - Crown spread of category B - Trees with moderate quality and value
  - Crown spread of category A - Trees with high quality and value
  - Crown spread of category U - Trees of poor quality
  - Root Protection Area (RPA)
  - Crown spread of Category A groups
  - Crown spread of Category B groups
  - Crown spread of Category C groups
  - Crown spread of Category U groups



This plan is provided solely for the purpose of supporting the description of the arboricultural features of the site as contained in the accompanying report



|                |                                    |                     |
|----------------|------------------------------------|---------------------|
| Job title      | Aberfeldy Village<br>Job no. T5574 |                     |
| Client         | Aberfeldy New Village LLP          |                     |
| Map title      | Tree Constraints Plan              |                     |
| Section:       | 5 of 7                             | Scale (at A3) 1:600 |
| Date of survey | 10/09/2020                         |                     |
| Surveyor       | Fearghus Gage                      |                     |
| Drawn          | Approved                           | Date                |
| FG             | NC                                 | 19/11/2020          |



**Legend**

- Crown spread of category C - Trees with low quality and value
- Crown spread of category B - Trees with moderate quality and value
- Crown spread of category A - Trees with high quality and value
- Crown spread of category U - Trees of poor quality
- Root Protection Area (RPA)
- Crown spread of Category A groups
- Crown spread of Category B groups
- Crown spread of Category C groups
- Crown spread of Category U groups

This plan is provided solely for the purpose of supporting the description of the arboricultural features of the site as contained in the accompanying report

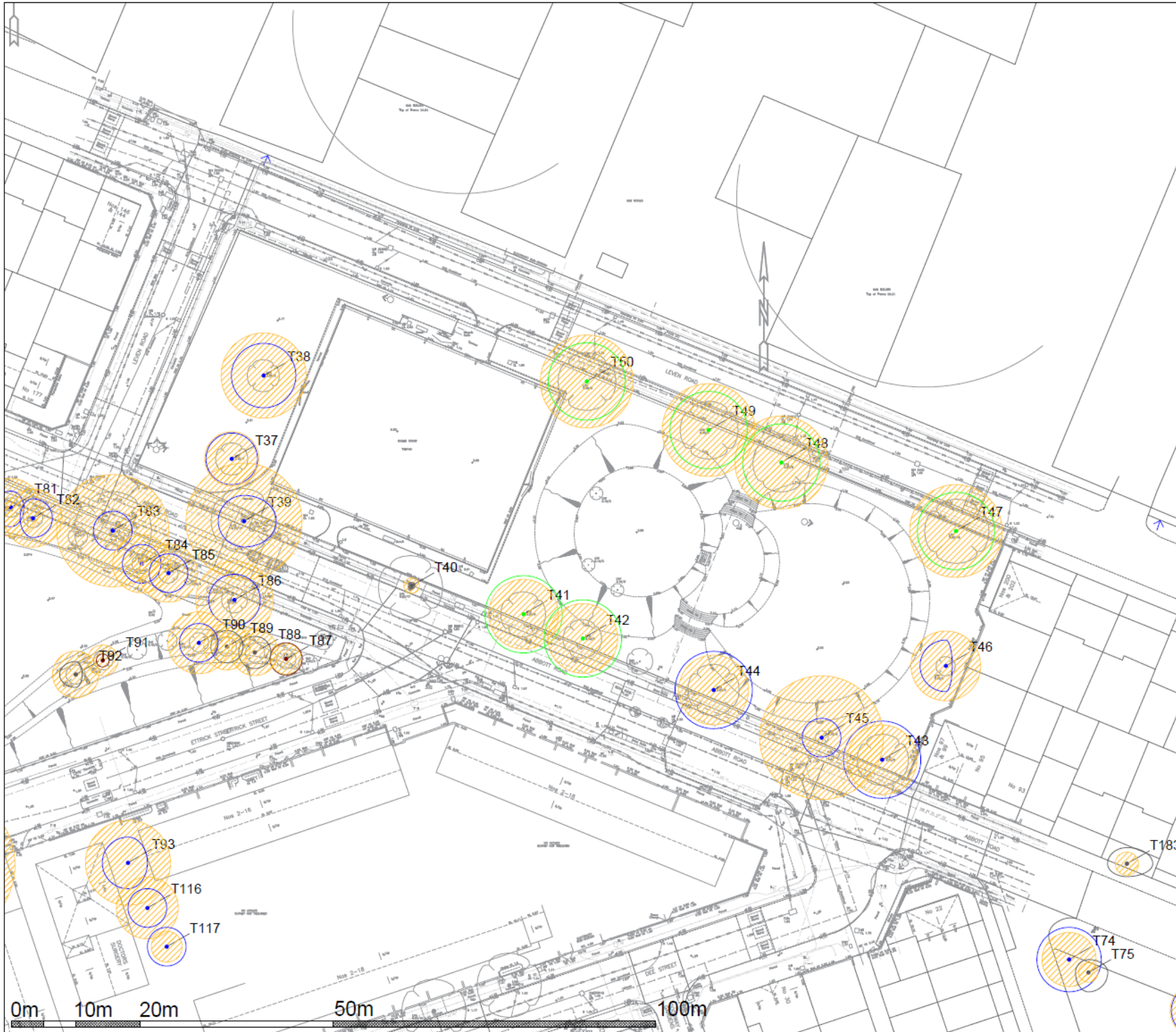

|                |                                    |                     |
|----------------|------------------------------------|---------------------|
| Job title      | Aberfeldy Village<br>Job no. T5574 |                     |
| Client         | Aberfeldy New Village LLP          |                     |
| Map title      | Tree Constraints Plan              |                     |
| Section:       | 6 of 7                             | Scale (at A3) 1:600 |
| Date of survey | 10/09/2020                         |                     |
| Surveyor       | Fearghus Gage                      |                     |
| Drawn          | Approved                           | Date                |
| FG             | NC                                 | 19/11/2020          |



- Legend**
- Crown spread of category C - Trees with low quality and value
  - Crown spread of category B - Trees with moderate quality and value
  - Crown spread of category A - Trees with high quality and value
  - Crown spread of category U - Trees of poor quality
  - Root Protection Area (RPA)
  - Crown spread of Category A groups
  - Crown spread of Category B groups
  - Crown spread of Category C groups
  - Crown spread of Category U groups



This plan is provided solely for the purpose of supporting the description of the arboricultural features of the site as contained in the accompanying report



**arbeco**  
Ecology, Tree & Habitat Services

Job title: Aberfeldy Village  
Job no. T5574

Client: Aberfeldy New Village LLP

Map title: Tree Constraints Plan

Section: 7 of 7      Scale (at A3): 1:600

Date of survey: 10/09/2020

Surveyor: Fearghus Gage

| Drawn | Approved | Date       |
|-------|----------|------------|
| FG    | NC       | 19/11/2020 |

**Legend**

- Crown spread of category C - Trees with low quality and value
- Crown spread of category B - Trees with moderate quality and value
- Crown spread of category A - Trees with high quality and value
- Crown spread of category U - Trees of poor quality
- ▨ Root Protection Area (RPA)
- ▨ Crown spread of Category A groups
- ▨ Crown spread of Category B groups
- ▨ Crown spread of Category C groups
- ▨ Crown spread of Category U groups

N

This plan is provided solely for the purpose of supporting the description of the arboricultural features of the site as contained in the accompanying report

# Appendix 3: Tree Retention and Removal Plan

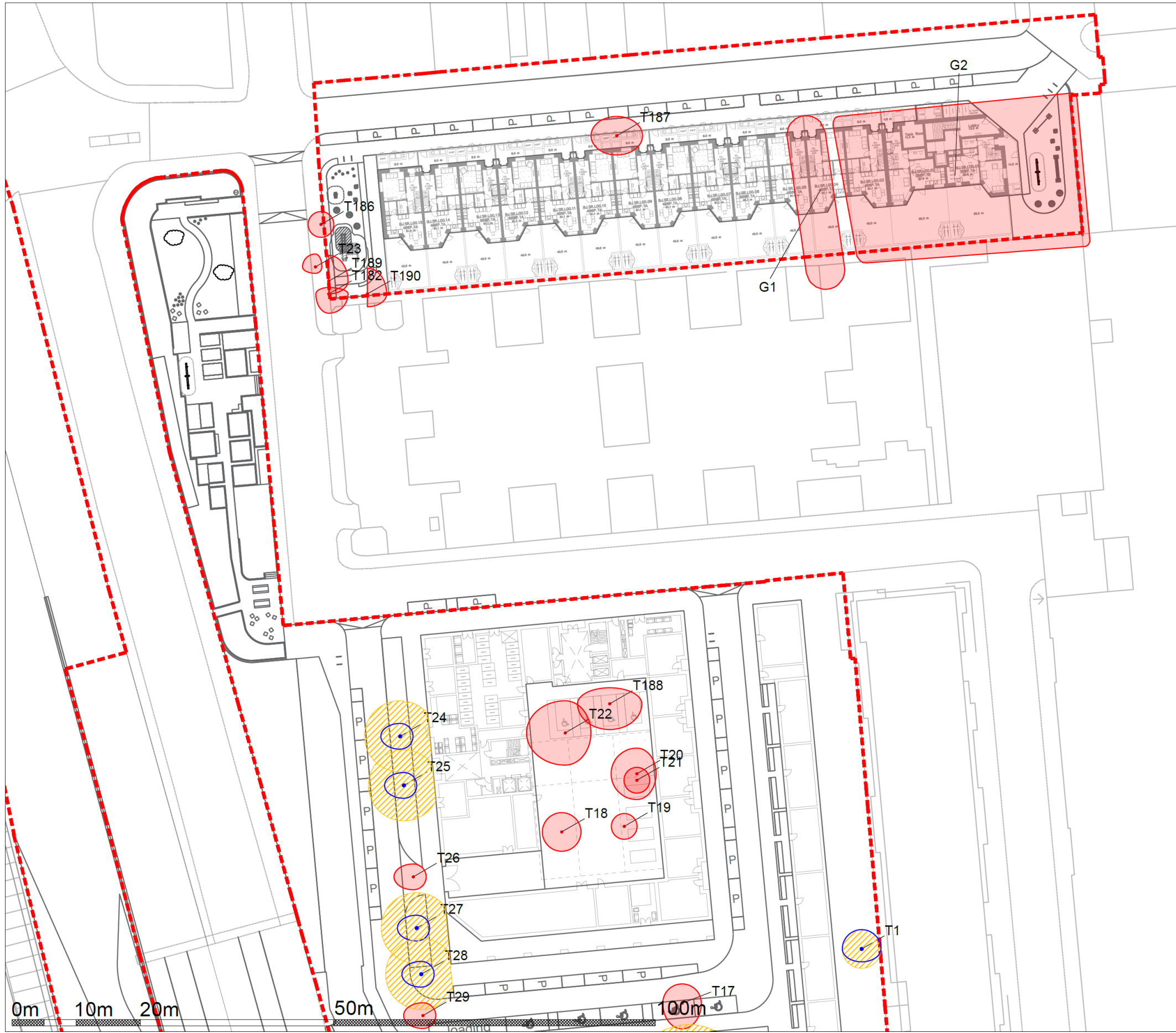

Job title  
**Aberfeldy Village**  
Job no. T5574

Client  
**Aberfeldy New Village LLP**

Map title  
**Tree Retention and Removal Plan**

Section: 1 of 7      Scale (at A3) 1:600

Date of survey  
10/09/2020

Surveyor  
Fearghus Gage

| Drawn | Approved | Date       |
|-------|----------|------------|
| FG    | NC       | 13/10/2021 |



- Legend**
- Crown spread of category C - Trees with low quality and value
  - Crown spread of category B - Trees with moderate quality and value
  - Crown spread of category A - Trees with high quality and value
  - Crown spread of category U - Trees of poor quality
  - Root Protection Area (RPA)
  - Crown spread of Category A groups
  - Crown spread of Category B groups
  - Crown spread of Category C groups
  - RPA Incursion - hardstanding
  - RPA Incursion - building foundations
  - Application boundary
  - Trees to be removed

This plan is provided solely for the purpose of supporting the description of the arboricultural features of the site as contained in the accompanying report

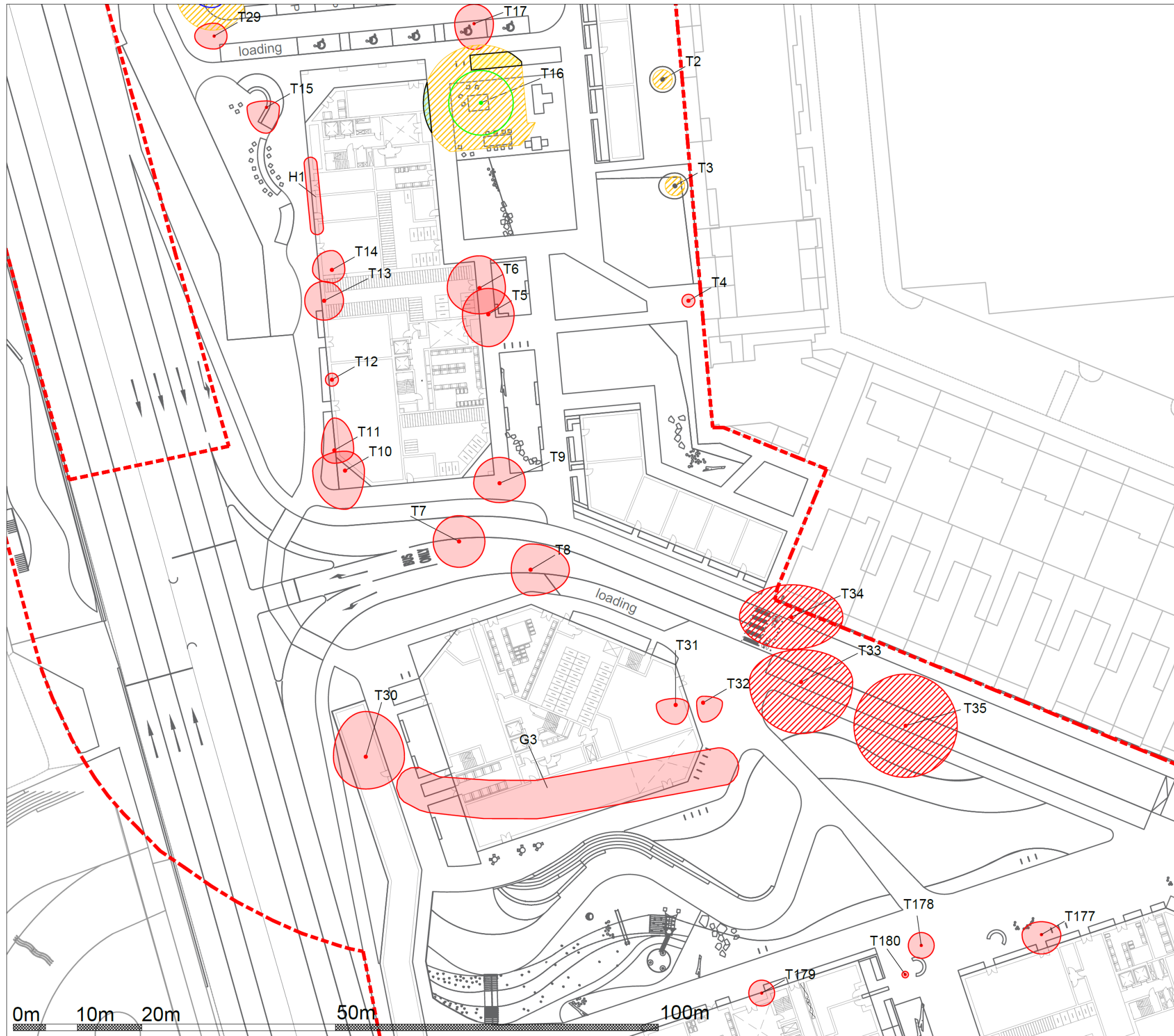

Job title  
**Aberfeldy Village**  
Job no. T5574

Client  
**Aberfeldy New Village LLP**

Map title  
**Tree Retention and Removal Plan**

Section: 2 of 7      Scale (at A3) 1:600

Date of survey  
10/09/2020

Surveyor  
Fearghus Gage

| Drawn | Approved | Date       |
|-------|----------|------------|
| FG    | NC       | 13/10/2021 |



- Legend
- Crown spread of category C - Trees with low quality and value
  - Crown spread of category B - Trees with moderate quality and value
  - Crown spread of category A - Trees with high quality and value
  - Crown spread of category U - Trees of poor quality
  - Root Protection Area (RPA)
  - Crown spread of Category A groups
  - Crown spread of Category B groups
  - Crown spread of Category C groups
  - RPA Incursion - hardstanding
  - RPA Incursion - building foundations
  - Application boundary
  - Trees to be removed

This plan is provided solely for the purpose of supporting the description of the arboricultural features of the site as contained in the accompanying report

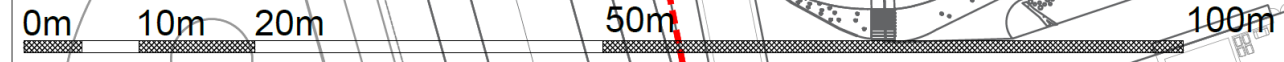

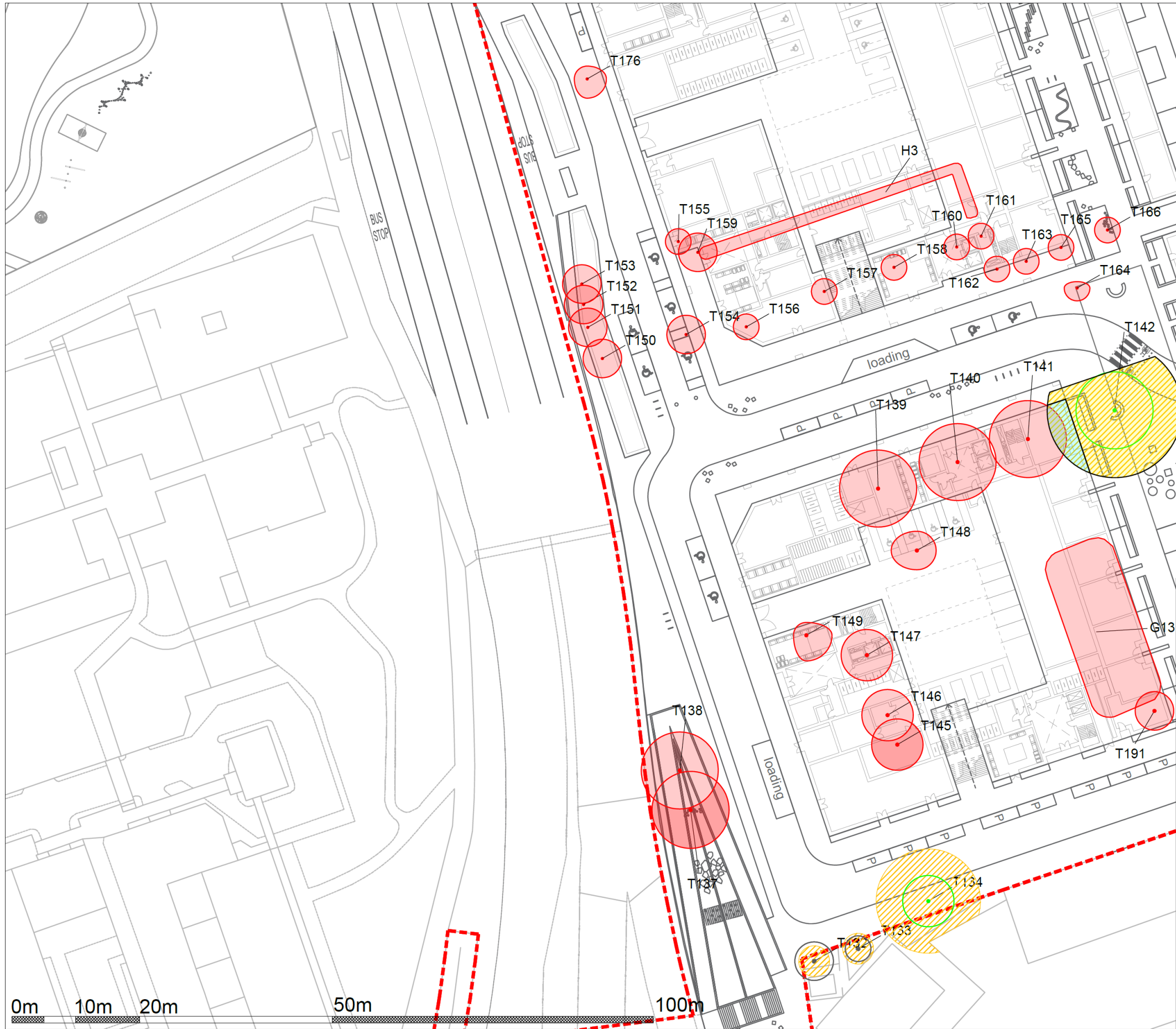

**arbeco**  
Ecology, Tree & Habitat Services

Job title  
**Aberfeldy Village**  
Job no. T5574

Client  
**Aberfeldy New Village LLP**

Map title  
**Tree Retention and Removal Plan**

Section: 3 of 7      Scale (at A3) 1:600

Date of survey  
10/09/2020

Surveyor  
Fearghus Gage

|       |          |            |
|-------|----------|------------|
| Drawn | Approved | Date       |
| FG    | NC       | 13/10/2021 |

- Legend**
- Crown spread of category C - Trees with low quality and value
  - Crown spread of category B - Trees with moderate quality and value
  - Crown spread of category A - Trees with high quality and value
  - Crown spread of category U - Trees of poor quality
  - Root Protection Area (RPA)
  - Crown spread of Category A groups
  - Crown spread of Category B groups
  - Crown spread of Category C groups
  - RPA Incursion - hardstanding
  - RPA Incursion - building foundations
  - Application boundary
  - Trees to be removed

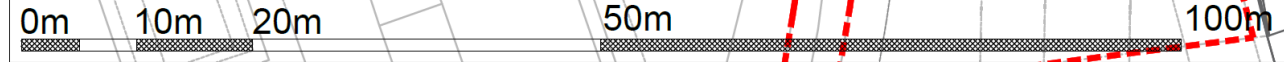

This plan is provided solely for the purpose of supporting the description of the arboricultural features of the site as contained in the accompanying report