

The Play Street - Kirkmichael Road



3D Visualisation

The Play Street - Kirkmichael Road



3D Visualisation

The Play Street - Kirkmichael Road

Proposals for Kirkmichael Road

Details

Planting would have a sensory dimension to add to the playful quality of the space and additional smaller play elements, such as stepping cubes, will liven the street between formal play equipment.



Play Equipment

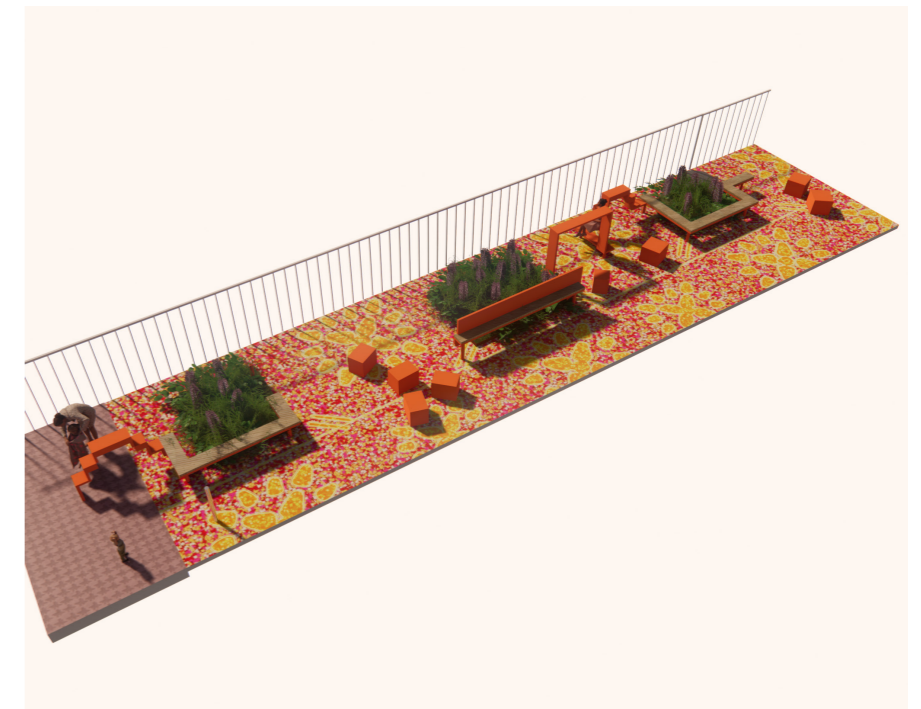

Long Seat



The Residential Street - Lansbury Gardens

The Life of A Residential Street

Lansbury Gardens will be freed from the messy and intrusive consequences of the rear servicing and associated parking.

The space will be a functional residential street providing pedestrian, cycle and vehicle access to the existing houses. At ground level it will offer a secondary access to building H3, along with access to its bin stores and refuse stores. Refuse collection will be carried out from the road with bins being moved across the public realm to the waste collection trucks.

It will also serve as valuable parking with the 7 existing Lansbury Gardens resident parking spaces retained and the addition of 2 accessible parking spaces as well as 2 car club spaces on the western side of the road.

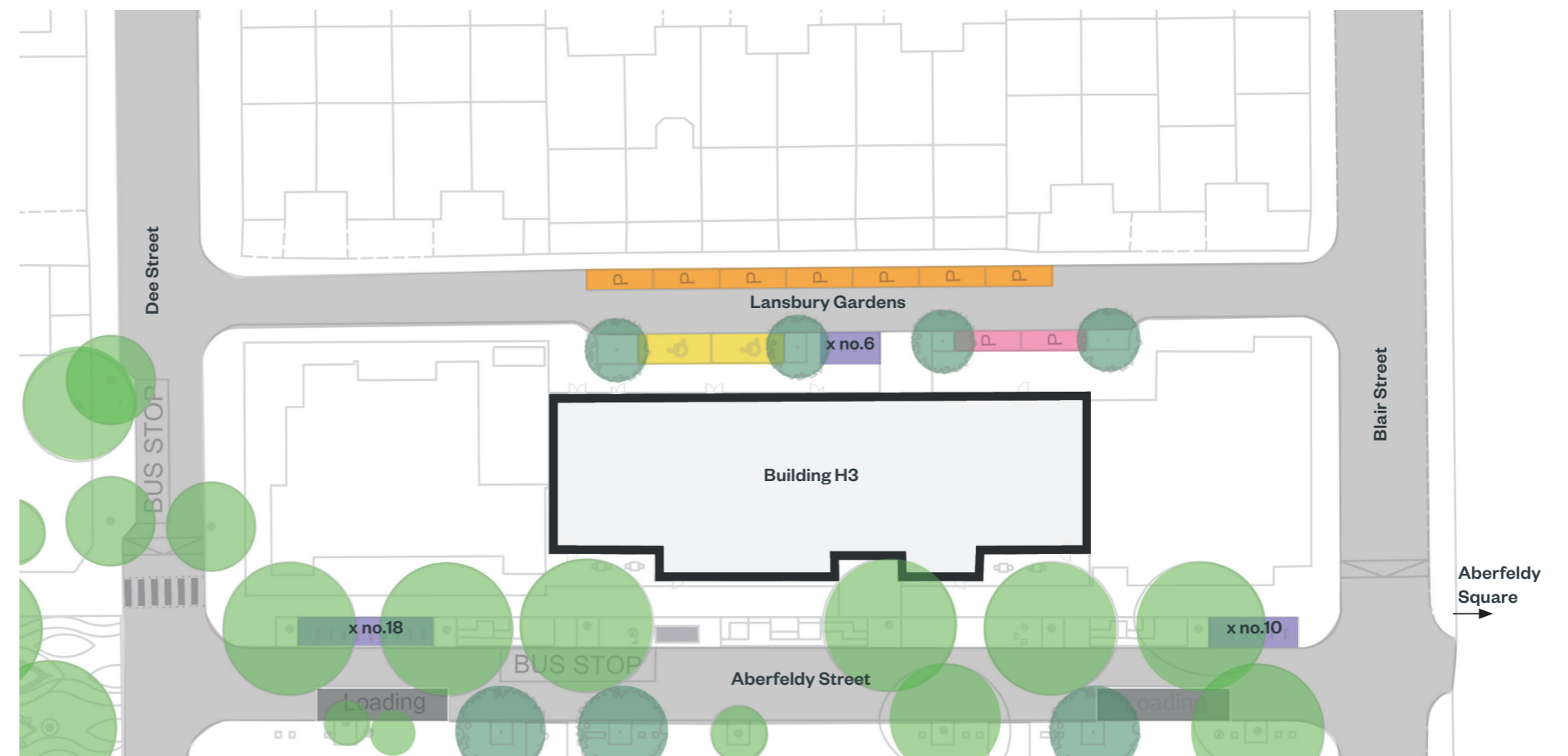

- Accessible parking provision
- Road
- Car club parking provision
- Cycle parking provision
- Existing parking bay
- Proposed tree
- Existing tree



Diagram of Function – Road and parking

The Residential Street - Lansbury Gardens

Proposals for Lansbury Gardens

The footway on the H3 side of the road would be Perfecta paving flags with granite kerbs to be consistent with the High Street. This would be enlivened by red precast concrete 'door mat' to the residential entrance of building H3.

New tree planting where there is space, on the western side of the street, would break up the arrangement of parking, introduce greenery into the street as well as mediate the new building into the street.



Illustrative Plan