



BASED ON ORDNANCE SURVEY MAPPING AND REPRODUCED BY TRANSPORT PLANNING PRACTICE WITH THE PERMISSION OF THE CONTROLLER OF HMSO © CROWN COPYRIGHT
 Based on layout, drawing number c034 L100 [Rev p0], TPP REF - IN_73.

This drawing has been prepared for planning purposes and should not be used for construction.

Vehicle used	
FTA Design HG Rigid Vehicle (1998)	10.000m
Overall Length	2.500m
Overall Width	3.645m
Overall Body Height	0.440m
Min Body Ground Clearance	2.470m
Track Width	3.00s
Lock to Lock Time	11.000m
Kerb to Kerb Turning Radius	

CHARLTON RIVERSIDE, GREENWICH

Plot A

Swept path analysis of 10.0m Rigid HGV

TRANSPORT PLANNING PRACTICE
 70 Cowcross Street
 London, EC1M 6EL
 t: 020 7608 0008
 w: www.tppweb.co.uk



SCALE @ A3 1:1000	DATE 29/11/16	DRAWN BY LD	CHECKED CW	DRAWING NUMBER 30821/AC/119	REV -
-------------------	---------------	-------------	------------	-----------------------------	-------

T:\300000_Projects\30821 Charlton Riverside, Greenwich\ACAD\Interim scheme\119 - 122.dwg

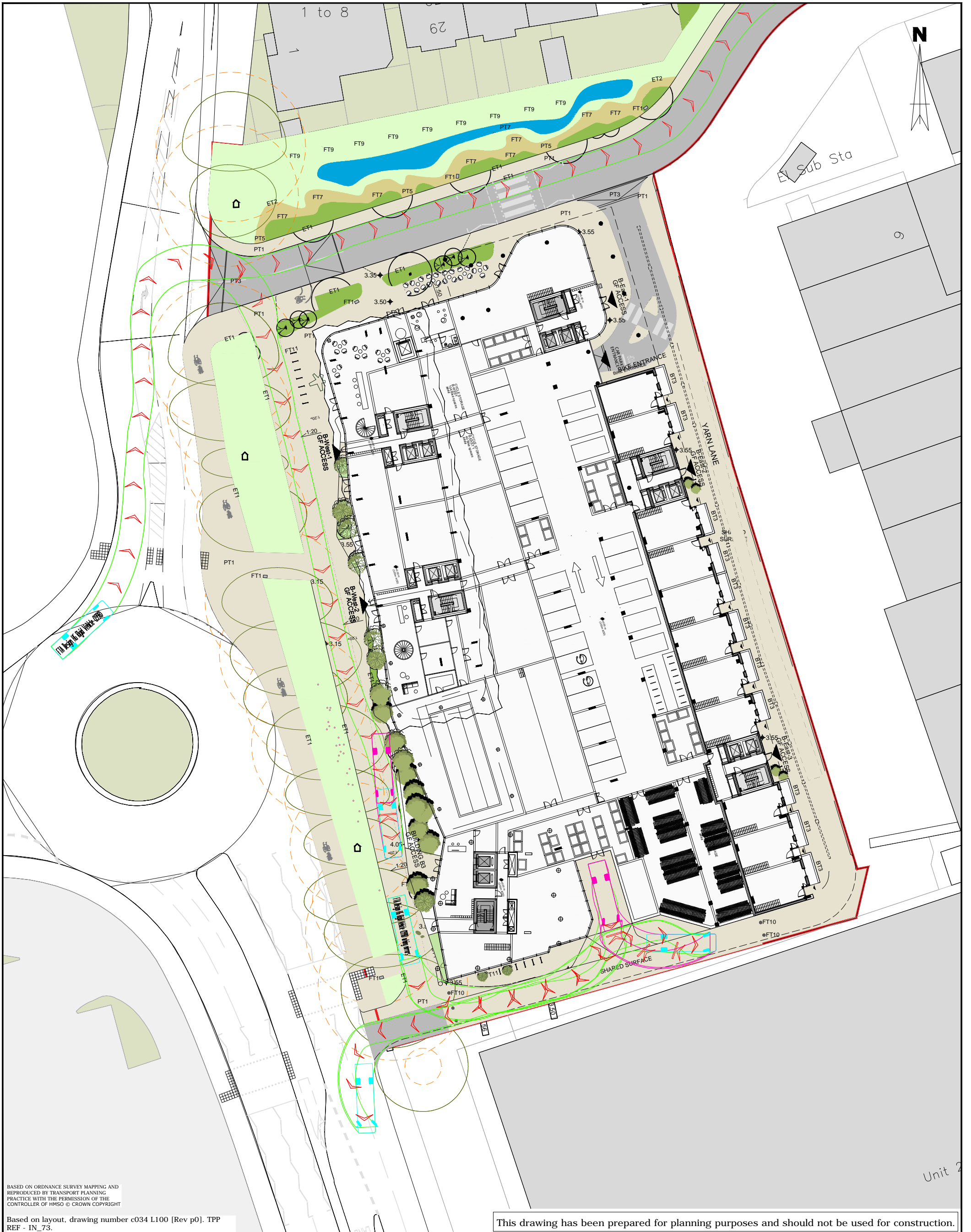

BASED ON ORDNANCE SURVEY MAPPING AND REPRODUCED BY TRANSPORT PLANNING PRACTICE WITH THE PERMISSION OF THE CONTROLLER OF HMSO © CROWN COPYRIGHT

Based on layout, drawing number c034 L100 [Rev p0]. TPP REF - IN_73.

This drawing has been prepared for planning purposes and should not be used for construction.

Vehicle used

FTA Design HG Rigid Vehicle (1998)

Overall Length	10.000m
Overall Width	2.500m
Overall Body Height	3.645m
Min Body Ground Clearance	0.440m
Track Width	2.470m
Lock to Lock Time	3.00s
Kerb to Kerb Turning Radius	11.000m

CHARLTON RIVERSIDE, GREENWICH

Plot B

Swept path analysis of 10.0m Rigid HGV

TRANSPORT PLANNING PRACTICE

70 Cowcross Street
London, EC1M 6EL

t: 020 7608 0008
w: www.tppweb.co.uk

SCALE @ A3	1:1000	DATE	29/11/16	DRAWN BY	LD	CHECKED	CW
------------	--------	------	----------	----------	----	---------	----

DRAWING NUMBER	30821/AC/120	REV	-
----------------	--------------	-----	---

T:\300000_Projects\30821 Charlton Riverside, Greenwich\ACAD\Interim scheme\119 - 122.dwg