

Sources of information

Simpson Haugh  
10046-Z0-G100-3-AL\_15.dwg  
Received 27/10/2016

Cloud10  
Charlton ROL-26-10-16-Meters.dwg  
Received 25/10/2016

Rockwell Residential  
22384\_OGL\_REV-1.dwg  
Received 24/10/2016

EB7 Ltd  
Site Photographs  
Ordnance Survey

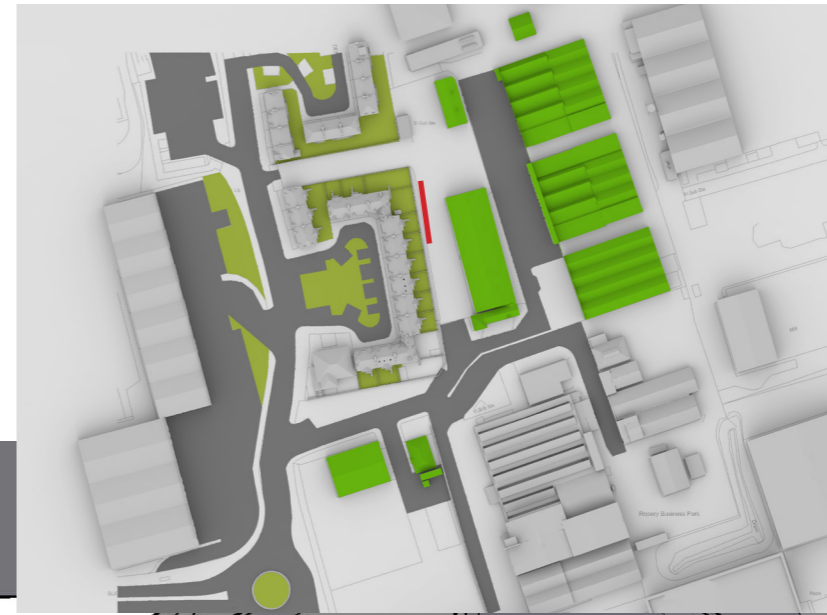

Project Charlton Riverside  
Greenwich  
London

Title 11-12, 13-14, 15-16 Atlas Gardens  
Window Map

Drawn AP Checked PS

Date 04/11/2016 Rel no. 17

Drawing no. 1864-WM15

Sources of information

Simpson Haugh  
10046-Z0-G100-3-AL\_15.dwg  
Received 27/10/2016

Cloud10  
Charlton ROL-26-10-16-Meters.dwg  
Received 25/10/2016

Rockwell Residential  
22384\_OGL\_REV-1.dwg  
Received 24/10/2016

EB7 Ltd  
Site Photographs  
Ordnance Survey

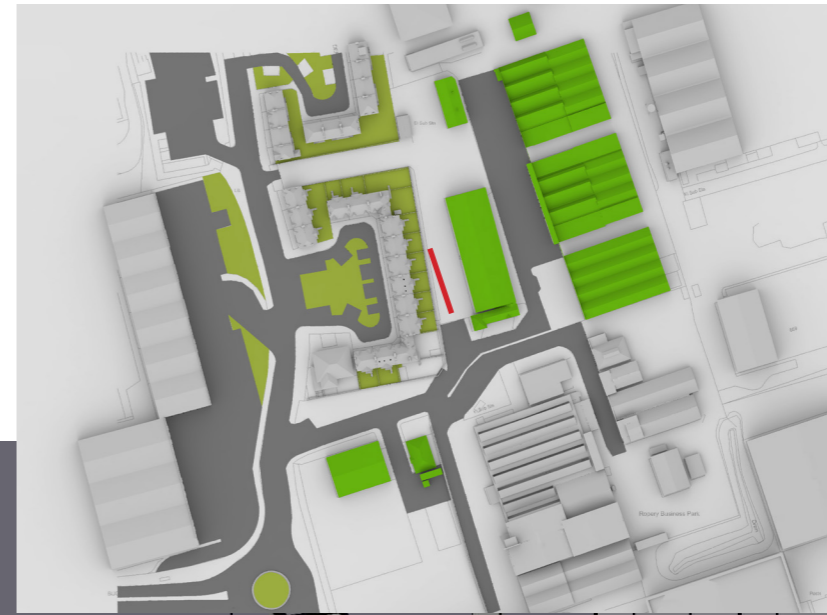

Project Charlton Riverside  
Greenwich  
London

Title 15-16, 17-18, 19-20 Atlas Gardens  
Window Map

Drawn AP Checked PS

Date 04/11/2016 Rel no. 17

Drawing no. 1864-WM16

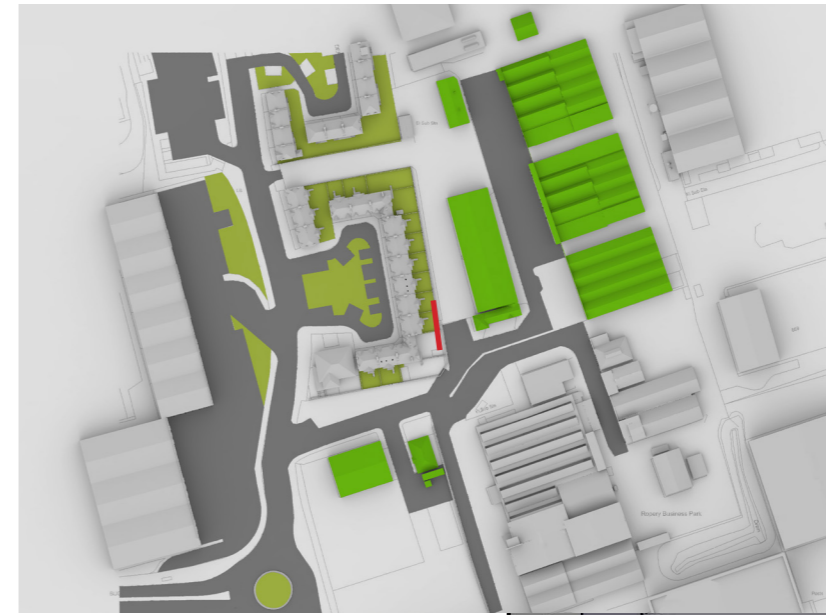

Sources of information

Simpson Haugh  
10046-Z0-G100-3-AL\_15.dwg  
Received 27/10/2016

Cloud10  
Charlton ROL-26-10-16-Meters.dwg  
Received 25/10/2016

Rockwell Residential  
22384\_OGL\_REV-1.dwg  
Received 24/10/2016

EB7 Ltd  
Site Photographs  
Ordnance Survey



Project Charlton Riverside  
Greenwich  
London

Title 21-22, 23-24, 25-26 Atlas Gardens  
Window Map

Drawn	AP	Checked	PS
-------	----	---------	----

Date	04/11/2016	Rel no.	17
------	------------	---------	----

Drawing no. 1864-WM17



Sources of information

Simpson Haugh  
 10046-Z0-G100-3-AL\_15.dwg  
 Received 27/10/2016

Cloud10  
 Charlton ROL-26-10-16-Meters.dwg  
 Received 25/10/2016

Rockwell Residential  
 22384\_OGL\_REV-1.dwg  
 Received 24/10/2016

EB7 Ltd  
 Site Photographs  
 Ordnance Survey

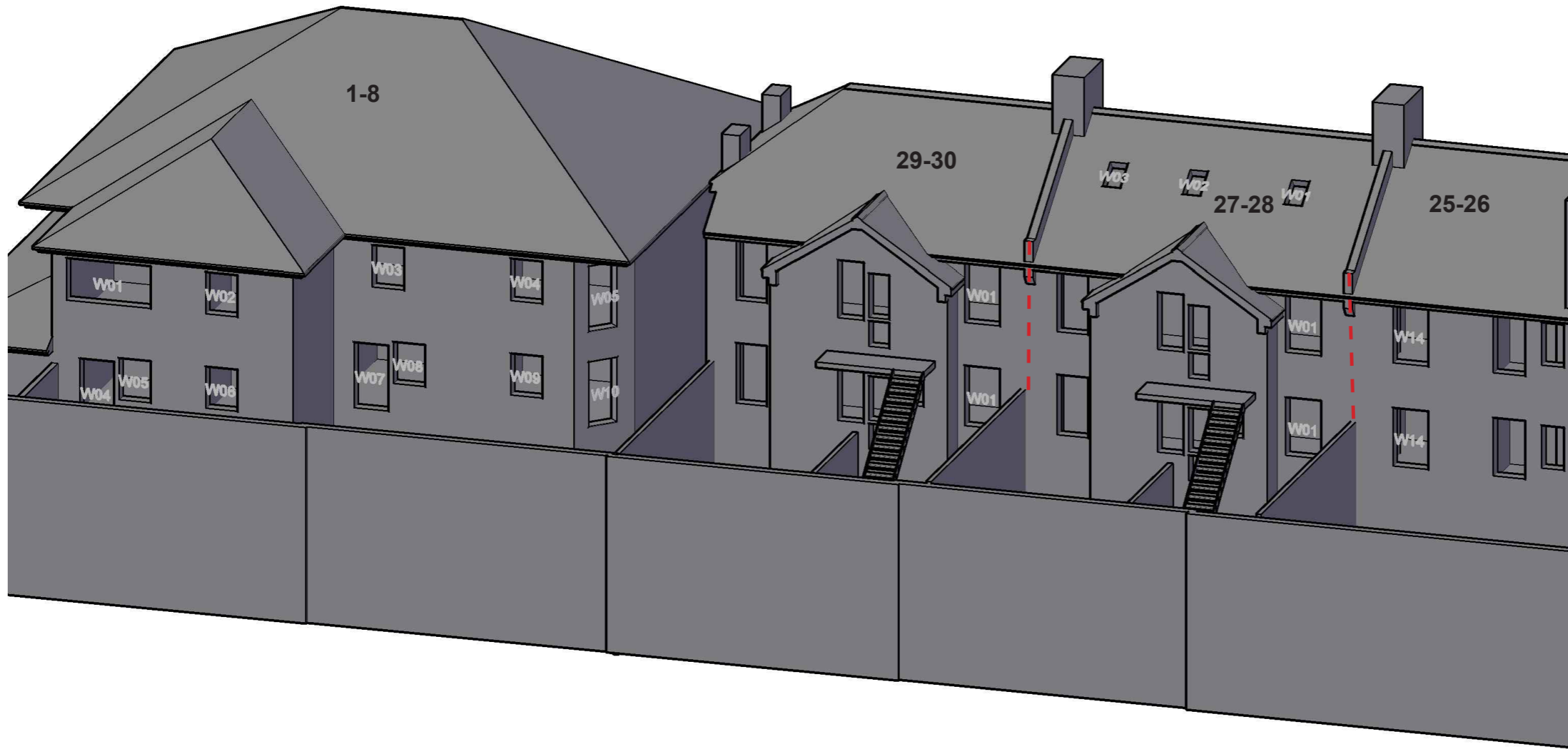

Project Charlton Riverside  
 Greenwich  
 London

Title 25-26, 27-28, 29-30 Atlas Gardens,  
 1-8 Anchor & Hope Ln  
 Window Map

Drawn AP Checked PS

Date 04/11/2016 Rel no. 17

Drawing no. 1864-WM18

Sources of information

Simpson Haugh  
10046-Z0-G100-3-AL\_15.dwg  
Received 27/10/2016

Cloud10  
Charlton ROL-26-10-16-Meters.dwg  
Received 25/10/2016

Rockwell Residential  
22384\_OGL\_REV-1.dwg  
Received 24/10/2016

EB7 Ltd  
Site Photographs  
Ordnance Survey



Project Charlton Riverside  
Greenwich  
London

Title 25-26 Atlas Gardens  
(Rear view)  
Window Map

Drawn	AP	Checked	PS
-------	----	---------	----

Date	04/11/2016	Rel no.	17
------	------------	---------	----

Drawing no. 1864-WM19



## Appendix 11.2

Detailed daylight (VSC, NSC and ADF) and sunlight (APSH) results - surrounding properties

Address	Room	Window	Room Use	Existing VSC	Proposed VSC	Loss	Loss %	Room Area	Existing NSC	Proposed NSC	Loss	Loss %	Existing ADF Window	Proposed ADF Window	Loss	Loss %	Existing APSH Total	Proposed APSH Total	Total Retained	Winter Retained		
<b>1-2 Atlas Gardens</b>																						
Ground	R1	W01-L W01-U	Bedroom	27.3	22.9	4.4	16.2	127.9	123.3	118.6	4.8	3.9	0.0	0.0	0.1	11.8	N/A	N/A	N/A	N/A	N/A	N/A
													1.2	1.2								
First	R1	W01-L W01-U	Bedroom	31.5	26.8	4.7	15.1	127.9	123.7	118.9	4.8	3.8	0.0	0.0	0.2	12.0	N/A	N/A	N/A	N/A	N/A	N/A
													1.3	1.3								
<b>3-4 Atlas Gardens</b>																						
Ground	R1	W01-L W01-U	Bedroom	23.5	20.6	2.9	12.4	138.6	124.7	117.6	7.1	5.7	0.0	0.0	0.1	8.4	N/A	N/A	N/A	N/A	N/A	N/A
													1.0	1.1								
First	R1	W01-L W01-U	Bedroom	30.1	26.5	3.6	12.0	138.6	133.6	129.4	4.2	3.1	0.0	0.0	0.1	9.6	N/A	N/A	N/A	N/A	N/A	N/A
													1.2	1.2								
<b>5-6 Atlas Gardens</b>																						
Ground	R1	W01-L W01-U	Bedroom	21.7	20.4	1.2	5.7	138.6	117.1	114.7	2.4	2.0	0.0	0.0	0.0	3.7	N/A	N/A	N/A	N/A	N/A	N/A
													1.0	1.0								
First	R1	W01-L W01-U	Bedroom	29.2	26.1	3.1	10.6	138.6	133.6	127.3	6.2	4.7	0.0	0.0	0.1	8.2	N/A	N/A	N/A	N/A	N/A	N/A
													1.2	1.2								
<b>7-8 Atlas Gardens</b>																						
Ground	R1	W01-L W01-U	Bedroom	25.5	25.5	0.0	0.0	138.6	131.7	131.7	0.0	0.0	0.0	0.0	0.0	0.0	N/A	N/A	N/A	N/A	N/A	N/A
													1.1	1.1								
First	R1	W01-L W01-U	Bedroom	30.0	30.0	0.0	0.0	138.6	133.3	133.3	0.0	0.0	0.0	0.0	0.0	0.0	N/A	N/A	N/A	N/A	N/A	N/A
													1.2	1.2								
<b>9-10 Atlas Gardens</b>																						
Ground	R1	W01-L W01-U	Bedroom	25.7	25.7	0.0	0.0	138.6	131.4	131.4	0.0	0.0	0.0	0.0	0.0	0.0	N/A	N/A	N/A	N/A	N/A	N/A
													1.1	1.1								
First	R1	W01-L W01-U	Bedroom	29.8	29.8	0.0	0.0	138.6	133.5	133.5	0.0	0.0	0.0	0.0	0.0	0.0	N/A	N/A	N/A	N/A	N/A	N/A
													1.2	1.2								
<b>11-12 Atlas Gardens</b>																						
Ground	R1	W01-L W01-U	Bedroom	34.6	31.2	3.4	9.8	135.8	131.9	131.6	0.3	0.2	0.0	0.0	0.1	7.4	N/A	N/A	N/A	N/A	N/A	N/A
													1.3	1.3								
Ground	R4 R4	W08 W09	Unknown	25.2	12.9	12.3	48.7						0.6	0.4			N/A	N/A	N/A	N/A	N/A	N/A
													1.6	1.0								

Address	Room	Window	Room Use	Existing VSC	Proposed VSC	Loss	Loss %	Room Area	Existing NSC	Proposed NSC	Loss	Loss %	Existing ADF Window	Existing ADF Total	Proposed ADF Window	Proposed ADF Total	Loss	Loss %	Existing APSH Total	Existing APSH Winter	Proposed APSH Total	Proposed APSH Winter	Total Retained	Winter Retained
	R4	W10		23.4	13.3	10.0	42.9	119.1	116.9	70.4	46.5	39.8	0.6	2.8	0.4	1.9	0.9	33.7	30	3	15	1	0.5	0.3
Ground	R5	W11-L W11-U	Bedroom	25.2	13.7	11.5	45.7						0.0		0.0				N/A	N/A	N/A	N/A	N/A	N/A
	R5	W12		7.6	7.6	0.0	0.0						0.2		0.2				N/A	N/A	N/A	N/A	N/A	N/A
	R5	W13		24.4	24.2	0.2	0.9						1.0		1.0				44	15	43	14	1.0	0.9
	R5	W14		26.6	26.3	0.3	1.1	154.4	154.4	154.1	0.3	0.2	0.5	2.8	0.5	2.4	0.4	13.5	43	14	43	14	1.0	1.0
First	R1	W01-L W01-U	Bedroom	35.2	31.9	3.3	9.4						0.0		0.0				N/A	N/A	N/A	N/A	N/A	N/A
								135.8	131.6	130.7	0.9	0.7	1.3	1.3	1.2	1.2	0.1	7.3						
First	R4	W08-L W08-U	Unknown	28.2	16.0	12.2	43.2						0.0		0.0				N/A	N/A	N/A	N/A	N/A	N/A
	R4	W09-L W09-U		36.7	21.1	15.6	42.5						0.6		0.4				N/A	N/A	N/A	N/A	N/A	N/A
	R4	W10-L W10-U		27.7	17.9	9.8	35.4						0.0		0.0				N/A	N/A	N/A	N/A	N/A	N/A
								119.1	117.8	75.7	42.1	35.7	0.0		0.0				40	6	27	3	0.7	0.5
													0.6	2.8	0.5	1.9	0.9	31.0						
First	R5	W11-L W11-U	Bedroom	29.1	16.9	12.2	42.0						0.0		0.0				N/A	N/A	N/A	N/A	N/A	N/A
													1.2		0.8				N/A	N/A	N/A	N/A	N/A	N/A
	R5	W12-L W12-U		13.1	13.1	0.0	0.0						0.0		0.0				N/A	N/A	N/A	N/A	N/A	N/A
													0.2		0.2									
	R5	W13-L W13-U		31.2	30.9	0.2	0.8						0.0		0.0				49	17	48	16	1.0	0.9
													1.1		1.1									
	R5	W14-L W14-U		28.4	28.1	0.3	1.1						0.0		0.0				47	15	47	15	1.0	1.0
								154.5	154.5	154.5	0.1	0.0	0.4	3.0	0.4	2.7	0.4	12.4						
<b>13-14 Atlas Gardens</b>																								
Ground	R1	W01-L W01-U	Bedroom	26.8	14.0	12.9	48.0						0.0		0.0				N/A	N/A	N/A	N/A	N/A	N/A
								138.6	131.4	71.1	60.4	45.9	1.1	1.1	0.7	0.7	0.4	34.9						
First	R1	W01-L W01-U	Bedroom	31.9	18.1	13.8	43.2						0.0		0.0				N/A	N/A	N/A	N/A	N/A	N/A
								138.6	133.5	91.0	42.5	31.9	1.3	1.3	0.9	0.9	0.4	33.4						
<b>15-16 Atlas Gardens</b>																								
Ground	R1	W01-L W01-U	Bedroom	26.0	14.6	11.4	43.8						0.0		0.0				N/A	N/A	N/A	N/A	N/A	N/A
								138.6	131.4	78.6	52.8	40.2	1.1	1.1	0.7	0.8	0.3	31.1						
First	R1	W01-L W01-U	Bedroom	31.1	18.9	12.2	39.1						0.0		0.0				N/A	N/A	N/A	N/A	N/A	N/A
								138.6	133.7	102.2	31.5	23.5	1.3	1.3	0.9	0.9	0.4	29.7						
<b>17-18 Atlas Gardens</b>																								
Ground	R1	W01-L W01-U	Bedroom	25.9	15.0	11.0	42.3						0.0		0.0				N/A	N/A	N/A	N/A	N/A	N/A
								138.6	131.4	82.2	49.2	37.4	1.1	1.1	0.8	0.8	0.3	29.8						
First	R1	W01-L	Bedroom	31.2	19.4	11.8	37.8						0.0		0.0				N/A	N/A	N/A	N/A	N/A	N/A

Address	Room	Window	Room Use	Existing VSC	Proposed VSC	Loss	Loss %	Room Area	Existing NSC	Proposed NSC	Loss	Loss %	Existing ADF Window	Proposed ADF Window	Loss	Loss %	Existing APSH Total	Proposed APSH Total	Total Retained	Winter Retained		
		W01-U						138.6	133.6	107.9	25.7	19.3	1.3	1.3	0.9	0.9	0.4	28.8				
<b>19-20 Atlas Gardens</b>																						
Ground	R1	W01-L W01-U	Bedroom	26.3	14.0	12.3	46.8	138.6	131.6	67.0	64.6	49.1	0.0	0.0				N/A	N/A	N/A	N/A	
								138.6	133.6	81.7	51.9	38.9	1.1	1.1	0.7	0.7	0.4	33.3				
First	R1	W01-L W01-U	Bedroom	31.6	18.5	13.0	41.3	138.6	133.6	81.7	51.9	38.9	0.0	0.0				N/A	N/A	N/A	N/A	
								138.6	133.6	81.7	51.9	38.9	1.3	1.3	0.9	0.9	0.4	31.4				
Second	R1	W01	Unknown	39.0	26.6	12.5	31.9	138.6	115.3	111.9	3.3	2.9	0.5	0.5	0.3	0.3	0.1	27.7	N/A	N/A	N/A	
Second	R2	W02	Unknown	39.0	26.8	12.2	31.3	86.3	70.9	70.9	0.0	0.0	0.6	0.6	0.5	0.5	0.2	27.2	N/A	N/A	N/A	
Second	R3	W03	Unknown	39.0	27.0	12.0	30.7	67.4	52.3	52.3	0.0	0.0	0.8	0.8	0.6	0.6	0.2	26.8	N/A	N/A	N/A	
<b>21-22 Atlas Gardens</b>																						
Ground	R1	W01-L W01-U	Bedroom	26.2	14.2	11.9	45.6	138.6	131.0	66.2	64.8	49.5	0.0	0.0				N/A	N/A	N/A	N/A	
								138.6	131.0	66.2	64.8	49.5	1.1	1.1	0.8	0.8	0.4	32.1				
First	R1	W01-L W01-U	Bedroom	31.5	19.3	12.2	38.6	138.6	133.3	86.3	47.0	35.2	0.0	0.0				N/A	N/A	N/A	N/A	
								138.6	133.3	86.3	47.0	35.2	1.3	1.3	0.9	0.9	0.4	29.5				
<b>23-24 Atlas Gardens</b>																						
Ground	R1	W01-L W01-U	Bedroom	26.2	15.1	11.2	42.6	138.6	131.0	69.4	61.6	47.0	0.0	0.0				N/A	N/A	N/A	N/A	
								138.6	131.0	69.4	61.6	47.0	1.1	1.1	0.8	0.8	0.3	30.2				
First	R1	W01-L W01-U	Bedroom	31.6	20.1	11.5	36.4	138.6	133.2	93.9	39.2	29.5	0.0	0.0				N/A	N/A	N/A	N/A	
								138.6	133.2	93.9	39.2	29.5	1.3	1.3	1.0	1.0	0.4	27.7				
<b>25-26 Atlas Gardens</b>																						
Ground	R1	W01-L W01-U	Bedroom	26.3	21.4	4.9	18.7						0.0	0.0				N/A	N/A	N/A	N/A	
													1.1	1.0				N/A	N/A	N/A	N/A	
	R1	W02		27.2	27.2	0.0	0.0						0.6	0.6				N/A	N/A	N/A	N/A	
	R1	W03		24.6	24.6	0.0	0.0						1.0	1.0				14	0	14	0	
	R1	W04		7.8	7.8	0.0	0.0	155.7	155.7	155.7	0.0	0.0	0.2	2.9	0.2	2.7	0.1	5.1	12	0	12	0
Ground	R2	W05	Unknown	23.4	16.4	7.0	29.8						0.6	0.5				N/A	N/A	N/A	N/A	
	R2	W06		34.6	27.7	6.9	19.9						1.6	1.3				N/A	N/A	N/A	N/A	
	R2	W07		25.7	23.4	2.2	8.7	119.1	116.9	105.5	11.4	9.7	0.6	2.8	0.6	2.4	0.4	14.4	31	3	29	3
Ground	R5	W14-L W14-U	Bedroom	35.6	27.3	8.3	23.4						0.0	0.0				82	27	69	14	
								135.8	131.6	96.6	35.0	26.6	1.4	1.4	1.1	1.1	0.3	19.5				
First	R1	W01-L W01-U	Bedroom	29.0	23.8	5.2	18.0						0.0	0.0				N/A	N/A	N/A	N/A	
													1.3	1.1								

Address	Room	Window	Room Use	Existing	Proposed	Loss	Loss %	Room Area	Existing	Proposed	Loss	Loss %	Existing ADF		Proposed ADF		Loss	Loss %	Existing APSH		Proposed APSH		Total Retained	Winter Retained	
				VSC	VSC				NSC	NSC			Window	Total	Window	Total			Total	Winter	Total	Winter			
	R1	W02-L		29.2	29.2	0.0	0.0							0.0	0.0					N/A	N/A	N/A	N/A	N/A	N/A
		W02-U												0.5	0.5										
	R1	W03-L		31.3	31.3	0.0	0.0							0.0	0.0					36	2	36	2	1.0	1.0
		W03-U												1.1	1.1										
	R1	W04-L		13.2	13.2	0.0	0.0							0.0	0.0					21	0	21	0	1.0	0.0
		W04-U						155.7	155.7	155.7	0.0	0.0		0.2	3.2	0.2	3.0	0.2	5.2						
First	R2	W05-L	Unknown	27.6	20.3	7.3	26.4							0.0	0.0					N/A	N/A	N/A	N/A	N/A	N/A
		W05-U												0.6	0.5										
	R2	W06-L		36.7	29.6	7.0	19.2							0.0	0.0					N/A	N/A	N/A	N/A	N/A	N/A
		W06-U												1.6	1.3										
	R2	W07-L		28.7	26.4	2.3	8.1							0.0	0.0					38	6	35	6	0.9	1.0
		W07-U						119.1	118.0	109.5	8.5	7.2		0.6	2.9	0.6	2.4	0.4	14.3						
First	R5	W14-L	Bedroom	35.7	27.6	8.1	22.8							0.0	0.0					81	28	70	17	0.9	0.6
		W14-U						135.8	131.6	102.2	29.4	22.3		1.3	1.3	1.1	1.1	0.3	19.2						
<b>27-28 Atlas Gardens</b>																									
Ground	R1	W01	Bedroom	27.8	20.4	7.4	26.6	138.6	131.7	106.6	25.2	19.1		1.2	1.2	1.0	1.0	0.2	18.7	59	18	48	7	0.8	0.4
First	R1	W01	Bedroom	31.9	24.2	7.6	24.0	138.6	133.6	113.7	19.9	14.9		1.3	1.3	1.1	1.1	0.2	18.3	72	22	62	12	0.9	0.5
Second	R2	W01	Unknown	38.7	30.9	7.8	20.2	107.4	83.5	82.9	0.6	0.7		0.5	0.5	0.4	0.4	0.1	18.5	89	30	80	21	0.9	0.7
Second	R3	W02	Unknown	38.8	30.6	8.2	21.1	49.3	36.5	36.5	0.0	0.0		0.9	0.9	0.7	0.7	0.2	19.2	89	30	79	20	0.9	0.7
Second	R4	W03	Unknown	38.7	30.3	8.4	21.6	44.8	34.1	34.1	0.0	0.0		0.9	0.9	0.8	0.8	0.2	19.6	88	29	78	19	0.9	0.7
<b>29-30 Atlas Gardens</b>																									
Ground	R1	W01-L	Bedroom	26.5	17.5	8.9	33.7							0.0	0.0					56	17	44	5	0.8	0.3
		W01-U						138.6	131.3	95.8	35.5	27.0		1.2	1.2	0.9	0.9	0.3	23.9						
First	R1	W01-L	Bedroom	31.2	21.9	9.3	29.9							0.0	0.0					71	22	57	8	0.8	0.4
		W01-U						138.6	133.4	107.4	26.1	19.5		1.3	1.3	1.0	1.0	0.3	22.5						
<b>21-22 Derrick Gardens</b>																									
Ground	R1	W01-L	Bedroom	33.6	24.9	8.7	25.9							0.0	0.0					N/A	N/A	N/A	N/A	N/A	N/A
		W01-U						85.4	82.8	68.5	14.3	17.2		1.9	1.9	1.5	1.5	0.4	20.5						
First	R1	W01-L	Bedroom	35.0	26.0	9.0	25.6							0.0	0.0					N/A	N/A	N/A	N/A	N/A	N/A
		W01-U						85.4	82.8	68.9	13.9	16.8		1.8	1.8	1.4	1.5	0.4	21.1						
Second	R1	W01	Unknown	34.1	25.1	9.0	26.5	77.5	69.6	64.8	4.8	7.0		1.5	1.5	1.2	1.2	0.3	22.0	N/A	N/A	N/A	N/A	N/A	N/A
<b>23-24 Derrick Gardens</b>																									

Address	Room	Window	Room Use	Existing	Proposed	Loss	Loss %	Room Area	Existing	Proposed	Loss	Loss %	Existing ADF		Proposed ADF		Loss	Loss %	Existing APSH		Proposed APSH		Total Retained	Winter Retained		
				VSC	VSC				NSC	NSC			Window	Total	Window	Total			Total	Winter	Total	Winter				
Ground	R3	W05-L W05-U	Bedroom	35.0	24.0	11.0	31.4	85.4	82.2	78.4	3.8	4.6	0.0		0.0					N/A	N/A	N/A	N/A	N/A	N/A	
									1.9	1.9	1.4	1.5	0.5	25.2												
First	R3	W05-L W05-U	Bedroom	35.6	24.4	11.3	31.6	85.4	82.2	78.4	3.8	4.6	0.0		0.0						N/A	N/A	N/A	N/A	N/A	N/A
									1.9	1.9	1.4	1.4	0.5	26.0												
<b>25-26 Derrick Gardens</b>																										
Ground	R1	W01-L W01-U	Bedroom	35.2	23.5	11.7	33.3	85.4	82.6	56.6	26.0	31.5	0.0		0.0						N/A	N/A	N/A	N/A	N/A	N/A
									1.9	2.0	1.4	1.4	0.5	26.8												
First	R1	W01-L W01-U	Bedroom	35.7	23.7	12.0	33.6	85.4	82.6	57.5	25.1	30.4	0.0		0.0						N/A	N/A	N/A	N/A	N/A	N/A
									1.9	1.9	1.4	1.4	0.5	27.7												
<b>27-28 Derrick Gardens</b>																										
Ground	R3	W05-L W05-U	Bedroom	35.1	22.0	13.1	37.3	85.4	82.5	62.8	19.7	23.8	0.0		0.0						N/A	N/A	N/A	N/A	N/A	N/A
									1.9	1.9	1.4	1.4	0.6	29.7												
First	R3	W05-L W05-U	Bedroom	35.7	21.9	13.9	38.9	85.4	82.5	63.0	19.5	23.7	0.0		0.0						N/A	N/A	N/A	N/A	N/A	N/A
									1.9	1.9	1.3	1.3	0.6	31.8												
<b>29-30 Derrick Gardens</b>																										
Ground	R1	W01-L W01-U	Bedroom	34.3	30.7	3.6	10.4	136.3	129.9	129.9	0.1	0.1	0.0		0.0						83	26	73	23	0.9	0.9
									1.3	1.3	1.2	1.2	0.1	7.9												
First	R1	W01-L W01-U	Bedroom	34.7	30.9	3.8	10.8	136.3	129.9	129.8	0.1	0.1	0.0		0.0						85	30	76	26	0.9	0.9
									1.3	1.3	1.2	1.2	0.1	8.5												
<b>31-32 Derrick Gardens</b>																										
Ground	R3	W05-L W05-U	Bedroom	33.3	31.2	2.0	6.1	136.3	129.6	129.6	0.0	0.0	0.0		0.0						80	27	76	24	1.0	0.9
									1.3	1.3	1.2	1.2	0.1	4.7												
First	R3	W05-L W05-U	Bedroom	34.4	31.8	2.7	7.7	136.3	129.6	129.6	0.0	0.0	0.0		0.0						82	29	79	26	1.0	0.9
									1.3	1.3	1.2	1.2	0.1	6.2												
<b>33-34 Derrick Gardens</b>																										
Ground	R3	W05-L W05-U	Bedroom	32.9	31.0	1.9	5.7	136.3	129.3	129.3	0.0	0.0	0.0		0.0						80	26	76	23	1.0	0.9
									1.3	1.3	1.2	1.2	0.1	4.6												
First	R3	W05-L W05-U	Bedroom	34.1	31.6	2.4	7.1	136.3	129.2	129.2	0.0	0.0	0.0		0.0						80	27	75	23	0.9	0.9
									1.3	1.3	1.2	1.2	0.1	5.7												
<b>35-36 Derrick Gardens</b>																										
Ground	R1	W01-L	Bedroom	33.5	30.1	3.4	10.2						0.0		0.0					N/A	N/A	N/A	N/A	N/A	N/A	



Address	Room	Window	Room Use	Existing VSC	Proposed VSC	Loss	Loss %	Room Area	Existing NSC	Proposed NSC	Loss	Loss %	Existing ADF Window	Proposed ADF Window	Loss	Loss %	Existing APSH Total	Proposed APSH Total	Existing APSH Winter	Proposed APSH Winter	Total Retained	Winter Retained		
	R6	W08		28.1	19.5	8.7	30.7	181.4	171.7	168.6	3.1	1.8	0.7	1.3	0.5	1.0	0.3	24.2	59	20	47	9	0.8	0.5
Ground	R7	W09	Unknown	34.6	25.2	9.4	27.0						0.8		0.6				80	26	64	11	0.8	0.4
	R7	W10-L W10-U		28.2	20.7	7.5	26.6	172.4	169.6	154.6	15.0	8.9	0.1		0.0				61	21	45	5	0.7	0.2
First	R1	W01	Unknown	32.8	23.9	8.9	27.1	149.1	148.0	139.6	8.4	5.7	2.2	2.2	1.7	1.7	0.5	21.7	80	30	65	15	0.8	0.5
First	R2	W02	Unknown	32.7	23.2	9.5	29.0	134.2	130.5	107.1	23.4	17.9	0.9	0.9	0.7	0.7	0.2	23.3	82	30	69	17	0.8	0.6
First	R3	W03	Unknown	27.4	18.9	8.5	31.2	181.4	169.2	141.8	27.4	16.2	0.6	0.6	0.5	0.5	0.1	23.7	66	21	55	10	0.8	0.5
First	R4	W04	Unknown	32.4	23.1	9.3	28.7						0.7		0.6				78	27	66	15	0.8	0.6
	R4	W05-L W05-U		26.4	18.6	7.8	29.7	172.4	172.3	156.9	15.4	8.9	0.1		0.1				53	23	39	9	0.7	0.4
													0.5	1.4	0.4	1.0	0.3	23.9						



Appendix 11.3  
Sunlight amenity assessment

**YES**  
 BRE's Sun On Ground  
 Area seeing at least two  
 hours of sunlight

**NO**  
 Day: 21st March  
 Latitude: 51.4°N  
 Effective day length: 10 hours  
 \*Min solar angle 10°  
 (BR209 3.3.8)

**Title**  
 Overshadowing Assessments  
 External Areas



Fig. 1: BRE's Sun On Ground - Existing Scenario



Fig. 2: BRE's Sun On Ground - Proposed Scenario

Zone Name	Area (m2)	Sunlit Area*		
		Existing [%]	Proposed [%]	Loss [%]
A01	99.7	68.1	65.5	3.8
A02	34.6	75.0	63.6	15.2
A03	35.2	74.9	66.6	11.1
A04	35.3	73.6	67.4	8.4
A05	38.5	75.2	73.0	3.0
A06	178.1	82.9	82.5	0.4
A07	143.3	85.0	85.0	0.0
A08	35.2	46.5	46.5	0.0
A09	39.5	70.0	63.7	8.9
A10	34.0	43.8	43.8	0.0
A11	39.2	73.3	60.3	17.7
A12	33.6	39.6	39.6	0.0
A13	38.9	69.3	58.1	16.2
A14	33.4	38.9	38.9	0.0
A15	38.7	67.0	54.5	18.7
A16	33.6	38.3	38.3	0.0
A17	38.5	66.0	50.9	22.9
A18	32.6	34.8	34.8	0.0
A19	38.1	66.5	53.6	19.5
A20	129.3	75.7	67.1	11.4
A21	179.2	54.9	49.1	10.5
A22	38.8	20.2	20.2	0.0
A23	50.3	16.5	16.5	0.0
A24	20.4	20.2	20.2	0.0
A25	39.0	20.2	20.2	0.0
A26	52.1	60.0	60.0	0.0
A27	50.0	58.1	58.1	0.0
A28	174.6	68.0	68.0	0.0
A29	149.9	73.3	67.2	8.3
A30	32.0	41.8	36.8	11.8
A31	32.0	41.2	34.6	16.0
A32	29.1	42.6	38.9	8.6
A33	30.4	40.7	40.7	0.0
A34	33.0	43.7	37.6	13.8
A35	33.3	44.0	39.3	10.6
A36	30.1	49.1	49.1	0.0
A37	557.2	100.0	100.0	0.0
A38	486.9	100.0	100.0	0.0

\*Sunlit Area = Area receiving >2hrs. of sunlight on 21st March

Table 1: Results



Project Charlton Riverside  
 Greenwich

Reference 1864\_SA01ext

Drawn VL Checked -

Date 1/11/2016 Rel no. 01

Drawing no. 1864\_SA01ext-1

**YES**  
 BRE's Sun On Ground  
 Area seeing at least two  
 hours of sunlight

**NO**  
 Day: 21st March  
 Latitude: 51.4°N  
 Effective day length: 10 hours  
 \*Min solar angle 10°  
 (BR209 3.3.8)

Zone Name	Area (m <sup>2</sup> )	Proposed [%]
A1	6,593.3	71.9
A2	136.1	10.7
A3	689.1	73.7
A4	874.9	68.8
R1	458.9	94.5
R2	311.4	90.2
R3	324.4	100.0
R4	318.3	100.0
R5	320.0	100.0
R6	588.5	96.7
R7	588.5	96.7
R8	67.8	86.5
R9	54.9	79.7
R10	60.3	79.5
R11	139.3	94.2
R12	143.1	94.0
R13	46.2	80.7
R14	620.8	97.0
R15	301.2	63.1
R16	602.9	90.0
R17	555.9	97.6

\*Sunlit Area = Area receiving at least 2hrs. of sunlight on 21st March

Table 1: Results

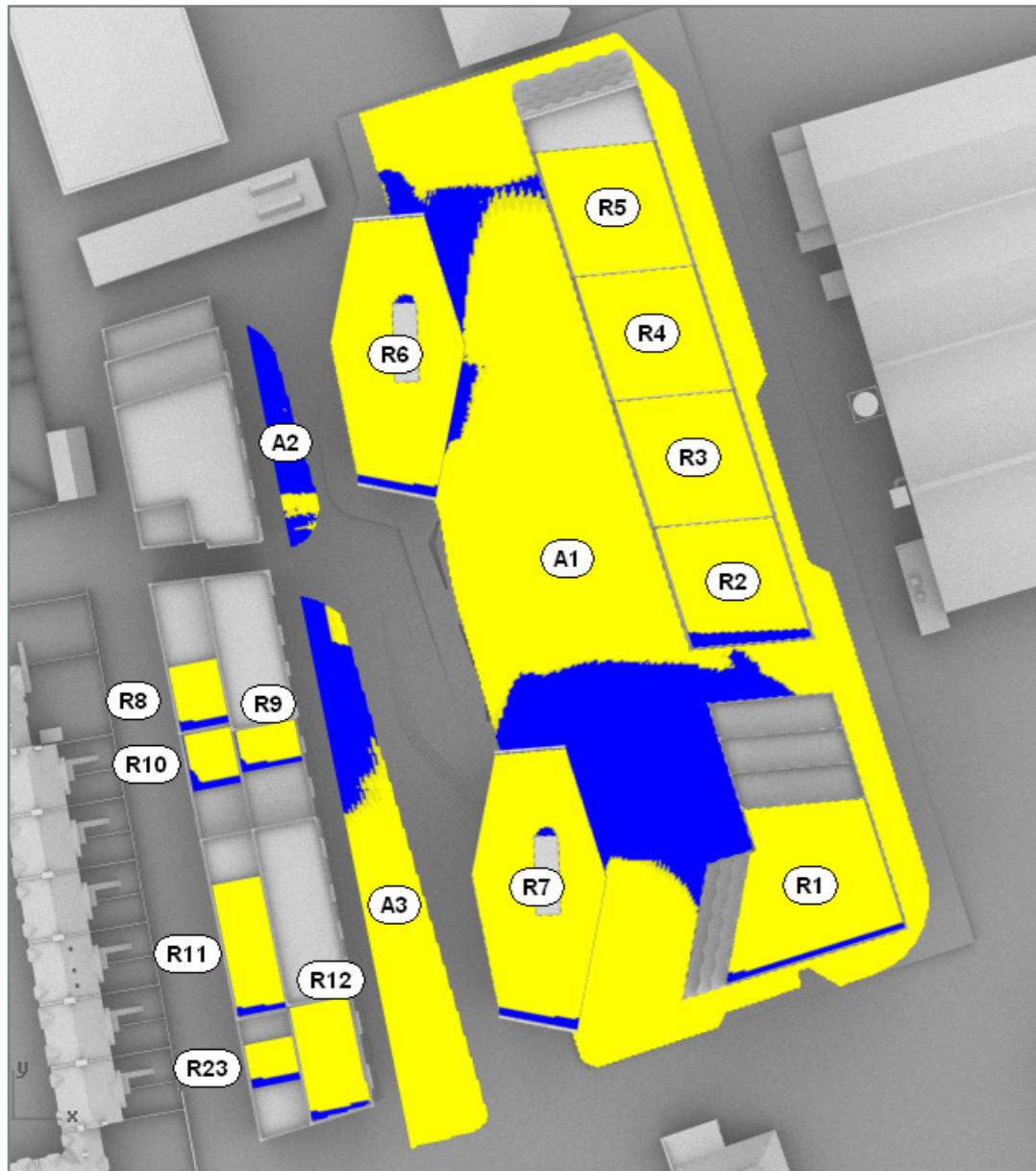

Fig. 1: BRE's Sun On Ground - Proposed Scenario - North Site

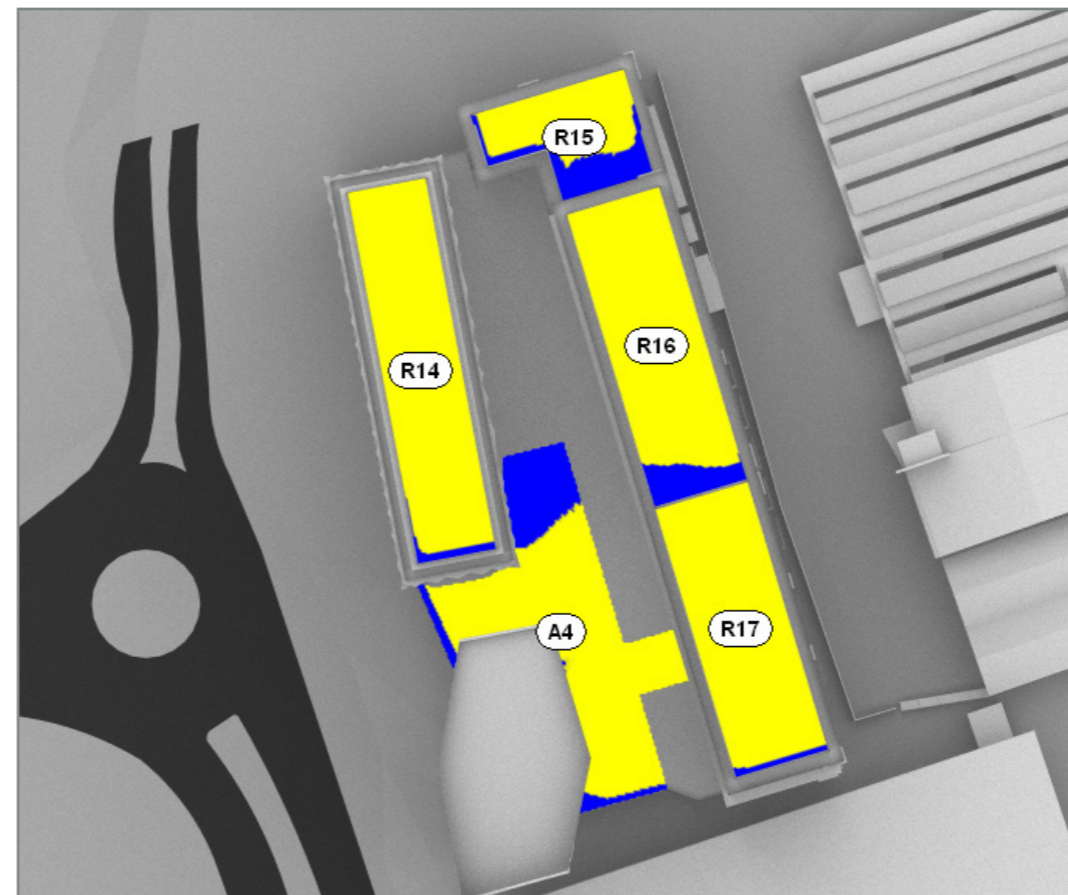

Fig. 2: BRE's Sun On Ground - Proposed Scenario - South Site

**Title**  
 Overshadowing Assessments  
 Internal Areas



Project Charlton Riverside  
 Greenwich

Reference 1864\_SA01int

Drawn VL Checked -

Date 1/11/2016 Rel no. 01

Drawing no. 1864\_SA01int-1



## Appendix 11.4

Transient overshadowing assessment

Existing Scenario

Proposed Scenario

8:00GMT

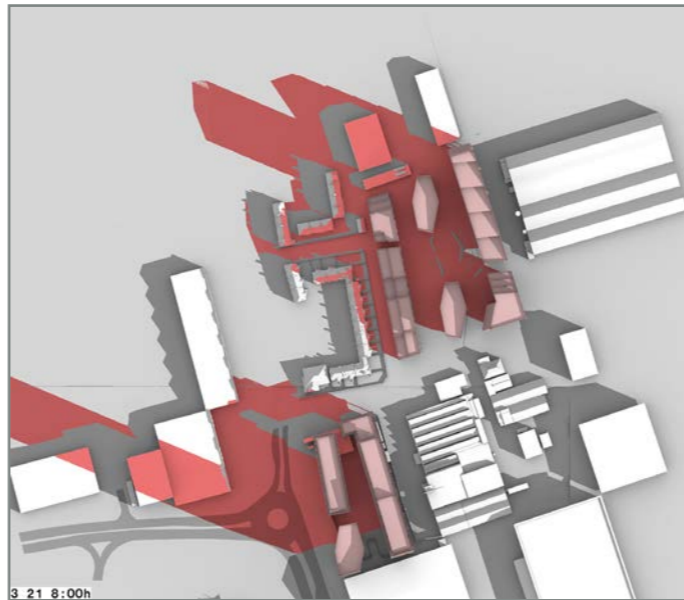
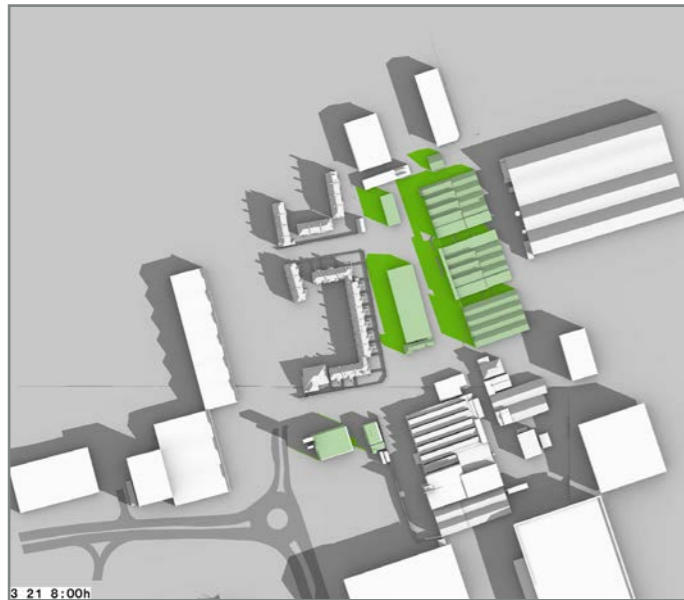

Title

Transient Overshadowing  
 Hourly Shadows  
 21st March

9:00GMT

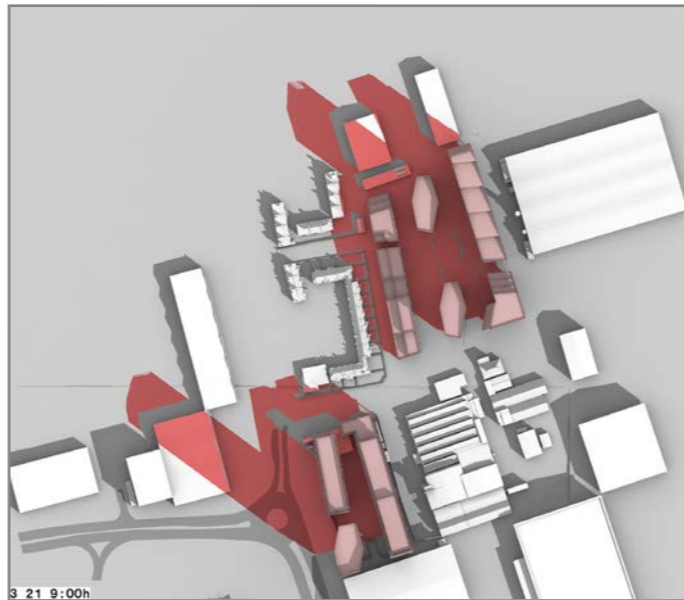

10:00GMT



Existing

Proposed

NORTH

Latitude: 51.4N  
 Min. solar altitude 10 degrees  
 (BR209 3.3.8)

Project Charlton Riverside  
 Greenwich

Reference 1864\_TS01

Drawn VL Checked JB

Date 2/11/2016 Rel no. 01

Drawing no. 1864\_TS01-5

Existing Scenario

Proposed Scenario

11:00GMT

Title

Transient Overshadowing  
 Hourly Shadows  
 21st March



12:00GMT



13:00GMT



Existing

Proposed

NORTH

Latitude: 51.4N  
 Min. solar altitude 10 degrees  
 (BR209 3.3.8)

Project Charlton Riverside  
 Greenwich

Reference 1864\_TS01

Drawn VL Checked JB

Date 2/11/2016 Rel no. 01

Drawing no. 1864\_TS01-6

Existing Scenario



Proposed Scenario

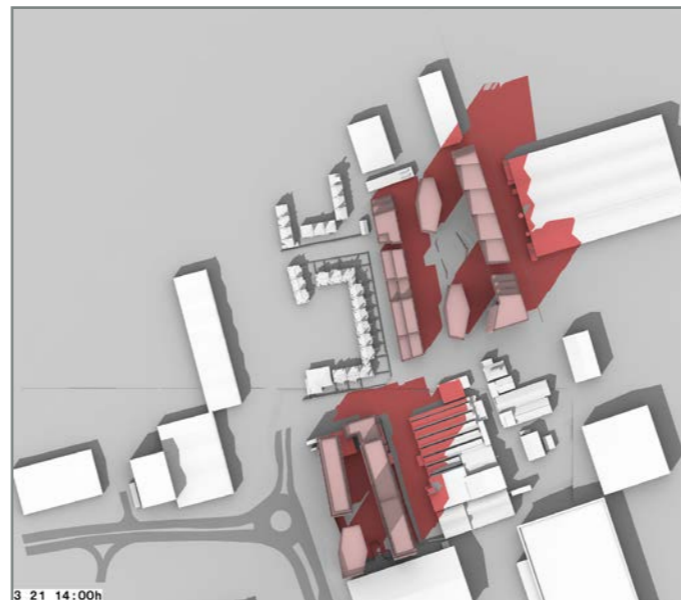

14:00GMT

15:00GMT

16:00GMT

Title

Transient Overshadowing  
 Hourly Shadows  
 21st March

Existing

Proposed

NORTH

Latitude: 51.4N  
 Min. solar altitude 10 degrees  
 (BR209 3.3.8)

Project Charlton Riverside  
 Greenwich

Reference 1864\_TS01

Drawn VL Checked JB

Date 2/11/2016 Rel no. 01

Drawing no. 1864\_TS01-7

17:00GMT

Existing Scenario



Proposed Scenario

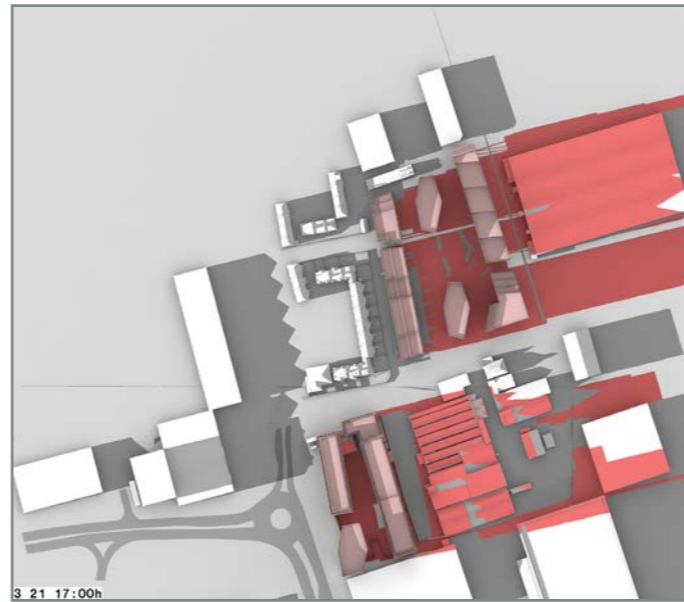

**Title**

Transient Overshadowing  
Hourly Shadows  
21st March

 Existing

 Proposed

**NORTH**

 Latitude: 51.4N  
Min. solar altitude 10 degrees  
(BR209 3.3.8)

Project Charlton Riverside  
Greenwich

Reference 1864\_TS01

Drawn VL Checked JB

Date 2/11/2016 Rel no. 01

Drawing no. 1864\_TS01-8

Existing Scenario

Proposed Scenario

6:00GMT

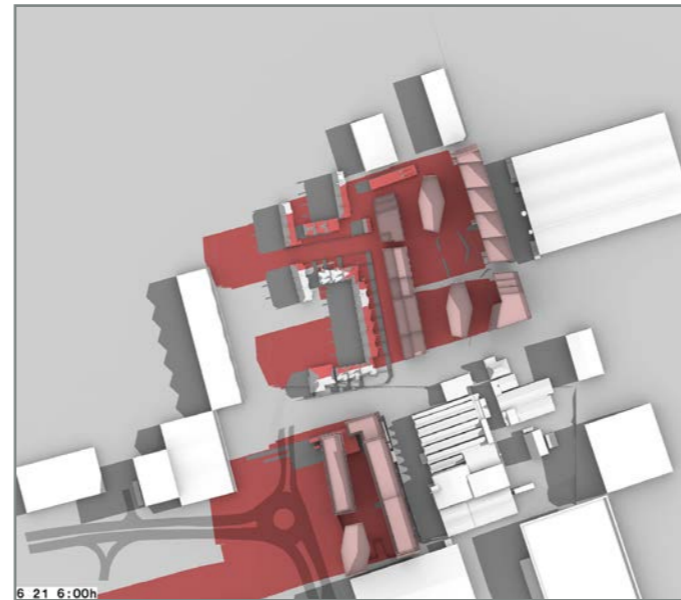

7:00GMT

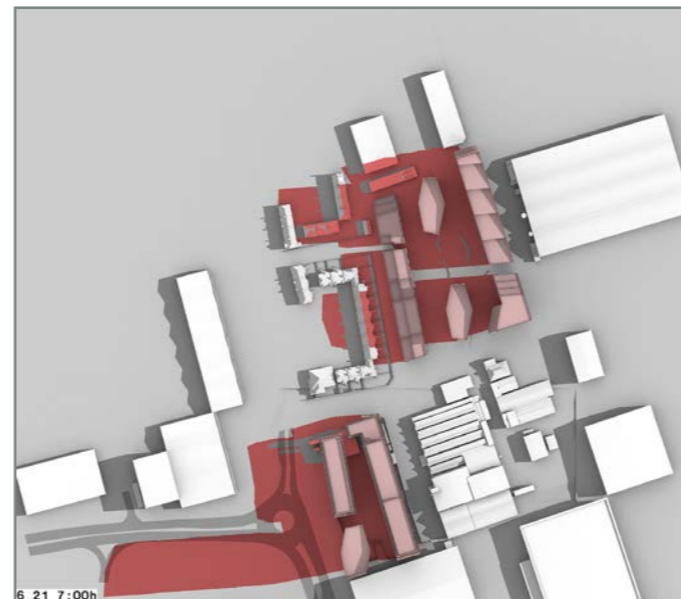

8:00GMT



Title

Transient Overshadowing  
Hourly Shadows  
21st June

Existing

Proposed

NORTH

Latitude: 51.4N  
Min. solar altitude 10 degrees  
(BR209 3.3.8)

Project Charlton Riverside  
Greenwich

Reference 1864\_TS01

Drawn VL Checked JB

Date 2/11/2016 Rel no. 01

Drawing no. 1864\_TS01-9

Existing Scenario

Proposed Scenario

9:00GMT



10:00GMT



11:00GMT

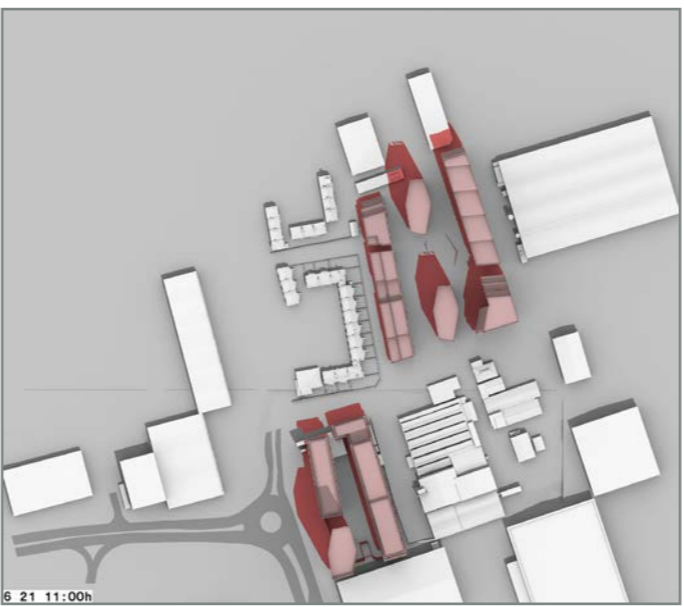

**Title**  
 Transient Overshadowing  
 Hourly Shadows  
 21st June

Existing

Proposed

**NORTH**  
  
 Latitude: 51.4N  
 Min. solar altitude 10 degrees  
 (BR209 3.3.8)

Project Charlton Riverside  
 Greenwich

Reference 1864\_TS01

Drawn VL Checked JB

Date 2/11/2016 Rel no. 01

Drawing no. 1864\_TS01-10

Existing Scenario



Proposed Scenario



12:00GMT

Title

Transient Overshadowing  
Hourly Shadows  
21st June



13:00GMT



14:00GMT

Existing

Proposed

NORTH

Latitude: 51.4N  
Min. solar altitude 10 degrees  
(BR209 3.3.8)

Project Charlton Riverside  
Greenwich

Reference 1864\_TS01

Drawn VL Checked JB

Date 2/11/2016 Rel no. 01

Drawing no. 1864\_TS01-11

Existing Scenario

Proposed Scenario

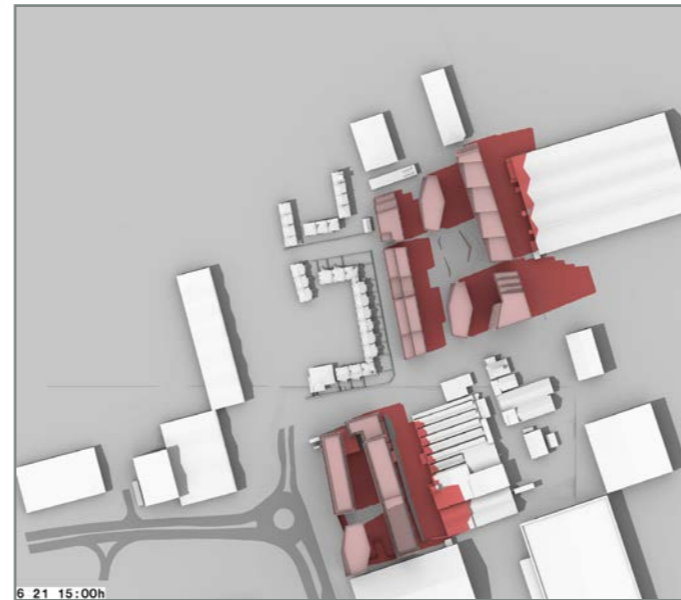

15:00GMT



Title

Transient Overshadowing  
 Hourly Shadows  
 21st June



16:00GMT

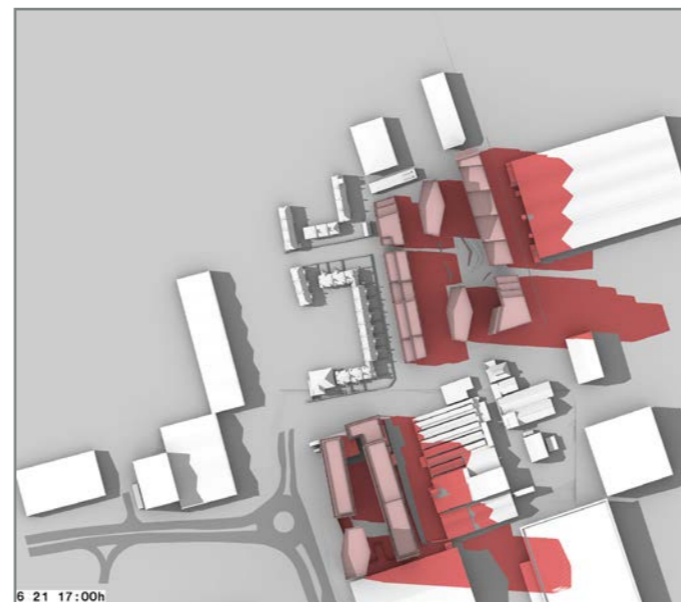

17:00GMT

Existing

Proposed

NORTH

Latitude: 51.4N  
 Min. solar altitude 10 degrees  
 (BR209 3.3.8)

Project Charlton Riverside  
 Greenwich

Reference 1864\_TS01

Drawn VL Checked JB

Date 2/11/2016 Rel no. 01

Drawing no. 1864\_TS01-12

18:00GMT

Existing Scenario



Proposed Scenario

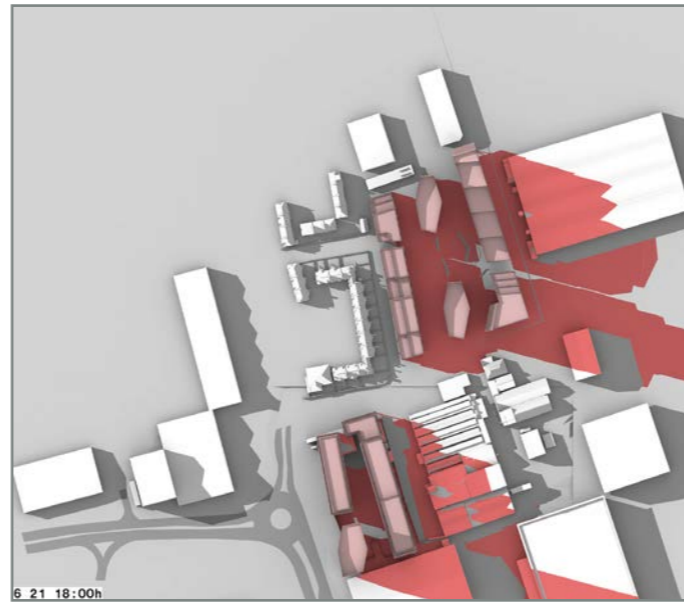

Title

Transient Overshadowing  
Hourly Shadows  
21st June

 Existing

 Proposed

NORTH

 Latitude: 51.4N  
Min. solar altitude 10 degrees  
(BR209 3.3.8)

Project Charlton Riverside  
Greenwich

Reference 1864\_TS01

Drawn VL Checked JB

Date 2/11/2016 Rel no. 01

Drawing no. 1864\_TS01-13