

Filename: H:\2607\_Project\Sunbeam\Drawings\CAD\Sheet\2607-KPF-BF04-05-DR-PLN-A-0106.dwg Plotted by: Ascioglu, Bekir Plot Time: 9/11/2019 4:25 PM

1

BF-RS&T  
LEVEL 05 FLOOR PLAN

SCALE: 1:200 @ A1

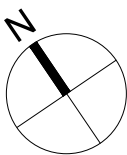
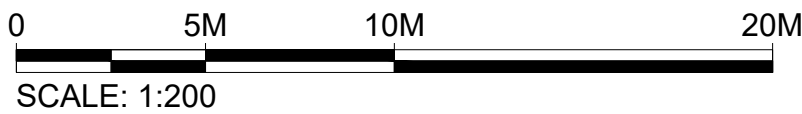

# KPF

**Client**

Southwark GP Nominee 1 Ltd. and  
Southwark GP Nominee 2 Ltd.

**Structural Engineer**

WSP  
Tel: 020 7337 1700

**MEP Engineer**

Hilson Moran  
Tel: 020 7940 8888

**Landscape Consultant (Strategy)**

Arup  
Tel: 020 7636 1531

**Landscape Consultant (Design)**

Andy Sturgeon  
Tel: 012 7367 2575

**Structural Engineer (Building F)**

AKT II  
Tel: 020 7250 7777

NOTE: THE DETAILED DESIGN OF THE RESIDENT'S COMMUNAL  
TERRACES ARE SHOWN FOR ILLUSTRATIVE PURPOSES ONLY

C	AMENDED PROPOSALS	16.09.19
B	ADDENDUM	04.06.18
A	ADDENDUM	19.01.18

No.	Issue	Check	Date
-----	-------	-------	------

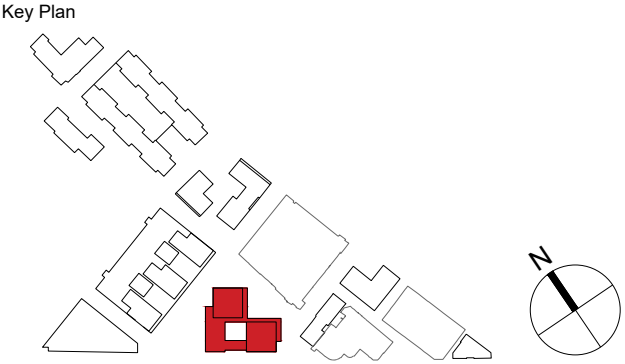

**Kohn Pedersen Fox Associates  
(International) PA**  
Architects and Planning Consultants

7a Langley Street  
London WC2H 9JA  
England  
T: +44 (0) 20 3119 5300  
F: +44 (0) 20 7497 1175  
<http://www.kpf.com>

Proj. No. Project  
**2607 Bermondsey Project**

Scale	Drawn by	Checked by
1:200 @ A1	YN	

Drawing Title and No.  
**BF-RS&T**  
**LEVEL 05 FLOOR PLAN**  
**PROPOSED**

Drawing Ref.	Rev.
2607-KPF-BF04-05-DR-PLN-	

**A-0106** **C**

© 2018 KOHN PEDERSEN FOX ASSOCIATES (INTERNATIONAL) PA. All rights reserved.  
Where drawing contains Ordnance Survey data © Crown Copyright. Licence no. 10001998.