

## Client

Southwark GP Nominee 1 Ltd. and  
Southwark GP Nominee 2 Ltd.

## Structural Engineer

WSP  
Tel: 020 7337 1700

## MEP Engineer

Hilson Moran  
Tel: 020 7940 8888

## Landscape Consultant (Strategy)

Arup  
Tel: 020 7636 1531

## Landscape Consultant (Design)

Andy Sturgeon  
Tel: 012 7367 2575

## Structural Engineer (Building F)

AKT II  
Tel: 020 7250 7777

NOTE: THE DETAILED DESIGN OF THE HARD AND SOFT  
LANDSCAPE IS SHOWN FOR ILLUSTRATIVE PURPOSES ONLY

B	AMENDED PROPOSALS	16.09.19
A	ADDENDUM	04.06.18
No.	Issue	Check Date

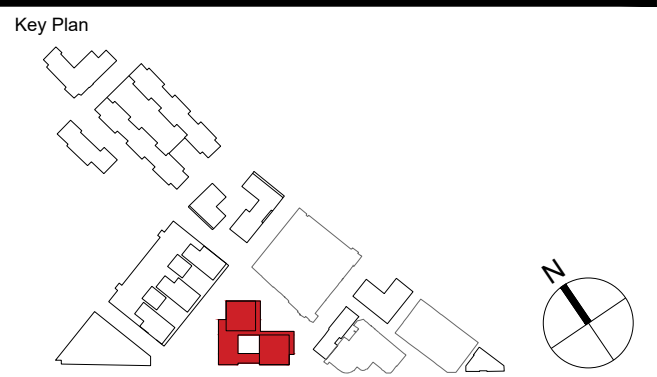

**Kohn Pedersen Fox Associates  
(International) PA**  
Architects and Planning Consultants

7a Langley Street  
London WC2H 9JA  
England  
T: +44 (0) 20 3119 5300  
F: +44 (0) 20 7497 1175  
<http://www.kpf.com>

Proj. No. **2607 Bermondsey Project**

Scale **1:200 @ A1** Drawn by **PS** Checked by

Drawing Title and No.  
**BF-RS&T**  
**GROUND FLOOR PLAN**  
**PROPOSED**

Drawing Ref.  
**2607-KPF-BF04-00-DR-PLN-**

**A-0100**

Rev.  
**B**



**BF-RS&T**  
**GROUND FLOOR PLAN**  
SCALE: 1:200 @ A1