

Client

Southwark GP Nominee 1 Ltd. and
Southwark GP Nominee 2 Ltd.

Structural Engineer

WSP
Tel: 020 7337 1700

MEP Engineer

Hilson Moran
Tel: 020 7940 8888

Landscape Consultant (Strategy)

Arup
Tel: 020 7636 1531

Landscape Consultant (Design)

Andy Sturgeon
Tel: 012 7367 2575

Structural Engineer (Building F)

AKT II
Tel: 020 7250 7777

NOTE: THE DETAILED DESIGN OF THE HARD AND SOFT
LANDSCAPE IS SHOWN FOR ILLUSTRATIVE PURPOSES ONLY

C	AMENDED PROPOSALS	16.09.19
B	ADDENDUM	04.06.18
A	ADDENDUM	19.01.18
No.	Issue	Check Date

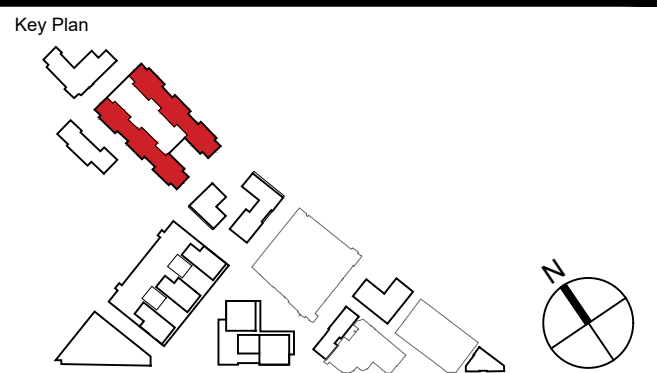

**Kohn Pedersen Fox Associates
(International) PA**
Architects and Planning Consultants

7a Langley Street
London WC2H 9JA
England
T: +44 (0) 20 3119 5300
F: +44 (0) 20 7497 1175
<http://www.kpf.com>

Proj. No. 2607 Project
Bermondsey Project

Scale 1:200 @ A1 Drawn by GG Checked by

Drawing Title and No.
BC-1234

GROUND FLOOR PLAN
PROPOSED

Drawing Ref. 2607-KPF-BC03-00-DR-PLN- Rev.

A-0100

C



**BC-1234
GROUND FLOOR PLAN**
SCALE: 1:200 @ A1