

4.0 A Day In The Life

4.6 Evening Economy

A new civic square could support the evening economy.

- Catenary lighting spans across the square creating a 'ceiling' at night.
- Welcoming after dark, allows people to sit and wait for friends when meeting at the station.
- A strong pedestrian link at night through Brixton. Improving the entrance to Brixton Village covered market

① Catenary Lighting



② Lighting to underside of the colonnade

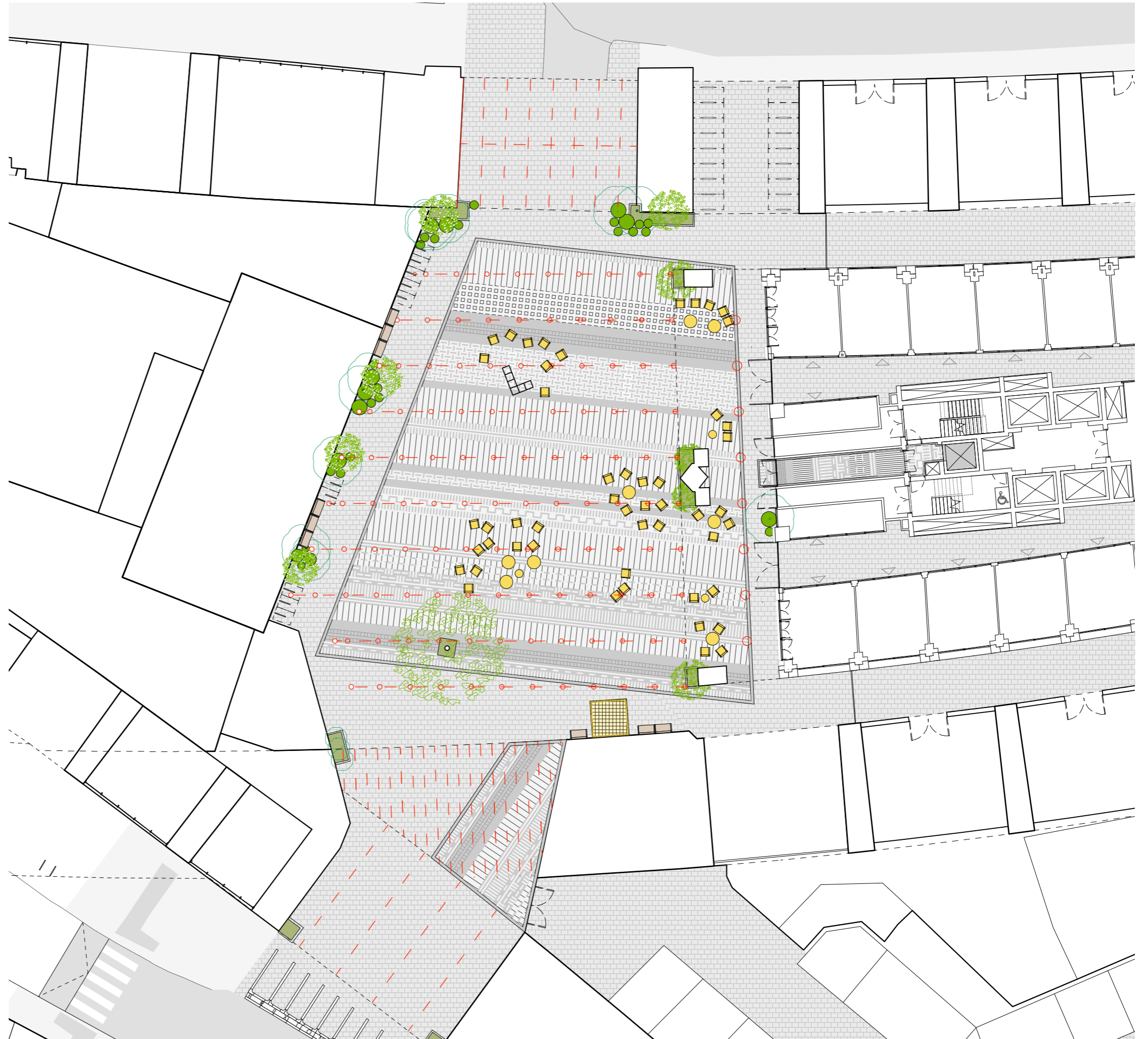

4.0 A Day In The Life 4.7 Of the Colonnade

The special pavement treatment continues under the colonnade, marking the civic square up-to the threshold of the new building.

An important part of the civic square, the colonnade provides a protected condition compared to the centre of the square:

- Shelter from the rain or bright sun
- A socially protected location to sit on the periphery of the action and watch the happenings in the centre of the square.
- A permeable threshold to the new building.

Right: route to the public WCS shown with arrow.
Below: colonnade with door painted to highlight route to the public WCS



4.0 A Day In The Life

4.8 In the Future

A new civic square at Pope's Road offers the chance to expand the public realm to create and connect pedestrian routes in the area.

In the future, as well as a possible new entrance to Brixton Station, it could be possible to open routes alongside the new building.



4.0 A Day In The Life

4.8 In the Future

Public realm improvements at Popes' Road will strengthen the pedestrian routes through the area.

The square has the potential to add greening, seating, lighting and cycle parking all of which are lacking in the area.



Pope's Road
Arts Strategy

5.0 Arts Strategy

5.1 Public Art

A Public Art Programme could deliver meaningful collaborative work in Pope's Road Square.

A programme of commissions of varying scale and duration, could provide opportunities for local participation, collaboration and learning, and will explore and develop what is local and particular. This could deliver a bold, innovative series of commissions, projects and partnerships.

The programme could take the form of a series of discreet commissions. Each with its own individual character and role, but should compliment and amplify qualities of the site and each of the other works.

The artworks need to make a positive contribution to the place and one, which will leave people with a rich and moving sense of Brixton

Objectives

- Engage with local communities through consultation and engagement
- Enhance the physical environment, making Pope's Road a more enjoyable place
- Build on the distinctive sense of place and identity
- Integrate the projects into neighbouring arts, culture and learning projects and institutions
- Strengthen local connections, grow positive relationships with across section of local communities
- Foster civic pride and confidence



Selection of public art in a range of mediums and styles

5.0 Arts Strategy

5.2 Enhancing Existing Art

As well as creating new artworks the site offers opportunities to enhance existing art and site features.



①



②



③



④

- ① Existing Michael Johns mural
- ② Opportunities for new murals
- ③ Opportunities for lighting installation to the under-side of the railway bridges
- ④ Opportunities to re-paint bridges

5.0 Arts Strategy

5.3 Test Project

The first commission in the arts programme could begin whilst the new building is under construction. As an opportunity for public engagement.

Working with a local artist, some of the principles proposed in the illustrative design could for example be tested to see if they meet with the communities requirements. However this is a starting suggestion and the intervention could take many forms.

Before instillation the existing condition could be measured and again afterwards, actively, during the trial. A feedback loop like this during the trial could test ideas and nimbly allow community activities.

Allied to public consultation events, all results of the trial would go into the formulation of final brief for space and detailed design.



GORT SCOTT