

LEGEND

- Outline Application Boundary
- Reserved Matters
- Application Boundary
- Masterplan Context Illustrative Only

Urban Greening Factor

- Extensive Green Roof (0.7)
- Flower Rich Perennial Planting (0.7)
- Trees Planted in Connected Tree Pits (0.8)
- Trees Planted in Standard Tree Pits (0.6)
- Vegetation Over Structure (0.8)
- Vegetation Over Structure (Hidden) (0.8)

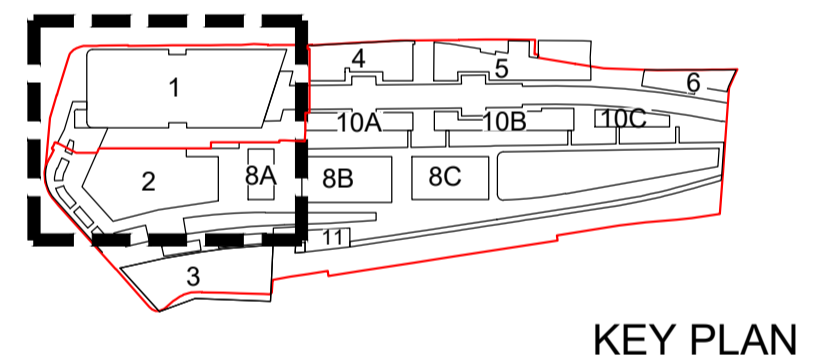

Notes:
 -All drawings to be printed in colour
 -All dimensions in millimeters
 -Do not scale from drawings
 -For general arrangements refer to 94250 series drawings
 -For sections refer to 94550 series drawings
 -For feature structures and stairs refer to 94950 series drawings

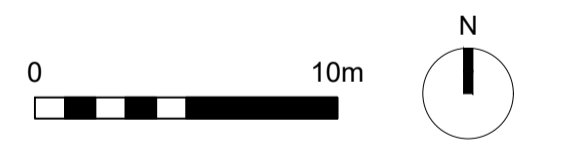

Rev	Date	Description	By	Chk
xx	xx/xx/xx	xxx	xxx	xxx

SPACEHUB

7 Gibraltar Walk, London, E2 7LH
 +44 (0)20 7739 6699
 www.spacehubdesign.com

Do not scale from this drawing, copyright reserved

Project
 The Goodsyard
 Client
 Bishopsgate Goodsyard Regeneration Ltd
 Drawing title
 GENERAL ARRANGEMENTS
 Urban Greening Factor

 Drawing status
 Reserved Matters Application
 Date
 07/09/2023
 Drawing number
 BGY-SPA-SW-ZZ-DR-L-94272

Drawn by
 Checked by
 SB
 GC
 Scale
 1:250 @ A1

PLOT 1 RMA					PLOT 1 RMA - W/O Overground	
Surface Cover Type	Factor	Area (m ²)	Contribution	Notes		
Semi-natural vegetation (e.g. trees, woodland, species-rich grassland) maintained or established on site.	1		0			
Wetland or open water (semi-natural; not chlorinated) maintained or established on site.	1		0			
Intensive green roof or vegetation over structure. Substrate minimum settled depth of 150mm.	0.8	370	296			
Standard trees planted in connected tree pits with a minimum soil volume equivalent to at least two thirds of the projected canopy area of the mature tree.	0.8	236	188.8			
Extensive green roof with substrate of minimum settled depth of 80mm (or 60mm beneath vegetation blanket) – meets the requirements of GRO Code 2014.	0.7	1730	1211			
Flower-rich perennial planting.	0.7	23	16.1			
Rain gardens and other vegetated sustainable drainage elements.	0.7		0			
Hedges (line of mature shrubs one or two shrubs wide).	0.6		0			
Standard trees planted in pits with soil volumes less than two thirds of the projected canopy area of the mature tree.	0.6	98	58.8			
Green wall –modular system or climbers rooted in soil.	0.6		0			
Groundcover planting.	0.5		0			
Amenity grassland (species-poor, regularly mown lawn).	0.4		0			
Extensive green roof of sedum mat or other lightweight systems that do not meet GRO Code 2014.	0.3		0			
Water features (chlorinated) or unplanted detention basins.	0.2		0			
Permeable paving.	0.1		0			
Sealed surfaces (e.g. concrete, asphalt, waterproofing, stone).	0		0			
Total contribution			1770.7		Total contribution	1770.7
Total site area (m²)			8503		Total site area (m²)	7805
Urban Greening Factor			0.21		Urban Greening Factor	0.23