

- A. ENTRANCE LEVEL DOOR 850mm CLEAR OPENING WIDTH WITH CIRCULATION ROUTE TO DOOR 1500mm
- B. INTERNAL CIRCULATION DOORS IN UNITS MIN CLEAR WIDTH 850mm WITH 300mm NIBS
- C. BATH 1700mm X 700mm (WITH 1000mm X 1000mm ACTIVITY SPACE FOR FURNITURE SHOWER PROVISION) & 400mm END TRANSFER SPACE
- D. 1500mm X 1500mm TURNING CIRCLE IN MAIN BATH ROOM
- E. SLIDING DOOR TO BALCONY 800mm MIN CLEAR OPENING WIDTH
- F. 1700mm x 2300mm TRANSFER SPACE
- G. 1800mm x 1500mm MANEUVERING SPACE
- H. 1200mm x 1200mm ACTIVITY SQUARES IN BEDROOMS
- I. 1000mm TRANSFER SPACE TO SIDES AND FOOT OF BED
- J. 1500mm x 1500mm ACTIVITY SPACE IN KITCHEN

REV	DATE	DESCRIPTION
A	07.07.16	Scheme 7
P1	15.03.19	Planning issued for information

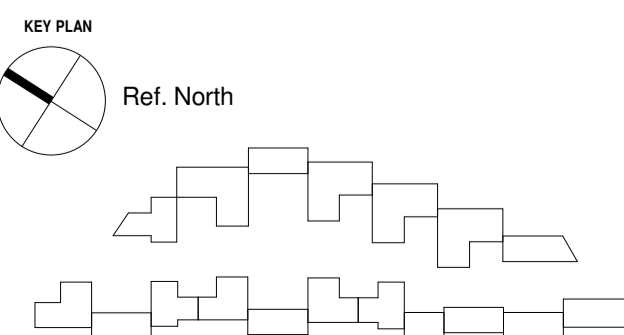

**NOTES**  
 Check and verify all dimensions prior to commencement of work.  
 This drawing shall be read in conjunction with all other contract documents including those by other consultants, and including specifications.  
 Seek clarification of inconsistencies/ conflicts.  
 Figured dimensions shall take precedence to scaled dimensions.

DRAWN	CHECKED	JOB NO.
Author	Checker	44032

This drawing is COPYRIGHT and shall remain the property of  
**ARNEY FENDER KATSAIDIS**

**CLIENT**  
 Meadow Residential

**PROJECT**  
 Mill Hill - London

**ARCHITECTS:**  
 ARNEY FENDER KATSAIDIS  
 44-46 SCRUTTON STREET, LEVEL 1  
 LONDON, EC2A 4HN, UNITED KINGDOM

**DRAWING TITLE**  
 TYPICAL 1 BEDROOM APARTMENT\_B.02

**STRUCTURAL ENGINEER:**  
 JES  
 4 PEAR TREE COURT, LONDON,  
 EC1P 3DS

**MECHANICAL / ELECTRICAL ENGINEER:**  
 CHEAPMAN EDGE  
 SAFFRON HOUSE, 6-10 KIRBY STREET,  
 LONDON, EC1N 8TS.

**LANDSCAPE ARCHITECT:**  
 OUBERSIDGE  
 THE BOATHOUSE, 27 FERRY  
 ROAD, TEDDINGTON, TW11 9NN

**Arney Fender Katsalidis**

**SCALE**  
 1 : 25@ A1

**REVISION / DRAWING No.**  
 P1 | PLANNING

A50-00-05